

REVISED JULY 17, 1959

NOTE: Existing Hermitage Rd is a dirt road in poor condition, rutted and many holes.

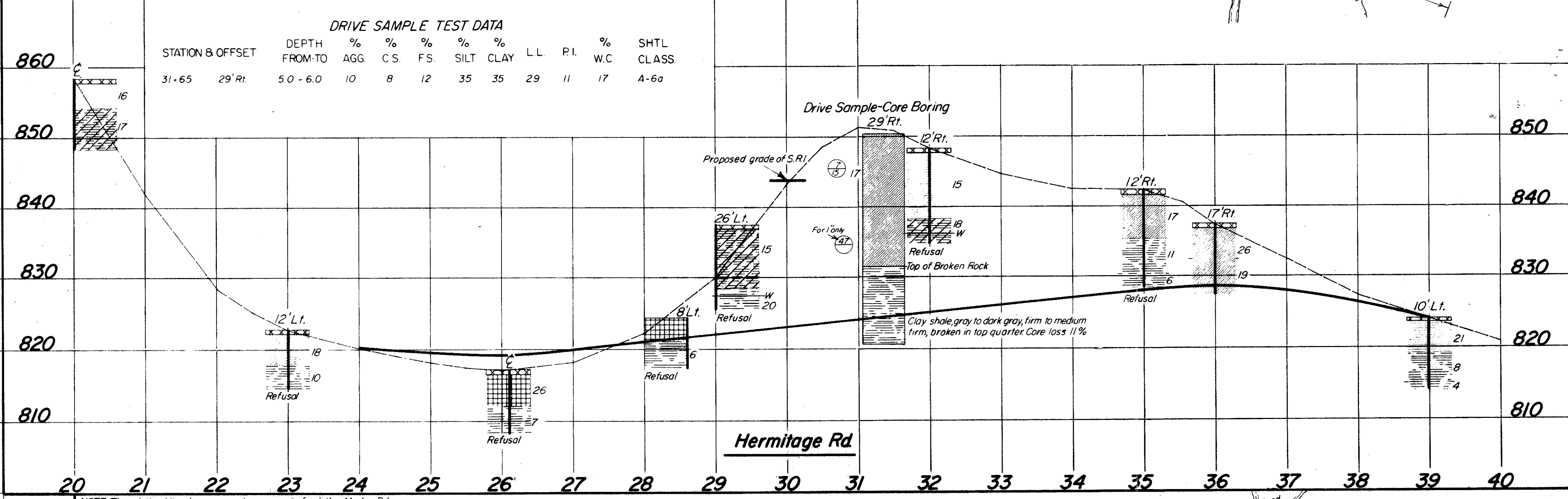

NOTE: The existing bituminous concrete pavement of existing Morley Rd is in good condition, longitudinal cracking and minor rutting.

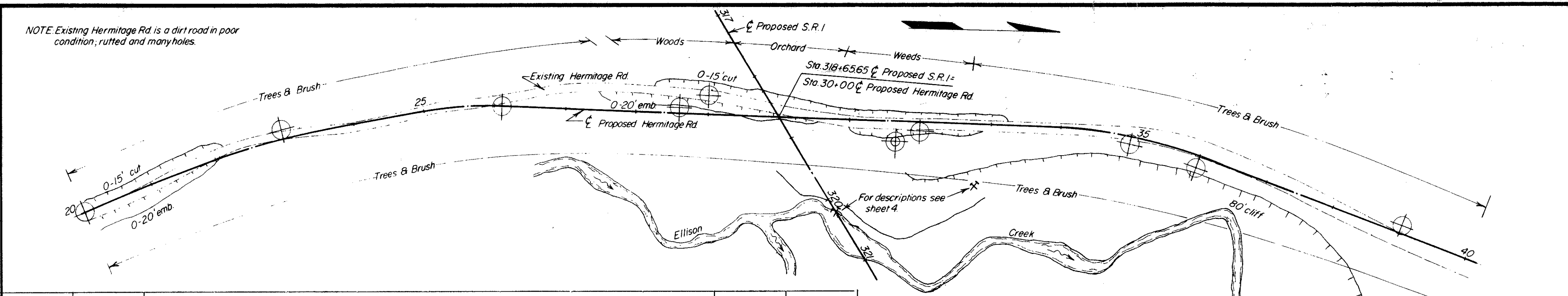
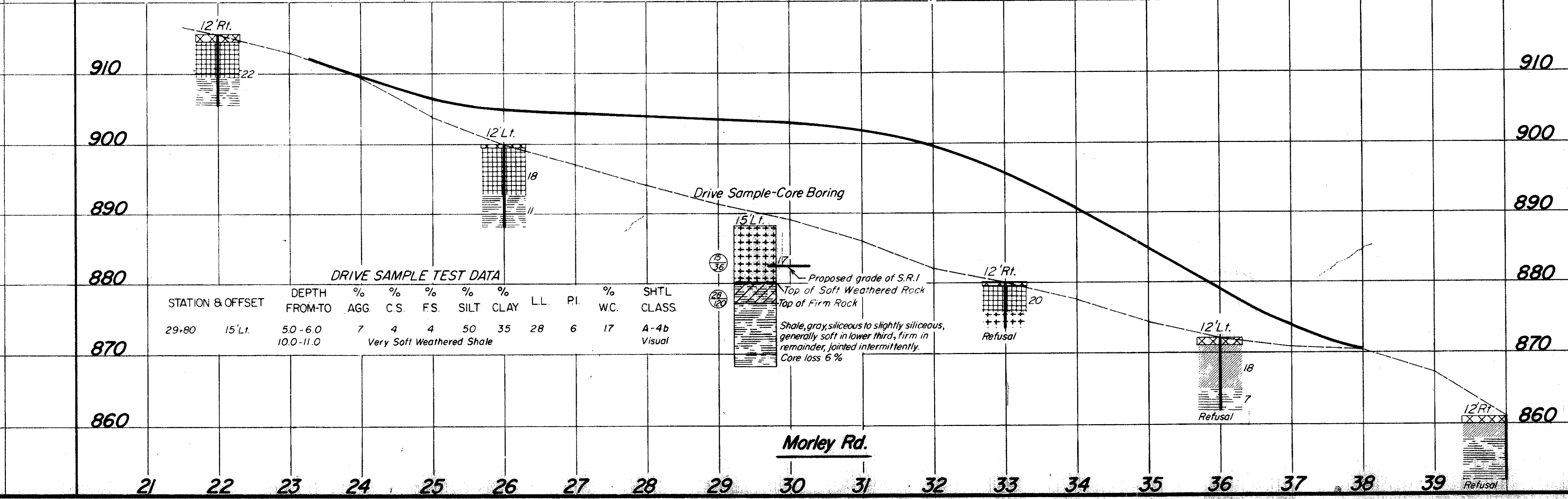
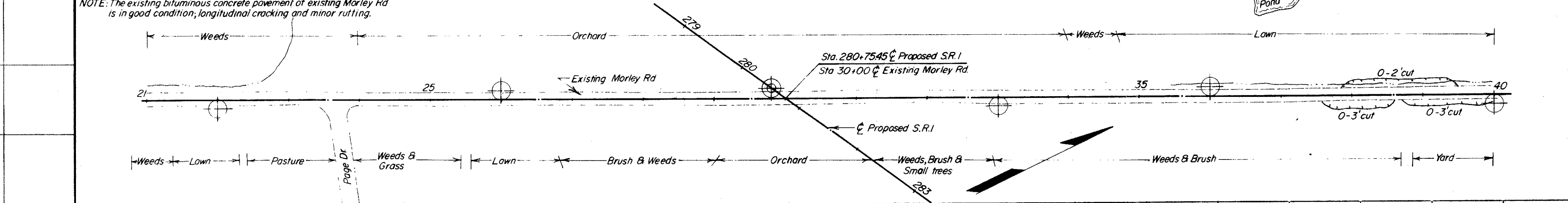

Soil Profile 7, 8, 9, 10  
 R. J. Brown  
 10/14/59