

MICROFILMED
JUN 27 1965

FED. RD. DIVISION	STATE	PROJECT
2	OHIO	

290
306

LAKE COUNTY
SEC. LAK-1-10.38

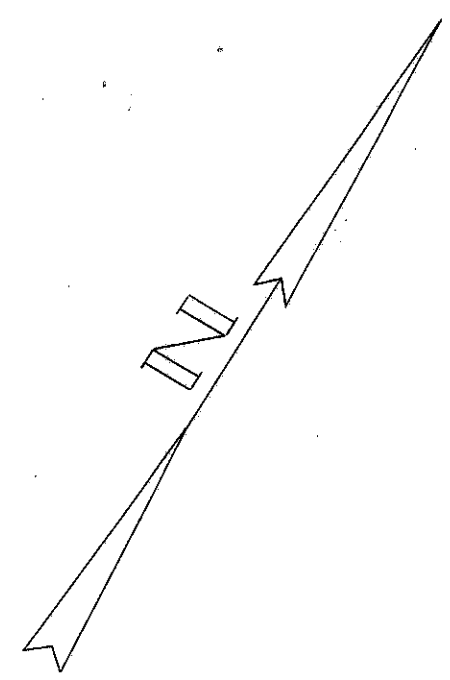
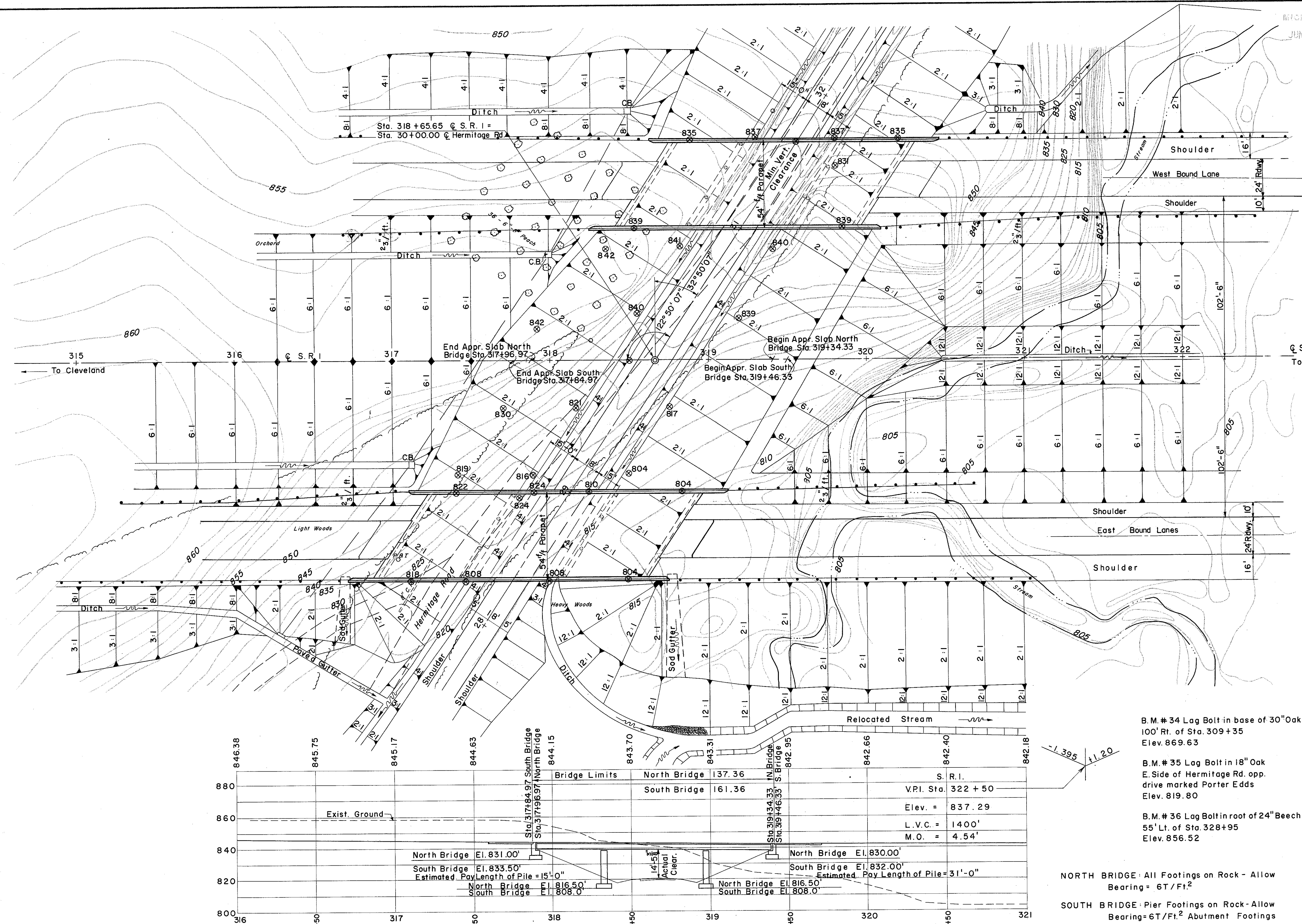

← S.R.I. (Survey)
To Cleveland

S.R.I. (Survey)
To Ashtabula →

FOUNDATION SOUNDINGS: Foundation design and foundation quantities are based on a study of rod soundings and soil sampling soundings made at the site. This sounding information may be inspected in the office of the Bureau of Bridges in Columbus, or in the Division Office, but the state does not guarantee the accuracy thereof.

⊕ Borings or Rod Soundings with Elev. of Top of Rock.

PROPOSED STRUCTURES	
TYPE:	Two 3-Span Continuous Rolled Beam with Reinforced Concrete Deck & Substructure.
SPANS:	North Bridge-36'-0", 60'-0", 36'-0" South Bridge-48'-0", 60'-0", 48'-0"
ROADWAY:	54'-0" f/f Parapet, 1'-2" Safety Curb
LOAD FREQUENCY:	CF=2000- Adequate for AASHO Alternate Loading
SKEW:	32° 50' 07" L.F.
WEARING SURFACE:	1" Monolithic Concrete
APPR. SLABS:	25' Long AS-1-54
ALIGNMENT:	Tangent- Both Roads
TRAFFIC COUNT:	80 (1955) 160 ADT 1975 (Hermitage Road)

- B.M. # 34 Lag Bolt in base of 30" Oak 100' Rt. of Sta. 309+35 Elev. 869.63
- B.M. # 35 Lag Bolt in 18" Oak E. Side of Hermitage Rd. opp. drive marked Porter Edds Elev. 819.80
- B.M. # 36 Lag Bolt in root of 24" Beech 55' Lt. of Sta. 328+95 Elev. 856.52

Elevation	Station	Notes
846.38	316	Exist. Ground
845.75	150	Exist. Ground
845.17	317	Exist. Ground
844.63	450	Exist. Ground
843.70	318	Exist. Ground
843.31	450	Exist. Ground
842.95	319	Exist. Ground
842.66	450	Exist. Ground
842.40	320	Exist. Ground
842.18	450	Exist. Ground

Structure	Span	North Bridge El.	South Bridge El.	Notes
North Bridge	36'-0"	831.00'	833.50'	Estimated Pile Length = 15'-0"
South Bridge	48'-0"	816.50'	808.0'	Estimated Pile Length = 31'-0"
North Bridge	60'-0"	830.00'	832.00'	Estimated Pile Length = 31'-0"
South Bridge	60'-0"	816.50'	808.0'	Estimated Pile Length = 31'-0"

-1.395 +1.20

NORTH BRIDGE: All Footings on Rock - Allow Bearing = 6T/Ft.²

SOUTH BRIDGE: Pier Footings on Rock - Allow Bearing = 6T/Ft.² Abutment Footings on Steel H Piles Point bearing on rock. 12 BP 53. Design Load 25 Tons/Pile.

SEC. C-31A						
PREPARED BY CAPITOL ENGINEERING ASSOCIATES, DILLSBURG, PA. FOR						
STATE OF OHIO DEPARTMENT OF HIGHWAYS DIVISION OF DESIGN AND CONSTRUCTION BUREAU OF BRIDGES						
SITE PLAN BRIDGE NO. LAK-1-1271 N.F.S. S.R.I. OVER HERMITAGE ROAD LAKE COUNTY STA. 318 + 65.65						
DESIGNED	DRAWN	TRACED	CHECKED	REVISED	DATE	REVISED