

MICROFILMED  
JUN 27 1963

FED. RD. DIVISION	STATE	PROJECT
2	OHIO	

282  
306

LAKE COUNTY  
SEC. LAK-1-10.38

B.M. #30 Lag bolt 2' from ground  
south side of 12" Ash  
254' ± Rt. of C. Sta. 274 + 50  
Elev. 906.62

B.M. #32 Lag bolt 6" from ground on  
6" Elm 150' Rt. of C. Sta. 289 + 60  
Elev. 884.57

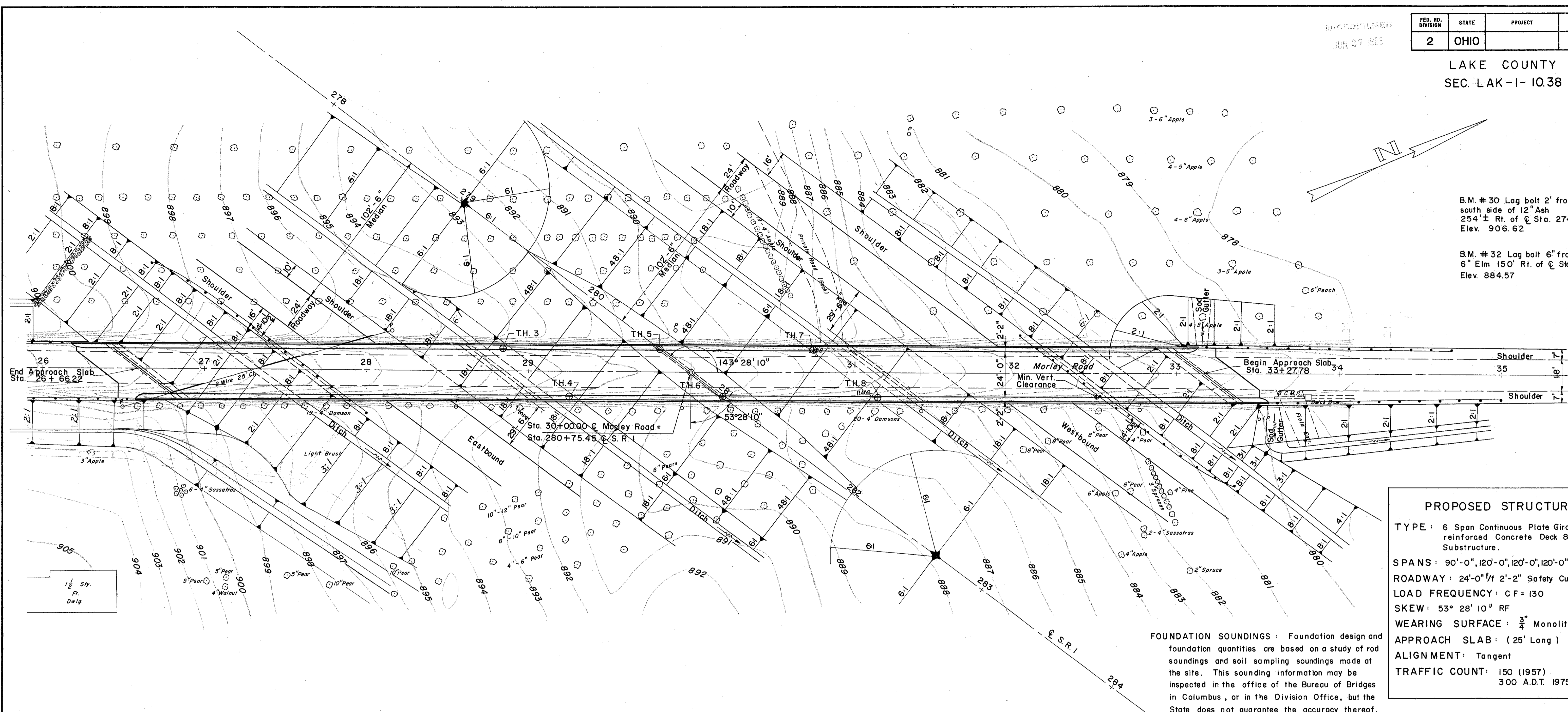

**PROPOSED STRUCTURE**

TYPE : 6 Span Continuous Plate Girder with reinforced Concrete Deck & Substructure.

SPANS : 90'-0", 120'-0", 120'-0", 120'-0", 120'-0", 84'-0"

ROADWAY : 24'-0" w/ 2'-2" Safety Curb

LOAD FREQUENCY : C F = 130

SKEW : 53° 28' 10" RF

WEARING SURFACE :  $\frac{3}{4}$ " Monolithic

APPROACH SLAB : (25' Long)

ALIGNMENT : Tangent

TRAFFIC COUNT : 150 (1957)  
300 A.D.T. 1975

FOUNDATION SOUNDINGS : Foundation design and foundation quantities are based on a study of rod soundings and soil sampling soundings made at the site. This sounding information may be inspected in the office of the Bureau of Bridges in Columbus, or in the Division Office, but the State does not guarantee the accuracy thereof.

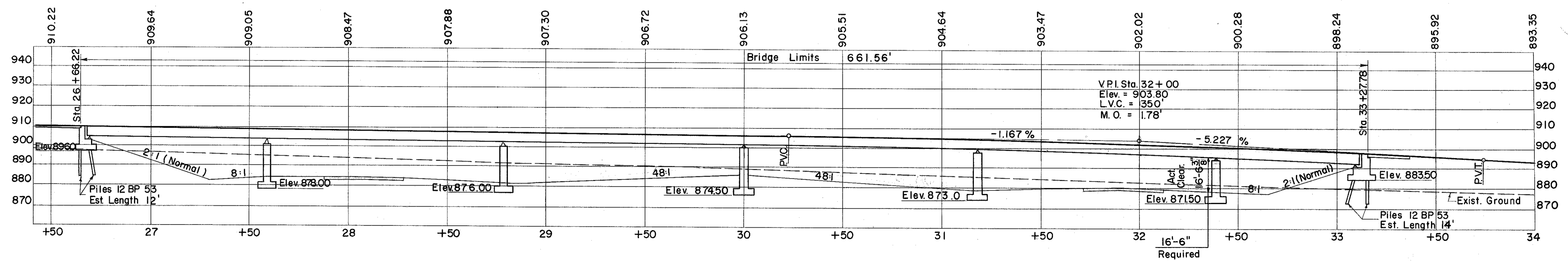

SEC. C-31A

PREPARED BY  
CAPITOL ENGINEERING ASSOCIATES, DILLSBURG, PA.  
FOR

STATE OF OHIO  
DEPARTMENT OF HIGHWAYS  
DIVISION OF DESIGN AND CONSTRUCTION  
BUREAU OF BRIDGES

**SITE PLAN**  
BRIDGE NO. LAK-1-1199  
S.R.I. UNDER MORLEY ROAD  
LAKE COUNTY  
STA. 280+75.45

DESIGNED	DRAWN	TRACED	CHECKED	REVISED DATE	REVISED
					3-1-60