

MICROFILMED
JUN 27 1965

FED. RD. DIVISION	STATE	PROJECT
2	OHIO	

274
306

LAKE COUNTY
SEC. LAK-1-1038

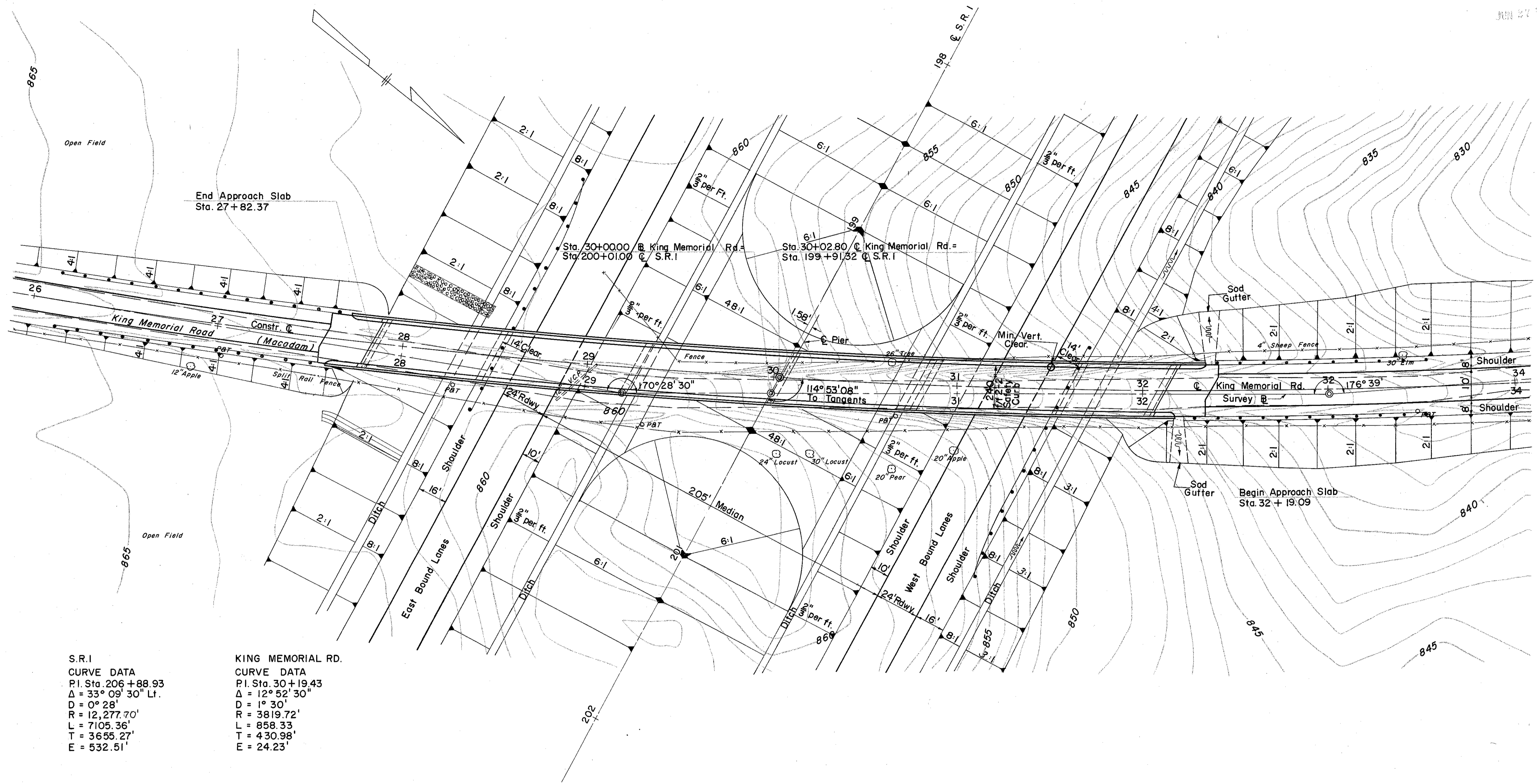

S.R.1 CURVE DATA P.I. Sta. 206+88.93 Δ = 33° 09' 30" Lt. D = 0° 28' R = 12,277.70' L = 7105.36' T = 3655.27' E = 532.51'	KING MEMORIAL RD. CURVE DATA P.I. Sta. 30+19.43 Δ = 12° 52' 30" D = 1° 30' R = 3819.72' L = 858.33' T = 430.98' E = 24.23'
--	--

FOUNDATION SOUNDINGS:
Foundation design and foundation quantities are based on a study of rod soundings and soil sampling soundings made at the site. This sounding information may be inspected in the Bureau of Bridges in Columbus or in the Division Office, but the State does not guarantee the accuracy thereof.

PROPOSED STRUCTURE

- TYPE: 6-Span Continuous Rolled Beam with reinforced Concrete Deck & Substructure.
- SPANS: 62'-9", 78'-6", 78'-6", 78'-6", 78'-6", 55'-0".
- ROADWAY: 24'-0" f/w 2'-2" Safety Curb.
- LOAD FREQUENCY: CF = 130
- SKEW: 24° 53' 08" Lt.
- WEARING SURFACE: 3/4" Monolithic.
- APPROACH SLABS: 25' Long.
- ALIGNMENT: 1° 30' Curve Left
- SUPERELEVATION: 0.025'/ft.
- TRAFFIC COUNT: 230 (1955), 460 A.D.T. 1975

- B.M. #22 Lag Bolt in Roof of 18" Triple Poplar 168' ± Left of C Sta. 194+10 Elev. 843.14'
- B.M. #23 Lag Bolt in North Root 14" Twin Maple 250' ± Right of C Sta. 204+37 Elev. 869.06'

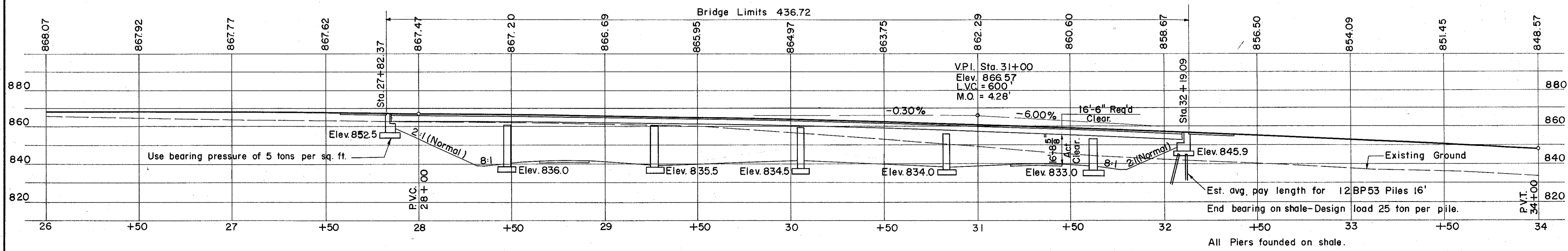

SEC. C-31A

PREPARED BY
CAPITOL ENGINEERING ASSOCIATES, DILLSBURG, PA.
FOR

STATE OF OHIO
DEPARTMENT OF HIGHWAYS
DIVISION OF DESIGN AND CONSTRUCTION
BUREAU OF BRIDGES

SITE PLAN
BRIDGE NO. LAK-1-1050
S.R.1 UNDER KING MEMORIAL ROAD
LAKE COUNTY
STA. 199+91.32

DESIGNED	DRAWN	TRACED	CHECKED	REVISED	DATE	REVISED
		J.P.S.				3-1-60
		6-18-59				