

CURVE DATA
P.I. Sta. 206+88.93
Δ = 33°09'33" Lt.
D = 0°28'00"
R = 12,277.66
L = 7105.36
T = 3655.27
E = 532.51'

All trees within the Roadside Rest Areas, except those marked by the Engineer for removal, shall be pruned in accordance with the provisions of Item L-17. In lieu of the provisions of Sec. L-17.07 and L-17.08, All work necessary to complete this Item shall be paid for at the contract lump sum price bid for Item L-17 Pruning Existing Trees.

The number of trees to be pruned has been estimated at 75. This estimate is approximate. Payment for the pruning of any additional trees within the park area shall be included in the lump sum price bid for Item L-17 Pruning Existing Trees.

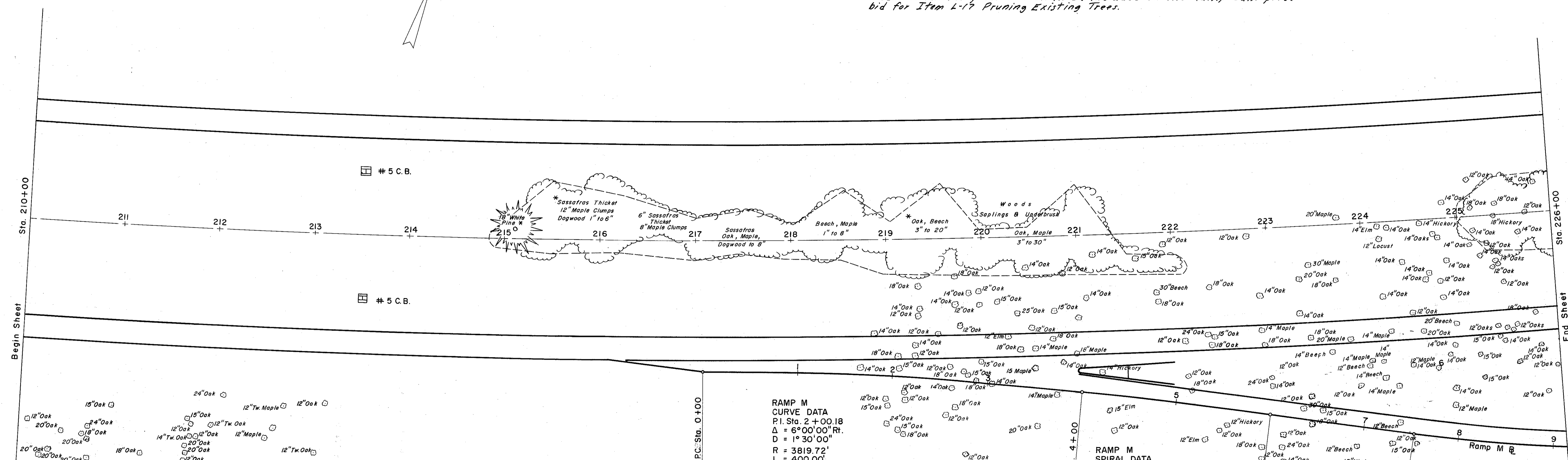
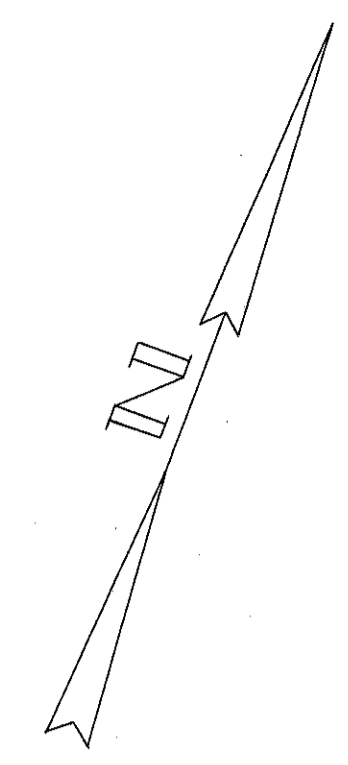

ROADSIDE REST GENERAL NOTES

ITEM SPECIAL - WELL SHELTER:
METHOD OF MEASUREMENT
THE WELL SHELTER AND ALL APPURTENANCES AS DETAILED ON SHEET NO. 257-B SHALL BE CONSIDERED AS ONE UNIT. THE NUMBER OF UNITS TO BE PAID FOR SHALL BE THE NUMBER OF EACH UNIT, LISTED AND ESTIMATED SEPARATELY, COMPLETE AND ACCEPTED.
BASIS OF PAYMENT
THE WORK INCLUDED IN THIS ITEM SHALL BE PAID FOR AT THE CONTRACT UNIT PRICE BID FOR EACH "ITEM SPECIAL WELL SHELTER" COMPLETED AND ACCEPTED, WHICH PRICE AND PAYMENT SHALL CONSTITUTE FULL COMPENSATION FOR ALL EXCAVATION AND BACKFILL, AND FOR FURNISHING, HAULING AND PLACING ALL MATERIALS, AND FOR ALL LABOR, EQUIPMENT, TOOLS, AND INCIDENTALS NECESSARY TO COMPLETE THIS ITEM.

ITEM SPECIAL - PARK TABLE:
METHOD OF MEASUREMENT
THE PARK TABLE AND SUPPORTING SLAB AS DETAILED ON STD. DRWG. R.R.A. NO. 2 SHALL BE CONSIDERED ONE UNIT. THE NUMBER OF UNITS TO BE PAID FOR SHALL BE THE NUMBER OF EACH UNIT, LISTED AND ESTIMATED SEPARATELY, COMPLETE AND ACCEPTED.
BASIS OF PAYMENT
THE WORK INCLUDED IN THIS ITEM SHALL BE PAID FOR AT THE CONTRACT PRICE BID FOR EACH "ITEM SPECIAL PARK TABLE" COMPLETED AND ACCEPTED, WHICH PRICE AND PAYMENT SHALL CONSTITUTE FULL COMPENSATION FOR ALL EXCAVATION AND BACKFILL, AND FOR FURNISHING, HAULING AND PLACING ALL MATERIALS, AND FOR ALL LABOR, EQUIPMENT, TOOLS, AND INCIDENTALS NECESSARY TO COMPLETE THIS ITEM.

ITEM SPECIAL - BULLETIN BOARD:
METHOD OF MEASUREMENT
THE BULLETIN BOARD WITH ALL APPURTENANCES AS DETAILED ON STD. DRWG. R.R.A. NO. 3 SHALL BE CONSIDERED ONE UNIT. THE NUMBER OF UNITS TO BE PAID FOR SHALL BE THE NUMBER OF EACH UNIT, LISTED AND ESTIMATED SEPARATELY, COMPLETE AND ACCEPTED.
BASIS OF PAYMENT
THE WORK INCLUDED IN THIS ITEM SHALL BE PAID FOR AT THE CONTRACT UNIT PRICE BID FOR EACH "ITEM SPECIAL BULLETIN BOARD" COMPLETED AND ACCEPTED, WHICH PRICE AND PAYMENT SHALL CONSTITUTE FULL COMPENSATION FOR ALL EXCAVATION AND BACKFILL, AND FOR FURNISHING, HAULING AND PLACING ALL MATERIALS, AND FOR ALL LABOR, EQUIPMENT, TOOLS, AND INCIDENTALS NECESSARY TO COMPLETE THIS ITEM.

ITEM SPECIAL - PRIVY AND STORAGE SHED:
METHOD OF MEASUREMENT
THE PRIVY AND STORAGE SHED WITH ALL APPURTENANCES AS DETAILED ON STD. DRWG. R.R.A. NO. 4A, 4B, 4C SHALL BE CONSIDERED ONE UNIT. THE NUMBER OF UNITS TO BE PAID FOR SHALL BE THE NUMBER OF EACH UNIT, LISTED AND ESTIMATED SEPARATELY, COMPLETE AND ACCEPTED. CONCRETE WALKS ARE NOT A PART OF THIS ITEM.
BASIS OF PAYMENT
THE WORK INCLUDED IN THIS ITEM SHALL BE PAID FOR AT THE CONTRACT PRICE BID FOR EACH "ITEM SPECIAL PRIVY AND STORAGE SHED" COMPLETED AND ACCEPTED, WHICH PRICE AND PAYMENT SHALL CONSTITUTE FULL COMPENSATION FOR ALL EXCAVATION AND BACKFILL, AND FOR FURNISHING, HAULING AND PLACING ALL MATERIALS, AND FOR ALL LABOR, EQUIPMENT, TOOLS, AND INCIDENTALS NECESSARY TO COMPLETE THIS ITEM.

NOTE:
THE "TOILET RISER WITHOUT SEAT" SPECIFIED ON STD. DRWG. NO. R.R.A. NO. 4-C SHALL BE AS MANUFACTURED BY MANSFIELD SANITARY POTTERY INC., PERRYSVILLE, OHIO, OR AN APPROVED EQUAL.

RAMP M CURVE DATA
P.I. Sta. 2+00.18
Δ = 6°00'00" Rt.
D = 1°30'00"
R = 3819.72'
L = 400.00'
T = 200.18'

RAMP M SPIRAL DATA
P.I. Sta. 4+66.67
S_s = 1°30'00"
S.T. = 66.67'
L.T. = 133.34'
L_s = 200.00'

RAMP M CURVE DATA
P.I. Sta. 9+58.53
Δ = 14°14'33.67" Lt.
D = 3°30'00"
R = 1637.02'
L = 406.93'
T = 204.52'

SEEDING AND PROTECTING:
SEEDING SHALL CONFORM TO ITEM L-9 OF THE SPECIFICATIONS, EXCEPT THAT THE SEED BED SHALL BE PREPARED TO A MINIMUM DEPTH OF TWO INCHES AND PROVIDE A SMOOTH SURFACE, FREE OF LOW AREAS WHERE WATER MAY POOL. ALL STONES LARGER THAN ONE INCH IN DIAMETER SHALL BE REMOVED FROM THE SURFACE OF THE SEED BED. HAND RAKING WILL BE REQUIRED IN LAWN AREAS INACCESSIBLE TO MACHINES; AND HAND RAKING MAY BE REQUIRED, IF DIRECTED BY THE ENGINEER, IN ALL LAWN AREAS, IF MACHINES USED DO NOT PROVIDE RESULTS EQUIVALENT TO RESULTS OBTAINED BY HAND RAKING. COST OF THIS ADDITIONAL WORK SHALL BE INCLUDED IN THE UNIT PRICES BID FOR ROADWAY EXCAVATION, ITEM E-1.

SEED MIXTURE SHALL BE AS FOLLOWS
20% POA PRATENSIS (KENTUCKY BLUE GRASS)
40% FESTUCA RUBRA VAR. (ILLAHEE FESCUE)
40% FESTUCA ELEATOR VAR. (KENTUCKY 31 FESCUE)

PARK AREAS, OTHER THAN THE PARKING LOT, SHALL NOT BE USED FOR STORAGE OF MATERIALS, PARKING OF EQUIPMENT, VEHICLES OR FOR THE LOCATION OF BUILDINGS OF ANY KIND DURING CONSTRUCTION BY THE CONTRACTOR.

L-17 PRUNING EXISTING TREES
IN ADDITION TO THE WORK SPECIFIED, LOW LIMBS SHALL BE REMOVED TO OBTAIN 8 FOOT CLEARANCE ABOVE THE GROUND AS DIRECTED.

ITEM SPECIAL - DRILLED WELLS: (SEE NOTES IN PROPOSAL)
ITEM L-12 - In lieu of mulching as required by Sec. L-12.23, vine planting areas shall be seeded and mulched in accordance with Item L-9 Seeding and Protecting within 48 hours after the vines are planted.

TOPSOIL FOR L-ITEMS
THIS SHALL BE OBTAINED FROM STOCKPILES PROVIDED FOR BY E-1.03 (a). IT SHALL BE USED FOR PREPARATION OF THE FINISH GRADE FOR SEEDING IN THE REST AREAS IN ADDITION TO SHOULDERS SLOPES AND DITCHES PROVIDED FOR BY E-1.05 (d). IT SHALL BE USED AS DIRECTED TO FILL ALL DEPRESSIONS TO OBTAIN EXTRA SMOOTH FINE GRADING AND TO PROVIDE A MINIMUM DEPTH OF 4 INCHES OF TOPSOIL FOR THE REST AREA LAWNS.

ITEM E-9 REMOVAL OF TREES AND STUMPS:
WHERE TREES ARE TO BE REMOVED WITHIN TEN FEET OF TREES THAT ARE TO REMAIN, THE STUMPS SHALL NOT BE GRUBBED AS PER E-1.03 DUE TO DAMAGING ROOTS OF REMAINING TREES. THE STUMPS SHALL BE CUT TO A MINIMUM DEPTH OF EIGHT INCHES BELOW FINISH GRADE WITH A STUMP CHIPPER OR SIMILAR EQUIPMENT. IN ORDER TO PREVENT DAMAGE TO TREE ROOTS, NO CLEAT TRACK EQUIPMENT SHALL BE OPERATED WITHIN TEN FEET OF TREES AND NO EQUIPMENT SHALL BE ALLOWED TO DISTURB THE SOIL SURFACE IN THE VICINITY OF TREES DEEPER THAN SIX INCHES. NO SOIL SHALL BE STOCKPILED OR WASTED BENEATH TREES DURING CONSTRUCTION.

THE CONTRACTOR SHALL BE RESPONSIBLE FOR THE REPLACEMENT OF ANY TREES DAMAGED BY VIOLATION OF THE ABOVE NOTE WITH EQUIVALENT DIAMETER TREES OR ENOUGH TREES OF FIVE INCH TO SEVEN INCH DIAMETER TO EQUAL THE DIAMETER OF TREES DAMAGED. THE VARIETY AND NUMBER OF TREES TO BE REPLACED SHALL BE DETERMINED BY THE ENGINEER.