

LAKE COUNTY
LAK-1-1038

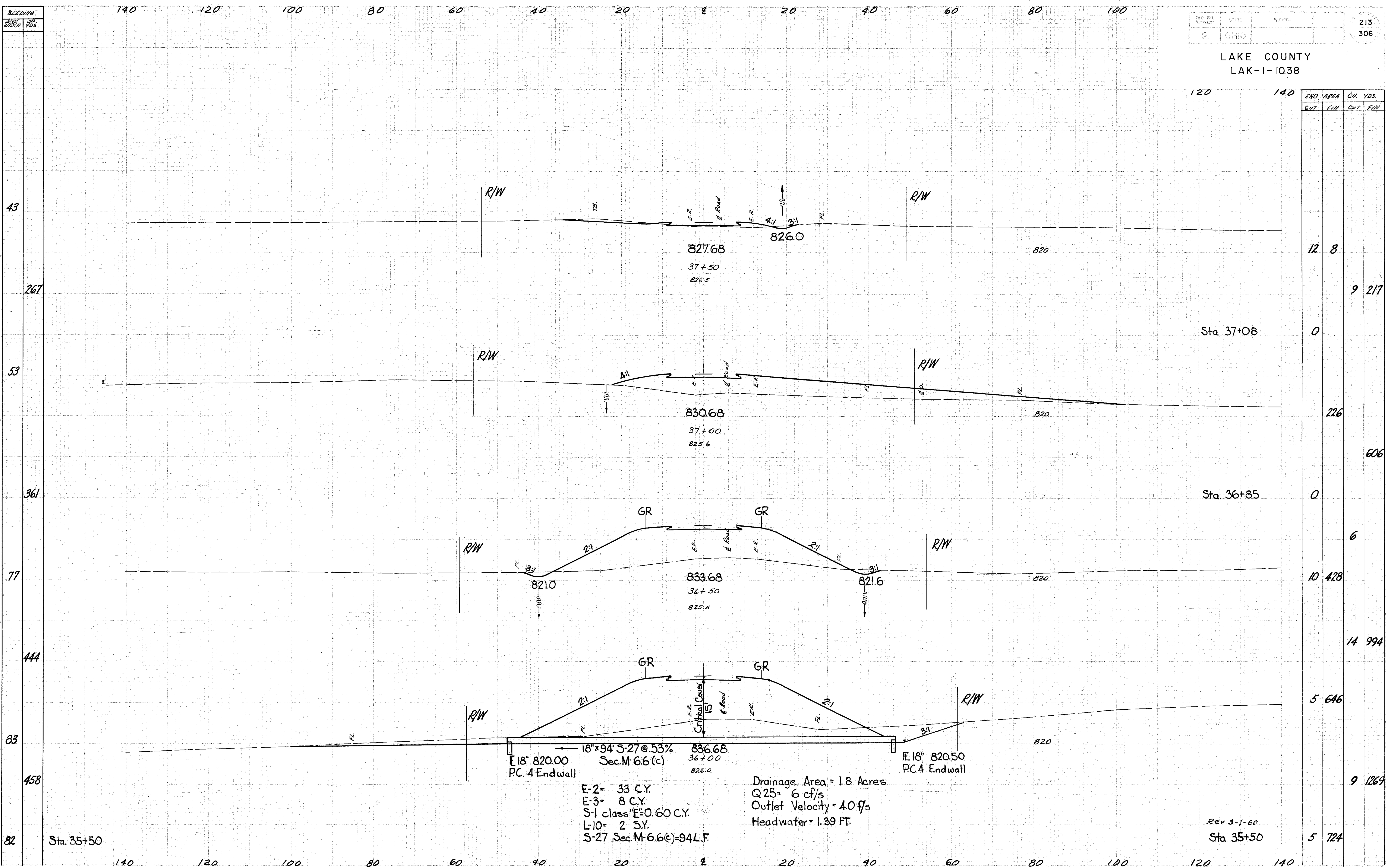

| STA. | END AREA | | CU. YDS. | |
|------|----------|------|----------|--------|
| | CUT | FILL | CUT | FILL |
| 43 | | | 12 | 8 |
| 267 | | | | 9 217 |
| 53 | | | 0 | |
| 361 | | | 226 | |
| 77 | | | | 606 |
| 444 | | | 0 | |
| 83 | | | 10 | 428 |
| 458 | | | | 6 |
| 82 | | | 5 | 646 |
| | | | | 14 994 |
| | | | 5 | 646 |
| | | | | 9 1269 |
| | | | 5 | 724 |

Drainage Area = 1.8 Acres
 Q₂₅ = 6 cfs
 Outlet Velocity = 4.0 f/s
 Headwater = 1.39 FT.

E-2 = 33 C.Y.
 E-3 = 8 C.Y.
 S-1 class "E" = 0.60 C.Y.
 L-10 = 2 S.Y.
 S-27 Sec. M-6.6(c) = 94 L.F.

Rev. 3-1-60
 Sta 35+50