

SEEDING  
END WIDTH YDS.

183  
306

LAKE COUNTY  
LAK-1-10.38

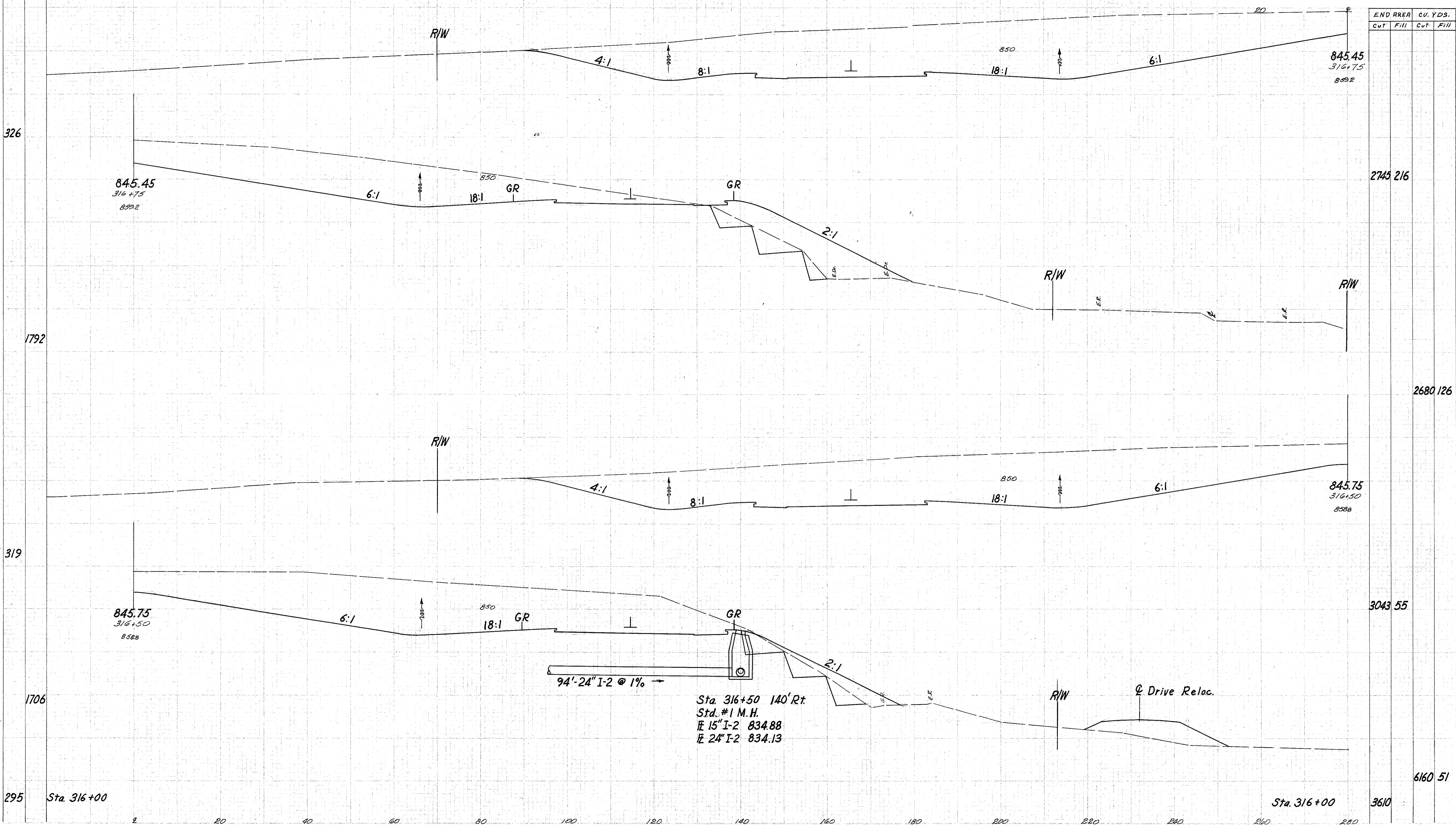

Sta 316+50 140' Rt.  
Std. #1 M.H.  
E 15" I-2 834.88  
E 24" I-2 834.13

94'-24" I-2 @ 1%

Drive Reloc.

295 Sta. 316+00

Sta. 316+00 3610

Sta. 316+50 to 316+75