

SEEDING  
END WIDTH YDS.

DATE: 2/10/10  
 SHEET: 157 OF 306  
 PROJECT: LAKE COUNTY LAK-1-10.38

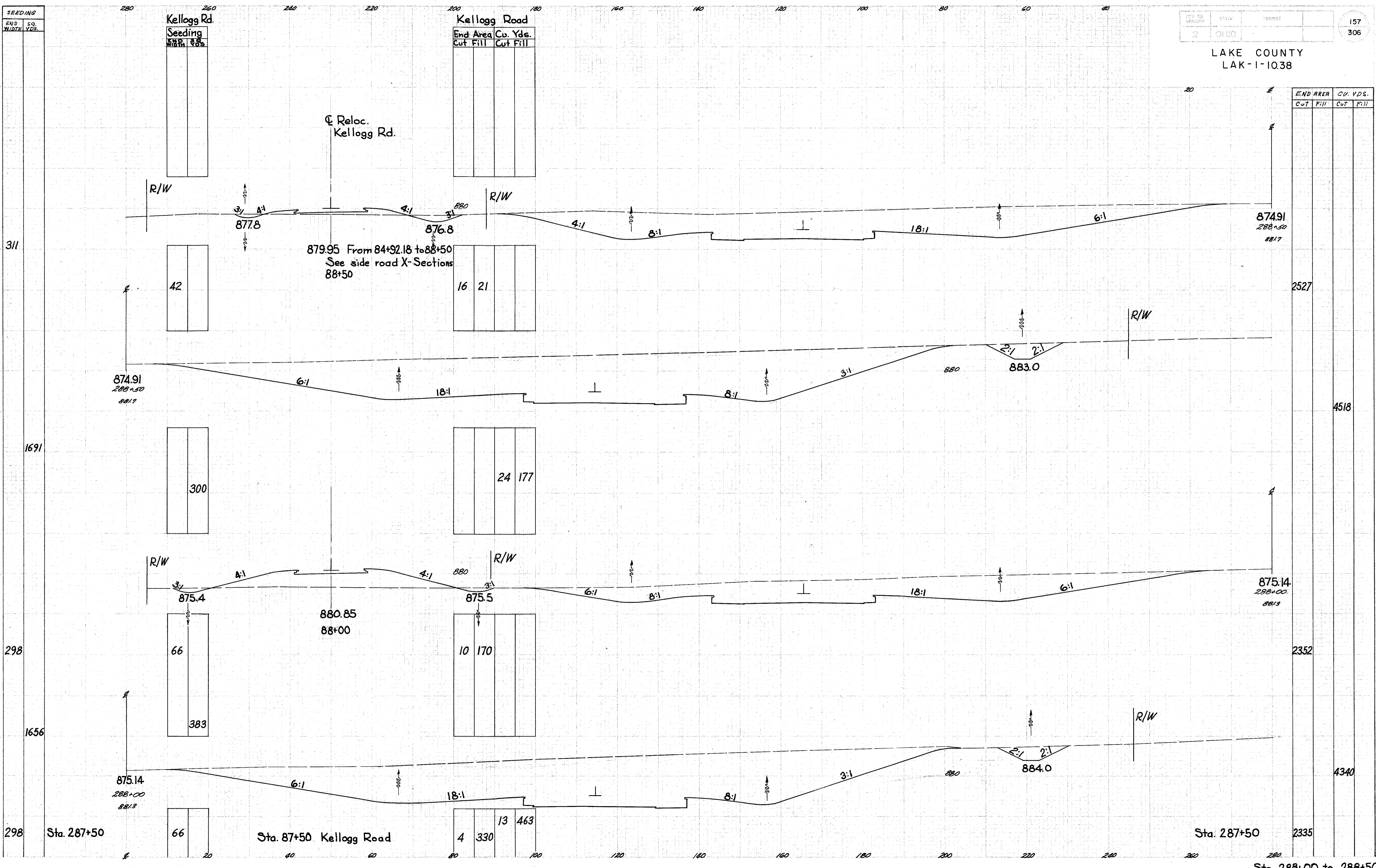

Kellogg Rd.

SEEDING	END WIDTH YDS.
42	385

Kellogg Road

End Area	Cu. Yds.
Cut	Fill
16	21

END AREA	CU. YDS.	
	Cut	Fill
2527	42	385
4518	16	21
2352	24	177
4340	10	170
2335	4	330
	13	463

879.95 From 84+92.18 to 88+50  
 See side road X-Sections  
 88+50

Sta. 87+50 Kellogg Road

Sta. 287+50

Sta. 288+00 to 288+50