

SEEDING
END
WIDTH
Sq.
Yds.

140
306

LAKE COUNTY
LAK-1-10.38

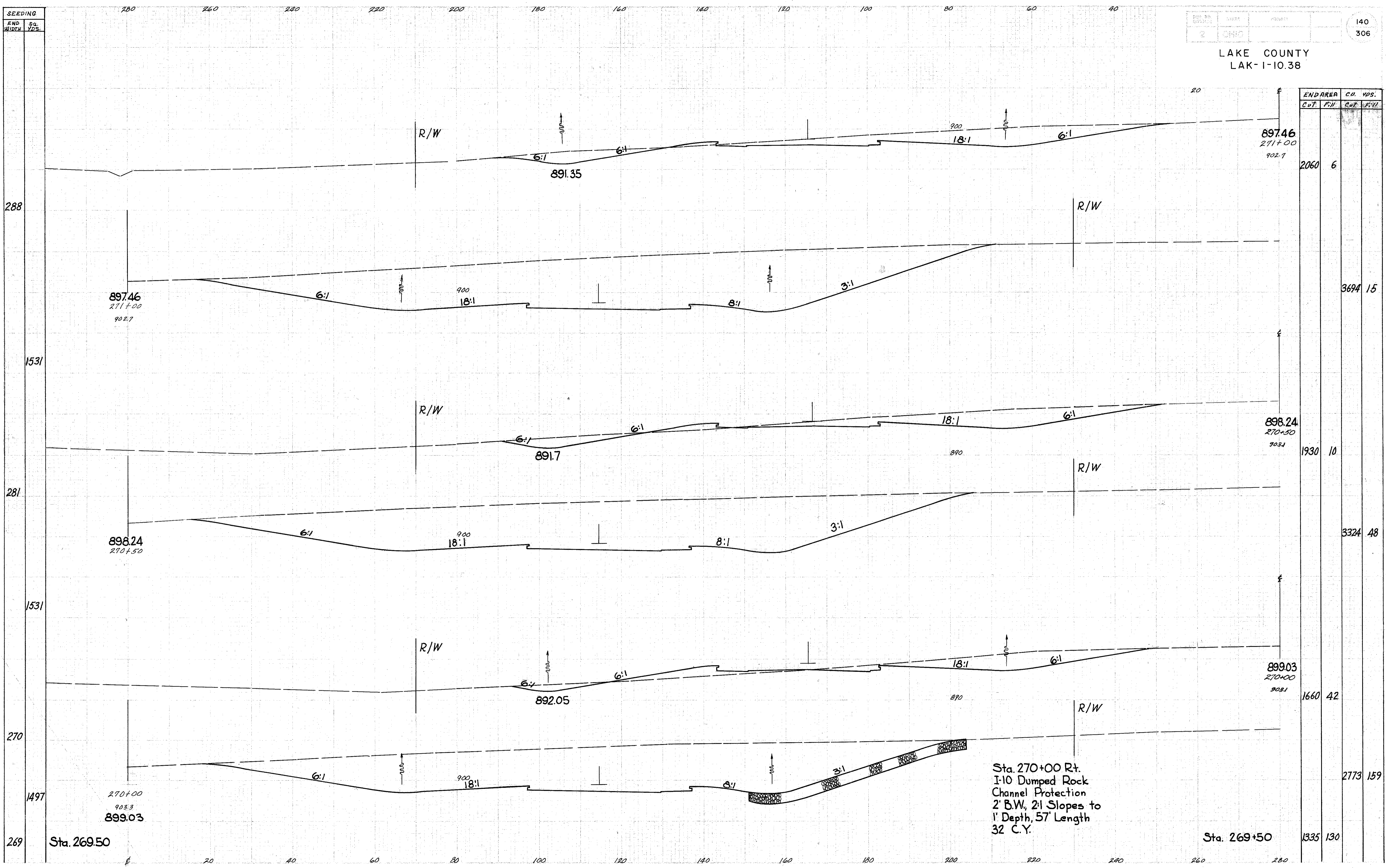

Sta. 270+00 Rt.
 I-10 Dumped Rock
 Channel Protection
 2' B.W., 2:1 Slopes to
 1' Depth, 57' Length
 32 C.Y.

Sta. 270+00 to 271+00