

MICROFILMED
JUN 27 1965

LAKE COUNTY
LAK-I-10.38

SEE SIDE ROAD SHEET NO. 218
FOR PROFILE RELOC. KELLOGG ROAD
SEE SHEET NO. 230

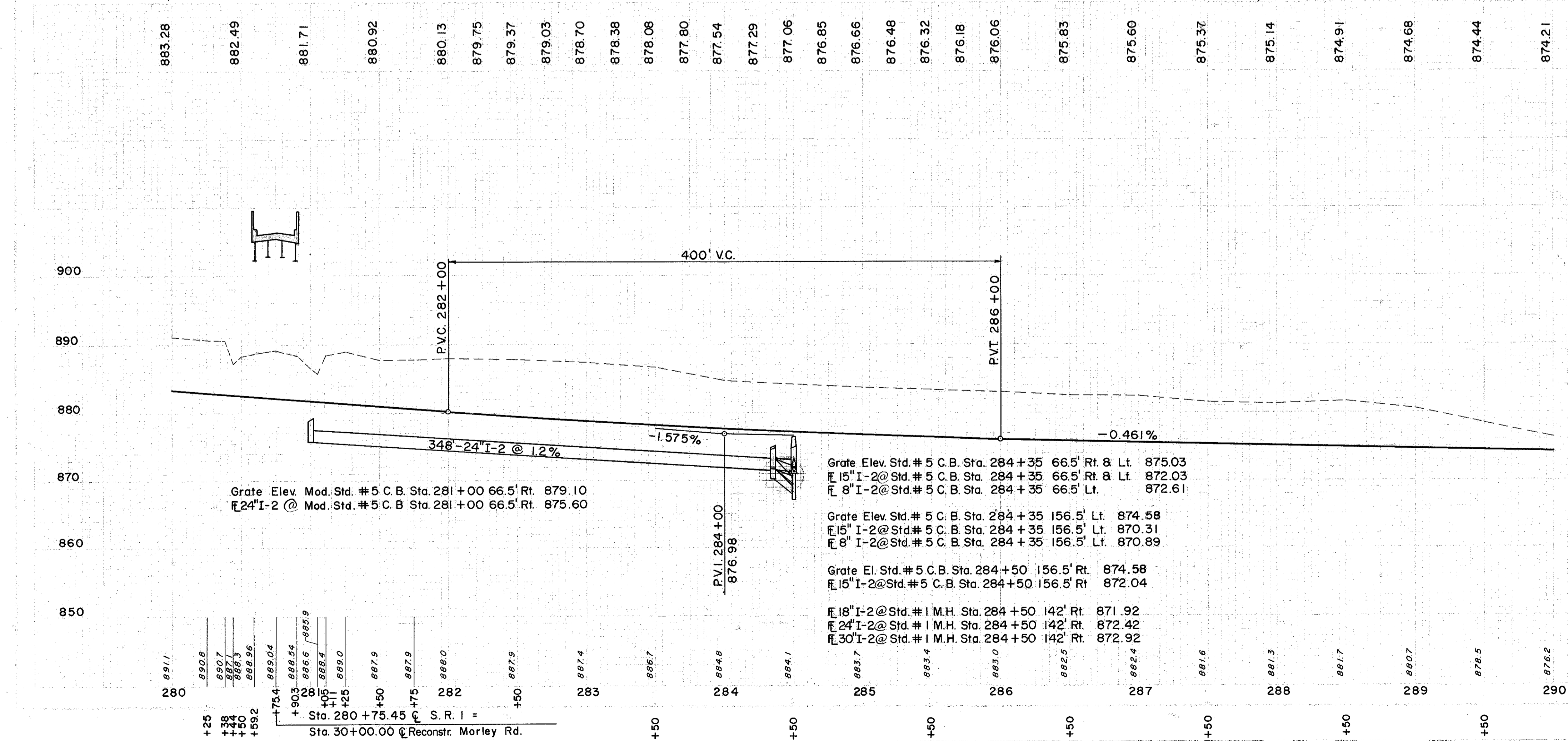
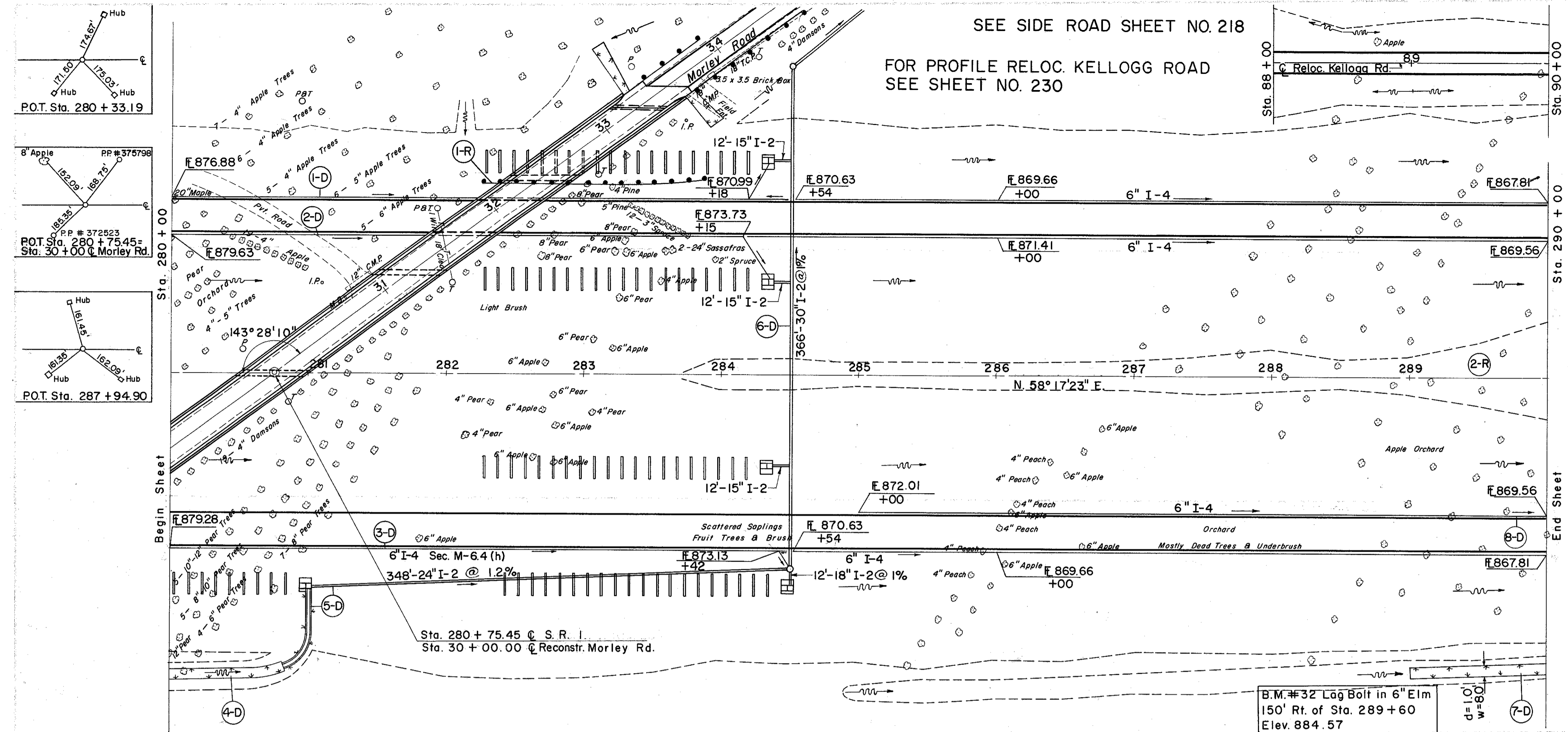

REF. NO.	STATION	CLASS "A" STORM SEWER SEC. M-6.5 (a) OR M-6.8 (g) OR M-6.8 (h)	I-4 PIPE UNDER DRAIN		I-5 GUARD RAIL STEEL BEAM STD. CLEANUP (DEEP)	SIDE CATCH BASIN	I-8 MOD. STD. #5 CATCH BASIN	I-14 PAVED GUTTER TYPE I MOD.	L-10 SODDING
			SHALLOW	DEEP					
	FROM	30"	15"	18"	10				
	TO	30"	15"	18"	10				
	L.T.		1016	546	446				
	R.T.								
	TOTAL		500						

REF. NO.	STATION	SIDE CATCH BASIN		TOTAL
		FROM	TO	
1-R	282+25	283+87.5	17	
2-R	283+50	290+00	17	
	TOTAL		17	17

STA. 88+00 TO STA. 90+00 KELLOGG RD.	
EXCAVATION	= 683 C.Y.
EMBANKMENT	= 196 C.Y.
EMBANKMENT +18%	= 231 C.Y.

STA. 280+00 TO STA. 290+00	
EXCAVATION	= 97,207 C.Y.
EMBANKMENT	= 0 C.Y.
EMBANKMENT +18%	= 0 C.Y.