

MICROFILMED
JUN 27 1965

LAKE COUNTY
LAK-1-10.38

TYPICAL SECTION NOTE: The Typical Section of adjoining project is identical to the Typical Section of this project.

BEGIN PROJECT
I-90-1(25)29
STA. 193+50

CURVE DATA
P.I. Sta. 206+88.93
Δ = 33° 09' 30" Lt.
D = 0° 28' 00"
R = 12277.7'
L = 7105.36'
T = 3655.27'
E = 532.51'

CURVE DATA
KING MEMORIAL
P.I. Sta. 30+19.43
Δ = 12° 52' 30" Lt.
D = 1° 30"
R = 3819.72'
L = 858.33'
T = 430.98'
E = 24.23'

Sta. 199+91.32 @ S.R.I =
Sta. 30+02.80 Constr. @ King Memorial Rd.

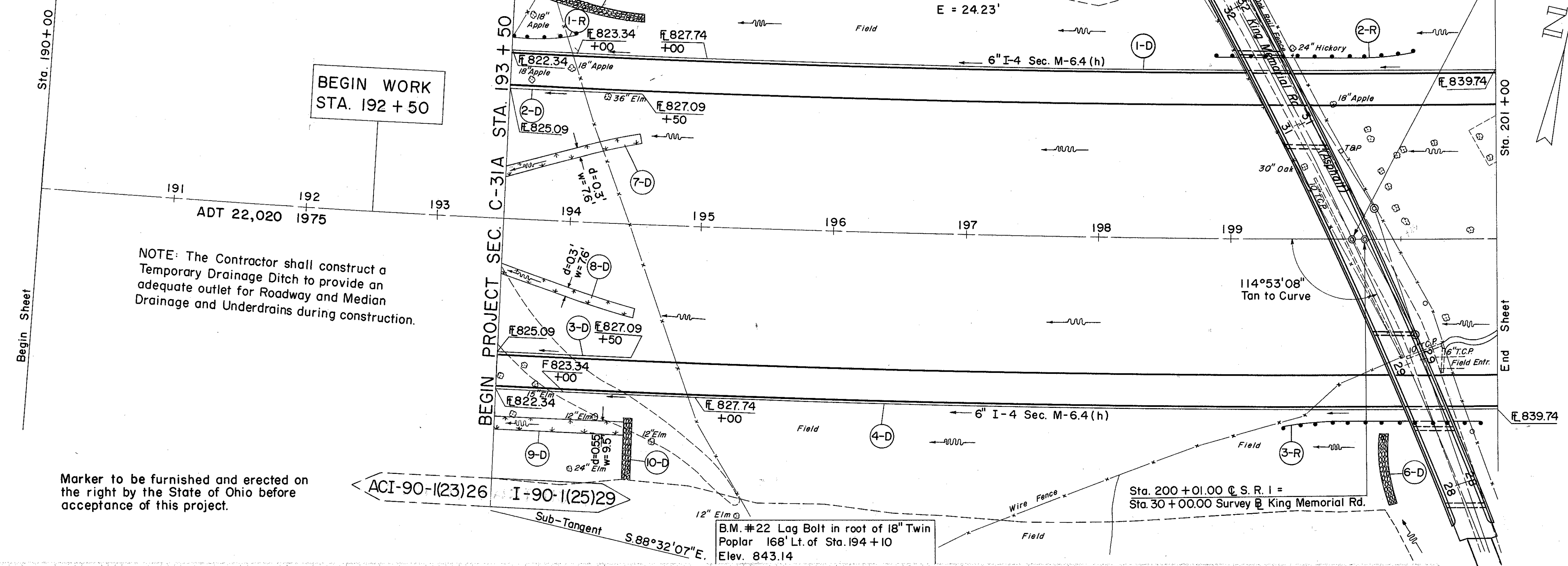

NOTE: The Contractor shall construct a Temporary Drainage Ditch to provide an adequate outlet for Roadway and Median Drainage and Underdrains during construction.

Marker to be furnished and erected on the right by the State of Ohio before acceptance of this project.

D DRAINAGE

REF. NO.	STATION	SIDE	I-4		I-10	L-10		
			6" PIPE UNDERDRAIN				DUMPED ROCK CHANNEL PROTECT	SODDING
			DEEP	SHALLOW				
FROM	TO	LIN. FT.						
1-D	193+50	200+00	Lt.	150	100	500		
2-D	193+50	194+50	Lt.					
3-D	193+50	194+50	Rt.					
4-D	193+50	200+00	Rt.	150		500		
5-D	193+50	194+50	Lt.				55	
6-D	200+20		Rt.				33	
7-D	193+50	194+50	Lt.					84
8-D	193+50	194+50	Rt.					84
9-D	193+50	194+50	Rt.					106
10-D	194+50		Rt.				25	

R ROADWAY

REF. NO.	STATION	SIDE	I-15 GUARD RAIL, STEEL BEAM STD. TYPE (DEEP)	
				L F
1-R	193+50	194+00	Lt.	50
2-R	198+87.5	200+37.5	Lt.	150
3-R	199+37.5	200+87.5	Rt.	150
TOTAL				350

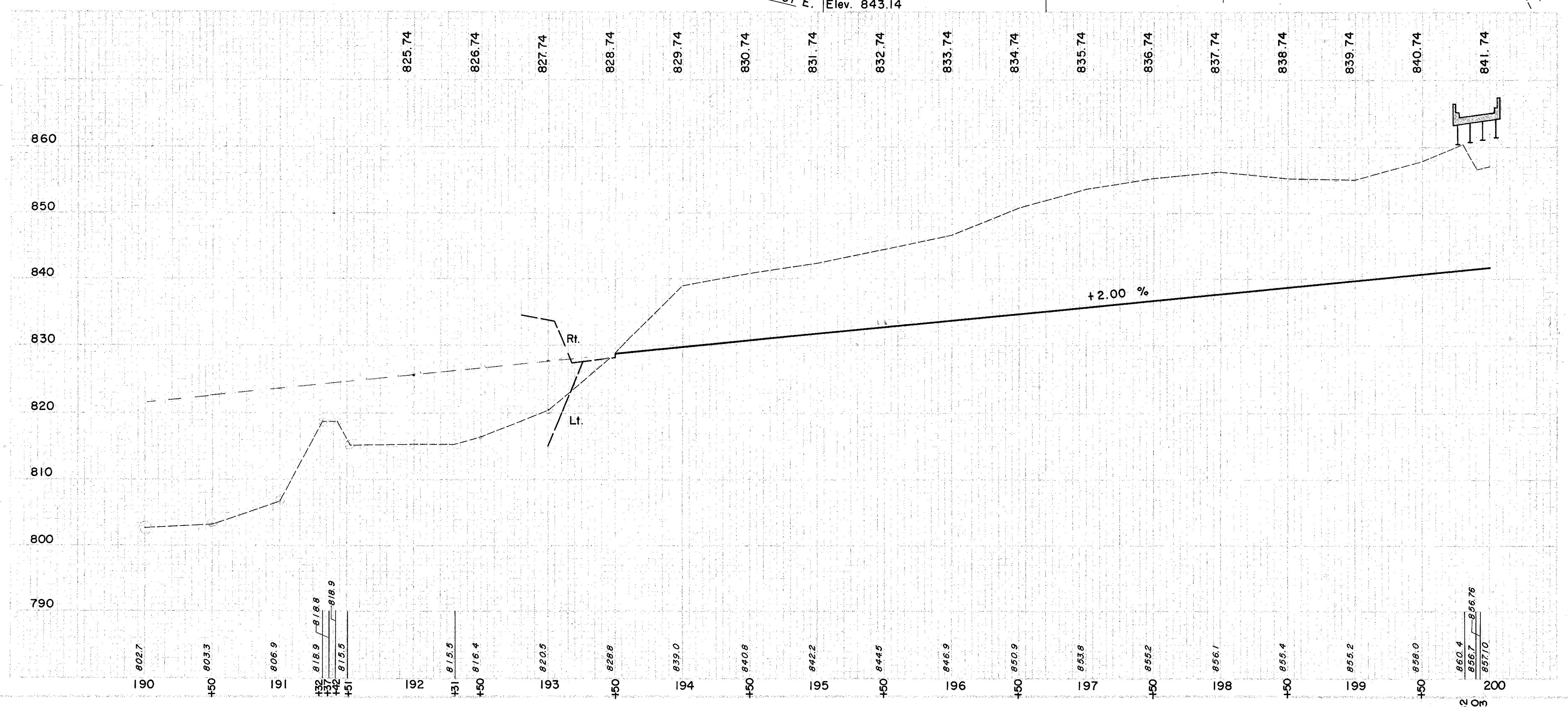

Excavation	117,571 C.Y.
Embankment	1,038 C.Y.
Embankment 18"	1,225 C.Y.