

SCHEMATIC LAYOUT PLAN

MICROFILMED
JUN 27 1985

FED. RD. DIVISION	STATE	PROJECT	2
2	OHIO		306

LAKE COUNTY
LAK-1-10.38

LIGHTS, SIGNS and BARRICADES

- The Contractor shall, in addition to the general requirements of Sec. G-707, on this project perform the following:
- (a) Provide, erect, and maintain movable gates on intersecting roads closed to traffic at all points where local traffic terminates.
 - (b) Provide, erect, and maintain lights, signs, and barricades at the work limits on all intersecting roads which remain open to traffic.
 - (c) Provide, erect, and maintain standard 40"x24" size "Road Closed" signs, sign supports, and lights at the following locations during periods in which the affected roads are closed to through traffic.
 1. All points marked "Temporary Sign" on the Schematic Layout Plan.
 2. Hermitage Rd. just south of intersection with Morley Rd.

Lights, barricades, and danger and warning signs shall be provided at locations shown above in accordance with Sec. G-707. Barricades and gates shall be as detailed in Standard Construction Drawing No. G-707. Sign supports and lights for "Road Closed" signs shall be as detailed in the "Ohio Manual of Uniform Traffic Control Devices."

Payment for providing, erecting, maintaining, and removing barricades, gates, lights, signs, and sign supports shall be included in the lump sum price bid for "Maintaining Traffic."

CURVE DATA
 P.I. Sta. 206 + 88.93
 $\Delta = 33^\circ 09' 30''$ Lt.
 $D = 0^\circ 28' 00''$
 $R = 12,277.7'$
 $L = 7105.36'$
 $T = 3655.27'$
 $E = 532.51'$

EQUATION
 P.T. Sta. 241 + 39.02 Bk. =
 Sta. 242 + 80.20 Ahd.

END PROJECT
 STA. 326 + 50

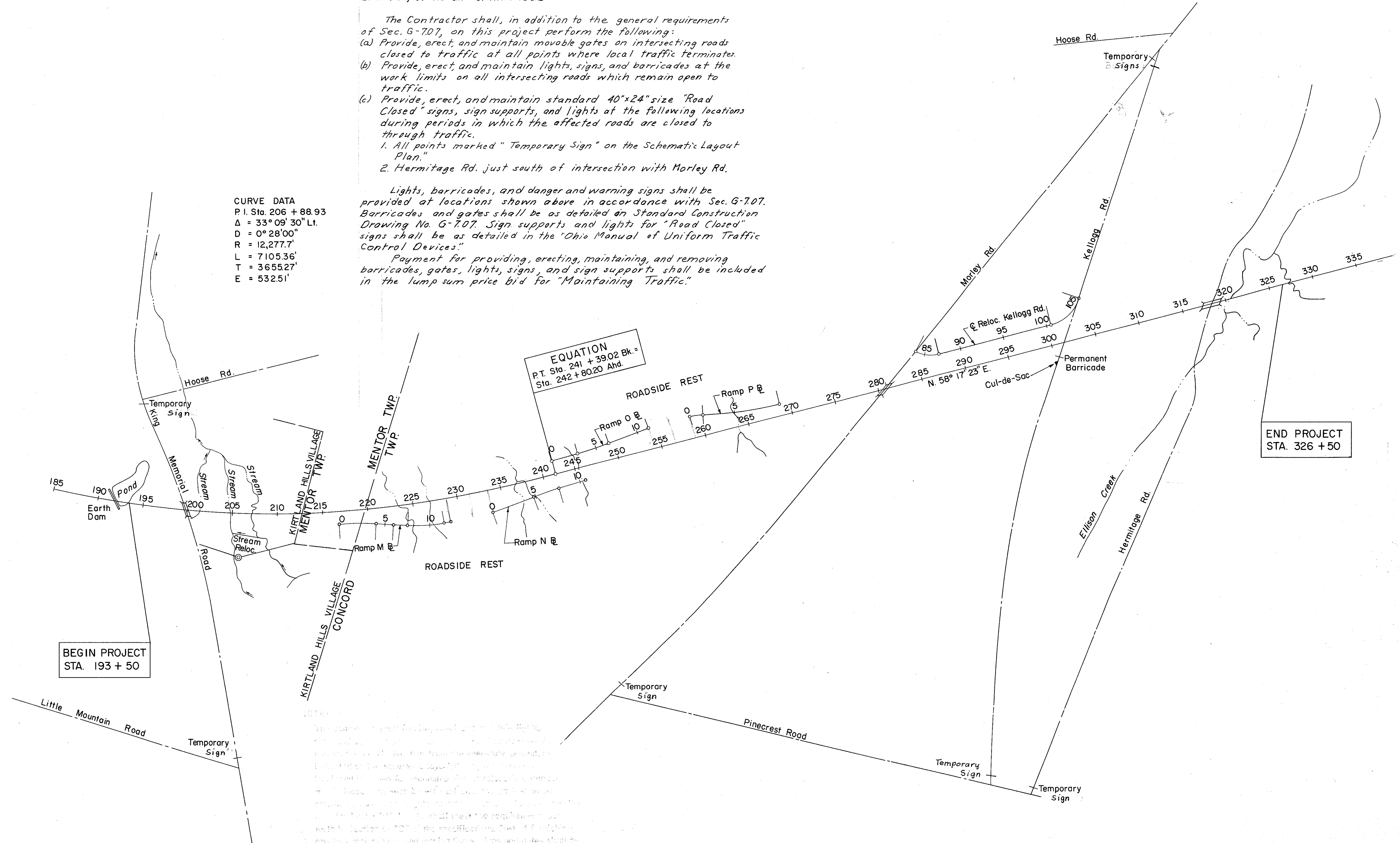

NOTE:
 The contractor shall be responsible for providing and maintaining all traffic control devices, including signs, lights, and barricades, at all times during the project. Payment for these items shall be included in the lump sum price bid for "Maintaining Traffic."