

LAKE COUNTY
LAKE-90/271-1.88/0.00

107A
180

NOTE- OFFSET DISTANCES LISTED ON THIS SHEET
ARE REFERENCED FROM THE EXISTING
INSIDE EDGE OF PAVEMENT, WHICH IS
102'-6" FROM THE CENTERLINE OF I-90

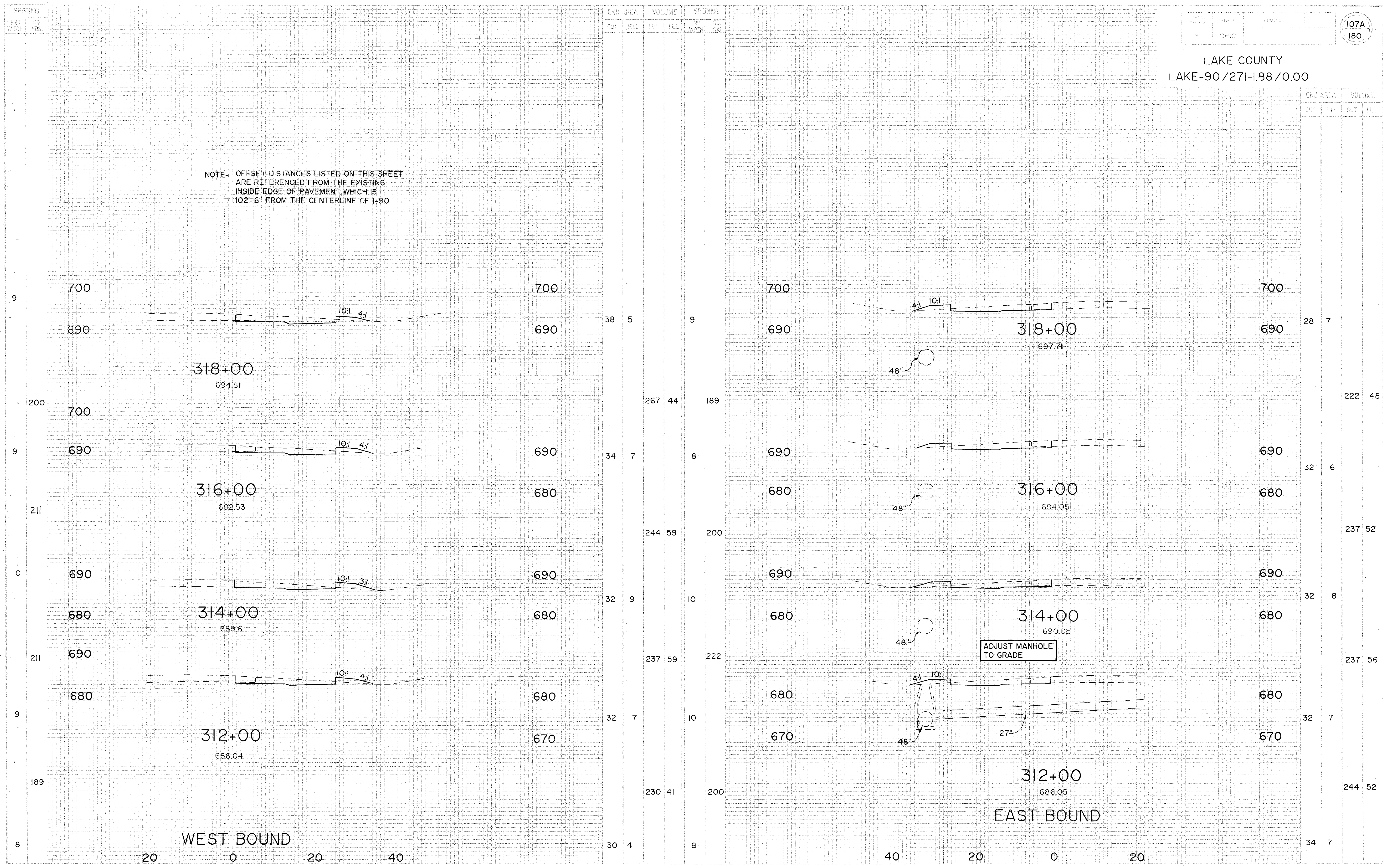

CROSS SECTIONS STA 312+00 TO STA 318+00