

LAKE COUNTY
LAK. 86 - 0.49

GRAND RIVER

CITY OF PAINESVILLE

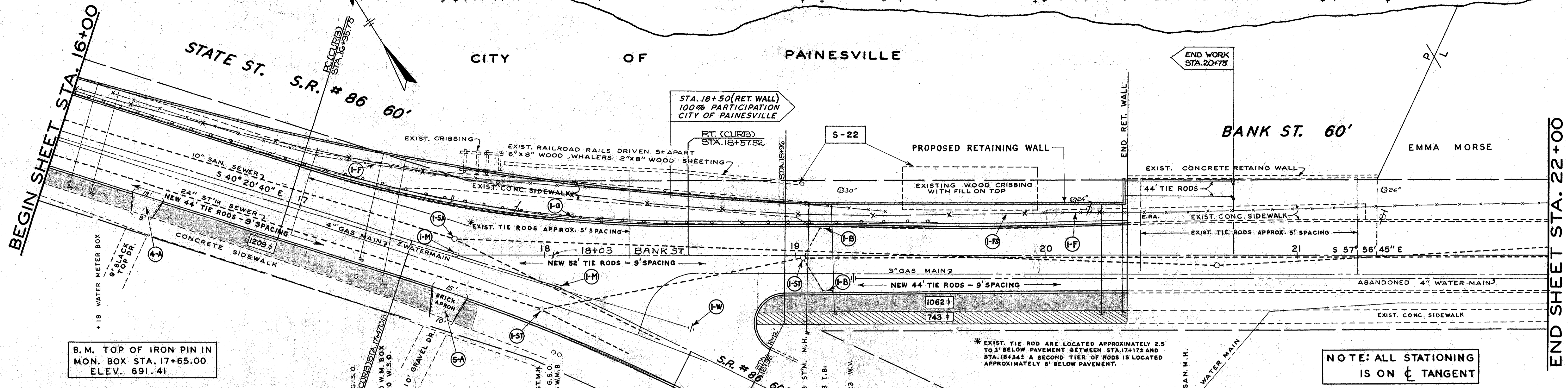

B.M. TOP OF IRON PIN IN
MON. BOX STA. 17+65.00
ELEV. 691.41

NOTE: ALL STATIONING
IS ON ϕ TANGENT

* EXIST. TIE ROD ARE LOCATED APPROXIMATELY 2.5
TO 3' BELOW PAVEMENT BETWEEN STA. 17+172 AND
STA. 18+342 A SECOND TIER OF RODS IS LOCATED
APPROXIMATELY 9' BELOW PAVEMENT.

SPECIAL WROUGHT IRON FENCE REMOVAL			
REF.	STATION	SIDE	LT. LIN. FT.
I-F	16+00	18+50	LT. 243
TOTAL NORMAL PARTIC'ION 243			
I-F	18+50	19+36	LT. 87
I-F	19+99	20+39	LT. 40
TOTAL 100% PAINESVILLE PARTICIPATION 127			
TOTAL 370			

I-15 GUARD RAIL - REMOVE REBUILD			
REF.	STATION	SIDE	LT. LIN. FT.
G-1	16+00	18+50	LT. 240
TOTAL NORMAL PARTICIPATION 240			
G-1	18+50	19+56	106
TOTAL 100% PAINESVILLE PARTICIPATION 106			
TOTAL 346			

SS-18 FENCE TYPE "C"			
REF.	STATION	SIDE	LT. LIN. FT.
I-FS	16+00	18+50	LT. 243
TOTAL NORMAL PARTICIPATION 243			
I-FS	18+50	20+39	LT. 190
TOTAL 100% PAINESVILLE PARTICIPATION 190			
TOTAL 433			

I-13 4" CONCRETE SIDEWALK			
STATION	SIDE	SQ. FT.	
FROM 18+83	TO 20+32.5 RT.	743	
TOTAL 100% PAINESVILLE PARTICIPATION 743			

S-22 REMOVAL OF PORTIONS OF EXISTING STRUCTURE		
STATION	UNIT	
FROM 17+67	TO 19+97	LUMP SUM

T-70 7" PORTLAND CEMENT CONCRETE PAVEMENT			
REF.	STATION	SIDE	SQ. YDS.
4-A	16+41	R	7
5-A	17+67	R	11
TOTAL 18			

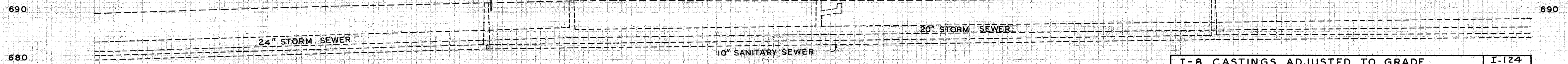

E-8 SIDEWALK REMOVAL		
STATION	SIDE	LT. LIN. FT.
FROM 16+00	TO 18+50	LT. 1755
TOTAL NORMAL PARTIC'N 1755		
18+50	19+07	LT. 347
20+00	20+32.5	LT. 200
18+84	20+32.5	RT. 743
TOTAL 100% PAINESVILLE PARTICIPATION 1290		
TOTAL 3045		

ROADWAY QUANTITIES					
STATION	T-71	I-12	E-8	E-8	E-1
	REINFORCED PORTLAND CEMENT PAVEMENT	CONCRETE CURB TYPE-2A	REMOVAL & DISPOSAL OF EXISTING CURB	REMOVAL & DISPOSAL OF EXISTING PAVEMENT	COMPACTED SUBGRADE
FROM TO	SQ. YDS.	LT. FT.	LT. FT.	SQ. YDS.	SQ. YDS.
16+00 16+95.75	330	192	192	319	330
TOTAL NORMAL PARTICIPATION 330 192 192 319 330					

L-9 SEEDING AND PROTECTING QUANTITIES					
STATION	SEEDING PROTECTING		COMMERCIAL FERTILIZER		AGRICULTURAL LIMING MATERIAL
	AREA SQ. FT.	AREA SQ. YDS.	AREA SQ. FT.	AREA X 0.01 TON/1000 SQ. FT.	AREA SQ. FT. X 0.05 TON/1000 SQ. FT.
FROM 16+00	TO 17+80	1209	134	1209	0.01
TOTAL NORMAL PART. 134 0.01 0.06					
18+84	20+32.5	1062	118	0.01	0.05
TOTAL 100% PAINESVILLE PARTICIPATION 118 0.01 0.05					
TOTAL 252 0.02 0.11					

I-8 CASTINGS ADJUSTED TO GRADE						I-124
REF.	STATION	MON. BOX	INLET BASINS	STORM M.H.'S	SANITARY M.H.'S	Water Valve Box Adj. to G.
	FROM TO	EACH	EACH	EACH	EACH	EACH
I-M	16+00	18+50	2			
I-ST	16+00	18+50		1		
TOTAL NORMAL PARTIC'N 2 1 1						
I-SA	16+00	20+32.1				
I-B	18+50	20+32.5		2		
I-ST	18+50	20+32.5		1		
I-W	18+50	20+32.5				1
TOTAL 100% PAINESVILLE PARTICIPATION 2 2 1 1 1						
TOTAL 2 2 2 1 1						

See Cross Sections for
Excavation Items

See Cross Sections for
Excavation Items