

BENCH MARK #7
TOP N.W.COR.CONC.SLAB AT
BASE OF FLAG POLE
STA. 106+28±RT.
ELEV. 700.74

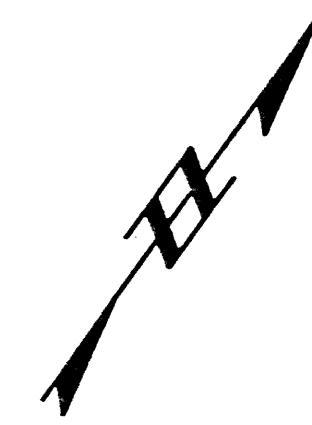

 DENOTES ASPHALT PAVEMENT WIDENING

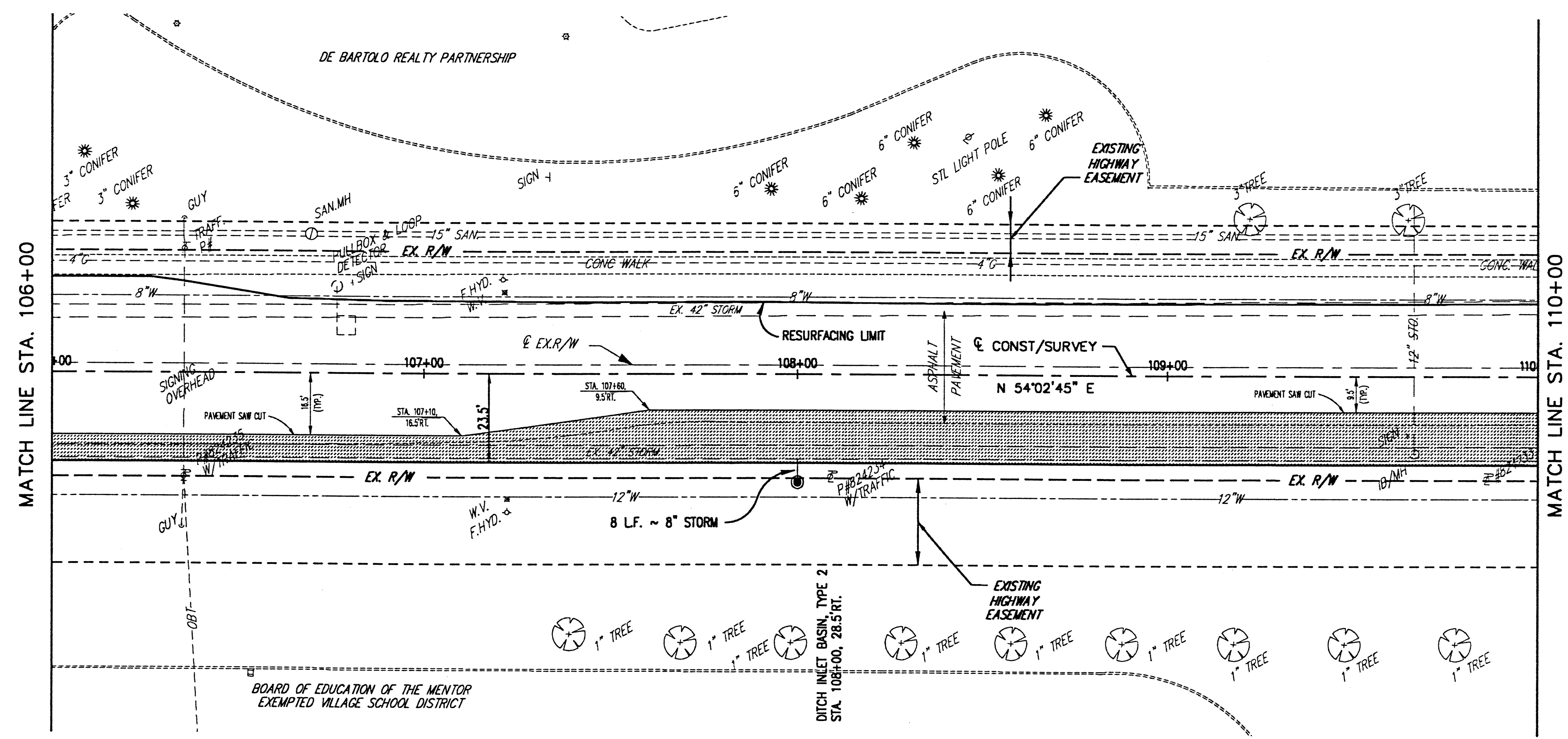

PROPOSED SWALE GRADES	106+00	107+00	108+00	109+00	110+00	PROPOSED SWALE GRADES			
695	GR = +0.88%		GR = -0.94%	GR = +0.50%	GR = -0.60%	695			
690			8 I.F. ~ 8" STORM FIELD TEE CONNECTION INTO EX. 42" STORM RT. INV. 688.0±			690			
685	EX. 15" SAN.	EX. 42" STO.	EX. 42" STORM	EX. 15" SAN.	EX. 42" STO.	685			
680		EX. SAN. MH. STA. 106+68.5, 37'L.T. RIM 695.87 15" SW. 687.21 15" NE. 687.15			EX. STA. 109+68.5, 20.5' RT. RIM 693.75 12" NW. 687.75 42" SW. 685.50 42" NE. 685.46	680			
675			DITCH INLET BASIN, TYPE 2 STA. 108+00, 28.5' RT. RIM 693.70 12" INV. N 689.70			675			
670						670			
EXISTING PROFILE GRADE	695.67	695.52	695.45	695.38	695.27	695.14	695.01	694.90	694.81

H:\2000\00123\SDSK\84PP22.DWG - PLOT SCALE = 1:20



REV. NO.	DESCRIPTION	DATE	BY	CHK'D.

**STATE ROUTE 84
INTERIM WIDENING & RESURFACING
IMPROVEMENTS**
CITY OF MENTOR, LAKE COUNTY, OHIO

DATE: MARCH, 2000
DRAWN BY: J.J.C.
CHECKED BY: C.C.H.
APPROVED BY: C.C.H.
F.B. No. PG.

**S.R. 84 - PLAN AND PROFILE
STA. 106+00 TO STA. 110+00**

SCALE	
HOR.	1" = 20'
VERT.	1" = 5'
CONTRACT No.	
00123	
SHEET NO.	OF
32	74