

MICROFILMED
OCT 21 1985

FHWA REGION	STATE	PROJECT	
5	OHIO		

LAKE COUNTY
LAK-84-06.33

5
16

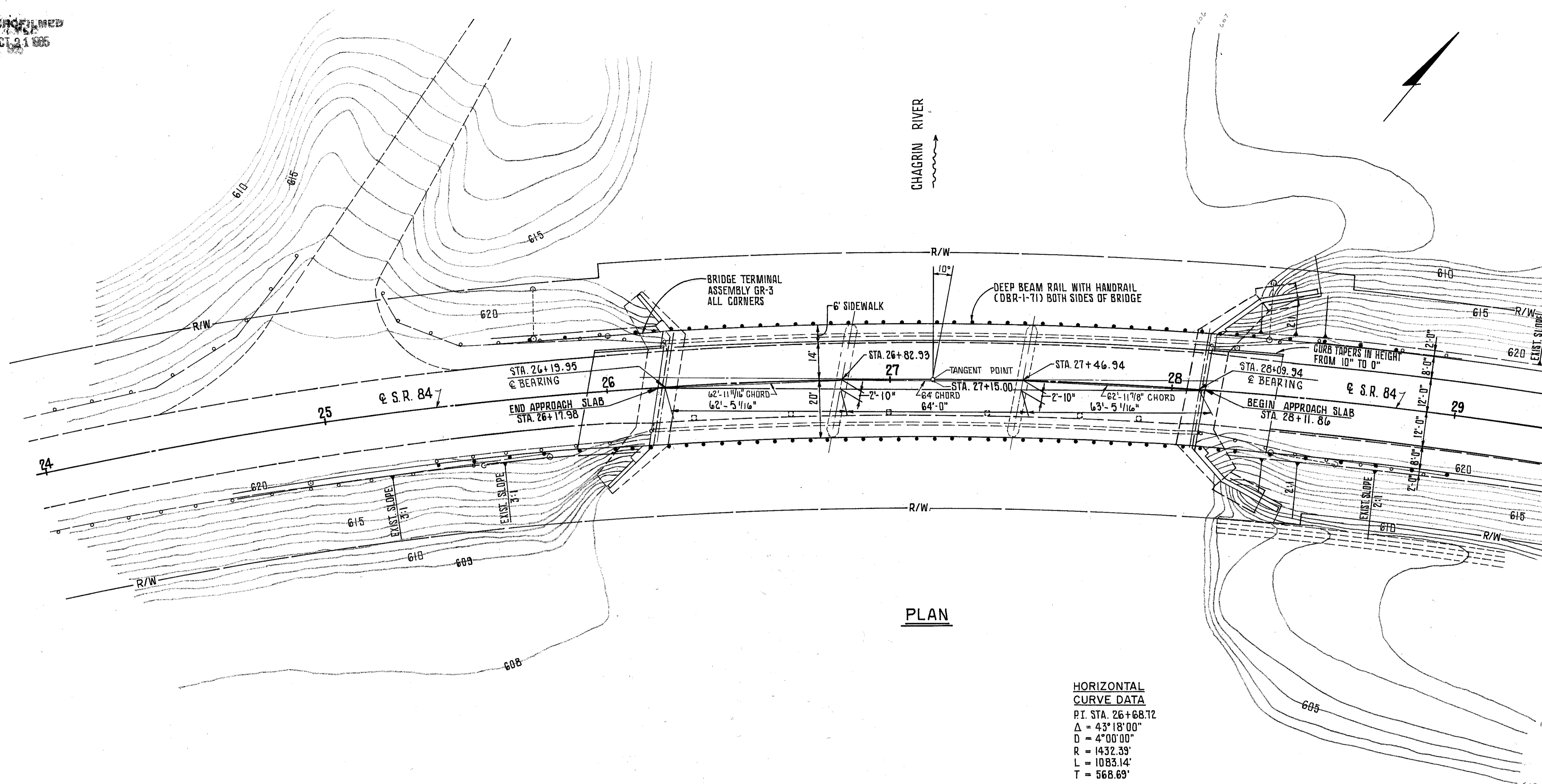

PLAN

HORIZONTAL CURVE DATA
P.I. STA. 26+68.72
Δ = 43° 18' 00"
D = 4° 00' 00"
R = 1432.39'
L = 1083.14'
T = 568.69'

DRAINAGE AREA = 246 SQ. MILES

EXISTING STRUCTURE
TYPE: CONTINUOUS REINFORCED CONCRETE BEAM WITH REINFORCED CONCRETE SUBSTRUCTURE
SPANS: 3 SPANS OF 64'-0" MEASURED ALONG CHORDS
ROADWAY: 25'-0" FACE TO FACE 2'-6" SAFETY CURBS
LOADING: H-15
WEARING SURFACE: ASPHALT CONCRETE
SKIEW: 10° LEFT FORWARD
APPROACH SLAB: 23'-0"
ALIGNMENT: 4° CURVE TO THE RIGHT
SUPERELEVATION: 0.045 FT. PER FT.

PROPOSED STRUCTURE
TYPE: PARTIALLY CONTINUOUS PRESTRESSED NON-COMPOSITE BOX BEAM BRIDGE ON EXISTING MODIFIED SUBSTRUCTURE
SPANS: 3 SPANS OF 64' MEASURED ALONG CHORD
ROADWAY: 34'-0" CURB TO EDGE OF DECK & 6' SIDEWALK
LOADING: HS 20-44 & ALTERNATE MILITARY LOADING
WEARING SURFACE: 2 1/2" ASPHALT CONCRETE
SKIEW: 10° LEFT FORWARD
APPROACH SLAB: AS-1-81 (25' LONG)
ALIGNMENT: 4° 00' 00" CURVE
SUPERELEVATION: 0.045 FT. PER FT.
A.D.T.

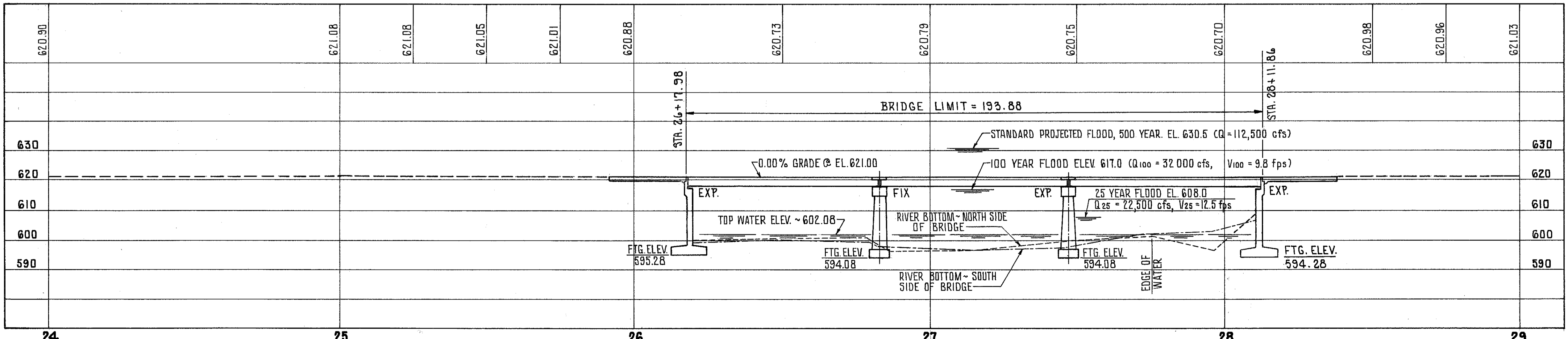

PROFILE ALONG @ S.R. 84

COLPETZER WOODS CONSULTANTS, INC.		1 / 12
MENTOR,		OHIO
SITE PLAN		
BRIDGE NO. LAK-84-0633		
S.R. 84 OVER		
THE CHAGRIN RIVER		
DESIGNED	DRAWN	TRACED
FA.	G.K.S.	G.K.S.
CHECKED	REVIEWED	DATE
PCB	J4	5-5-82

BRUNING 44132 30845-1