

LAKE COUNTY  
SH. 563 SEC. B

Line B  
Proposed

|       |       |       |
|-------|-------|-------|
| 26+28 | 596.7 |       |
| 26+42 | 596.3 |       |
| 26+50 | 596.7 | 596.9 |
| 27+0  | 596.9 | 596.6 |
| 27+50 | 596.8 | 596.2 |
| 27+84 | 596.2 |       |

**DATA ON ROCK ELEVATIONS**  
Soundings were taken by probing with a 3/4" smooth bar.  
The State of Ohio assumes no responsibility for the accuracy of these soundings.

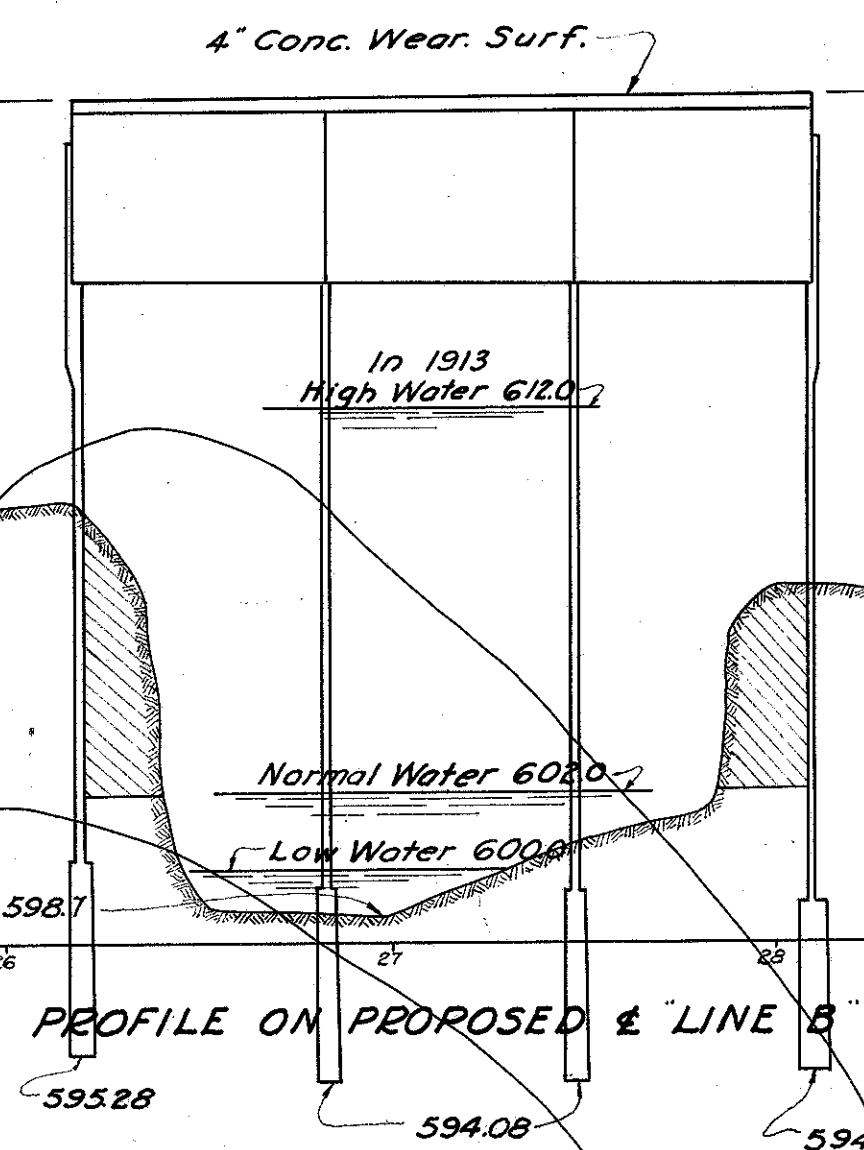
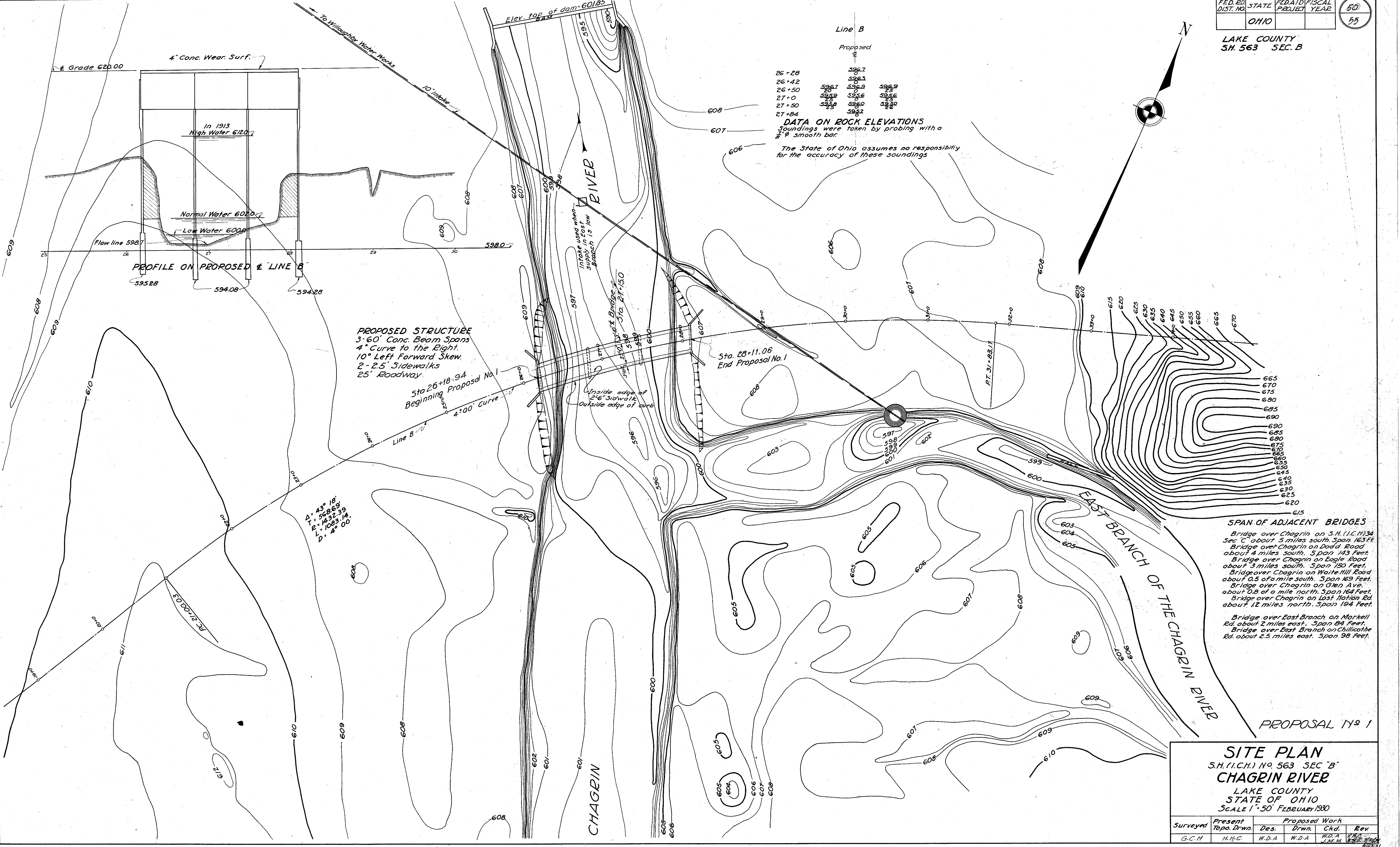

**PROPOSED STRUCTURE**  
3'-60" Conc. Beam Spans  
4° Curve to the Right  
10° Left Forward Skew  
2'-2.5" Sidewalks  
25' Roadway

Sta 26+18.94  
Beginning Proposal No. 1

4°00' Curve

Line B

Sta. 28+11.06  
End Proposal No. 1

Δ = 43° 18'  
T = 568.69  
R = 1432.39  
L = 1083.14  
D = 4° 00'

- SPAN OF ADJACENT BRIDGES**
- Bridge over Chagrin on S.H. (I.C.H.) 34 Sec C about 5 miles south. Span 163 Feet.
  - Bridge over Chagrin on Dodd Road about 4 miles south. Span 143 Feet.
  - Bridge over Chagrin on Eagle Road about 3 miles south. Span 150 Feet.
  - Bridge over Chagrin on Waite Hill Road about 0.5 of a mile south. Span 169 Feet.
  - Bridge over Chagrin on Glen Ave. about 0.8 of a mile north. Span 164 Feet.
  - Bridge over Chagrin on East Nation Rd. about 1.2 miles north. Span 194 Feet.
  - Bridge over East Branch on Markell Rd. about 2 miles east. Span 84 Feet.
  - Bridge over East Branch on Chillicothe Rd. about 2.5 miles east. Span 98 Feet.

PROPOSAL No. 1

**SITE PLAN**  
S.H. (I.C.H.) No. 563 SEC. B  
**CHAGRIN RIVER**  
LAKE COUNTY  
STATE OF OHIO  
SCALE 1" = 50' FEBRUARY 1930

| Surveyed | Present Topo. Drwn. | Proposed Work |        |        |        |
|----------|---------------------|---------------|--------|--------|--------|
|          |                     | Des.          | Drwn.  | Ckd.   | Rev.   |
| G.C.H.   | H.H.G.              | W.D.A.        | W.D.A. | W.D.A. | J.M.M. |