

SUMMARY OF TYPE D GUARD RAIL

From Sta.	To Sta.	Lin. Ft. on R.	Lin. Ft. on W.
69+80	72+60	256	280
69+80	72+36		

Sta. 71+25-42 L to Sta. 75+37-40 R
Lay 424'-15" V.P.S. thru I.B.s. Headwall at 71+25. Ave. Cut 3'-6".
424' lin. ft. 15" V.P.
16 cu yds. 1-5% Concrete
55 lbs. Reinf. Steel

Sta. 74+60
Build Std. I.B. 22.5' R of & over sewer.

Sta. 75+37
Build Std. I.B. 40' R of & over new existing 15" sewer, capping hole in existing 12" V.P.S.

LEFT		CENTER LINE				RIGHT	
Add to Edge	Elevation Edge	Width	STATION	GRADE	DEFLECTION	Width	Elevation Edge
0.00	699.43	10.00	69+80.00	699.53		10.00	699.43
0.25	699.46		69+82.50	699.31		10.10	699.21
0.50	699.50		69+85.00	699.10		10.36	699.00
0.75	699.53		69+87.50	698.88		10.62	698.78
1.00	699.57		69+90.00	698.67	0°-00'-00"	11.51	698.57
1.25	699.64		70+25.00	698.42	1°-15'-21"	12.15	698.39
1.52	699.77		70+25.00	698.35	2°-29'-48"	12.42	698.25
	699.70		71+00.00	698.28	3°-45'-09"		698.18
	699.82		71+00.00	698.26	5°-00'-03"		698.16
	699.71		71+25.00	698.22	6°-14'-57"		698.13
	699.81		71+50.00	698.39	7°-29'-51"		698.29
	699.96		71+75.00	698.54	8°-44'-45"		698.44
	700.17		72+00.00	698.75	9°-59'-39"		698.65
	700.40		72+25.00	698.98	11°-14'-33"		698.88
	700.64		72+50.00	699.22	12°-29'-27"		699.12
	700.87		73+00.00	699.45	13°-44'-21"		699.35
	701.11		73+25.00	699.69	14°-59'-15"		699.59
1.52	701.18		73+25.00	699.71	15°-06'-09"	12.42	699.61
1.27	701.09		73+50.00	699.92	16°-14'-09"	12.16	699.82
1.02	701.08		74+00.00	700.16	17°-29'-03"	11.57	700.06
1.00	701.08		PT. +52.30	700.18	17°-36'	11.51	700.08
0.77	701.04		74+25.00	700.37		10.84	700.27
0.52	700.97		74+50.00	700.55		10.39	700.45
0.21	700.85		74+75.00	700.68		10.11	700.58
0.00	700.69	10.00	75+00.00	700.79		10.00	700.69

100.2 sq yds Extra Paving

B.M. 75+26
Spike in rear 24'M.
30' to R of &
Elev. 700.30

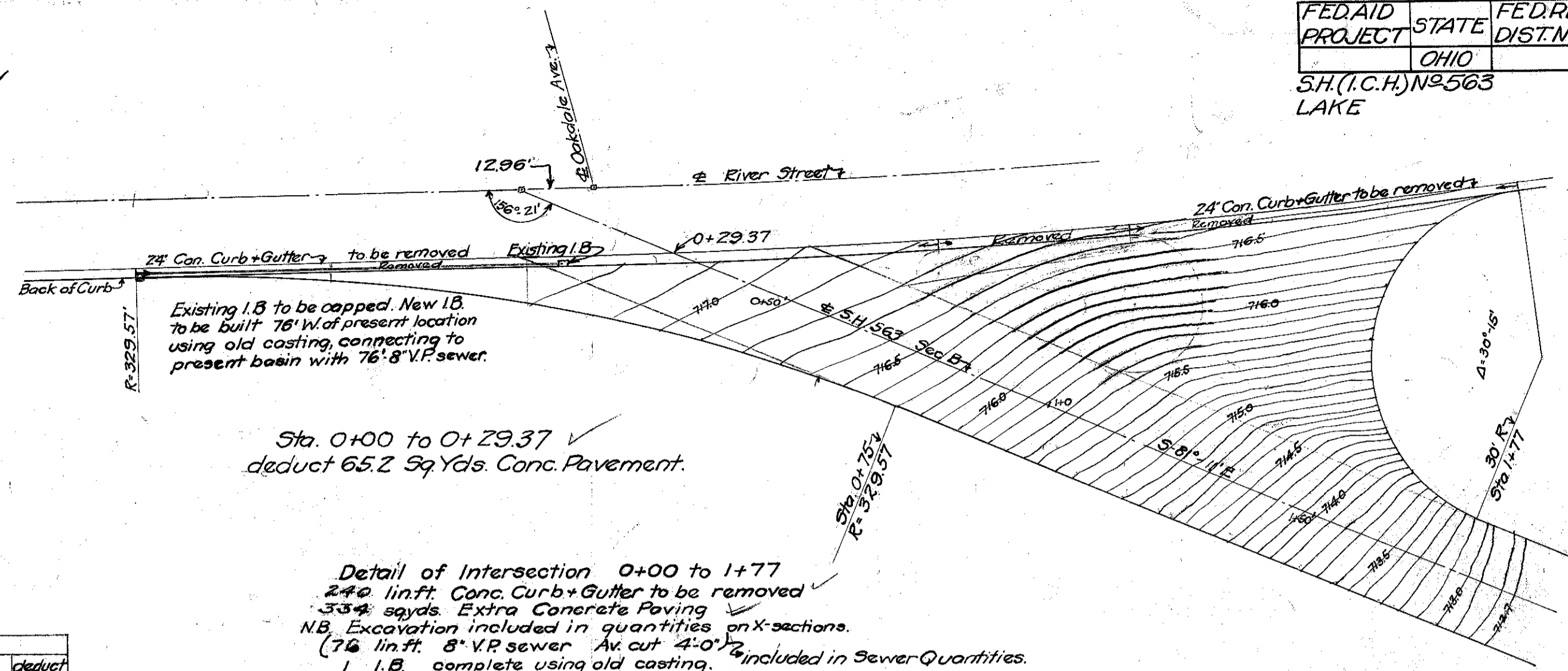

Sta. 0+00 to 0+29.57
deduct 65.2 Sq Yds. Conc. Pavement.

Detail of Intersection 0+00 to 1+77
24" lin. ft. Conc. Curb+Gutter to be removed
33.3 sq yds. Extra Concrete Paving
NB. Excavation included in quantities on X-sections.
(76' lin. ft. 8" V.P. sewer Av. cut 4'-0")
I.B. complete using old casting. included in Sewer Quantities.
1" = 20'

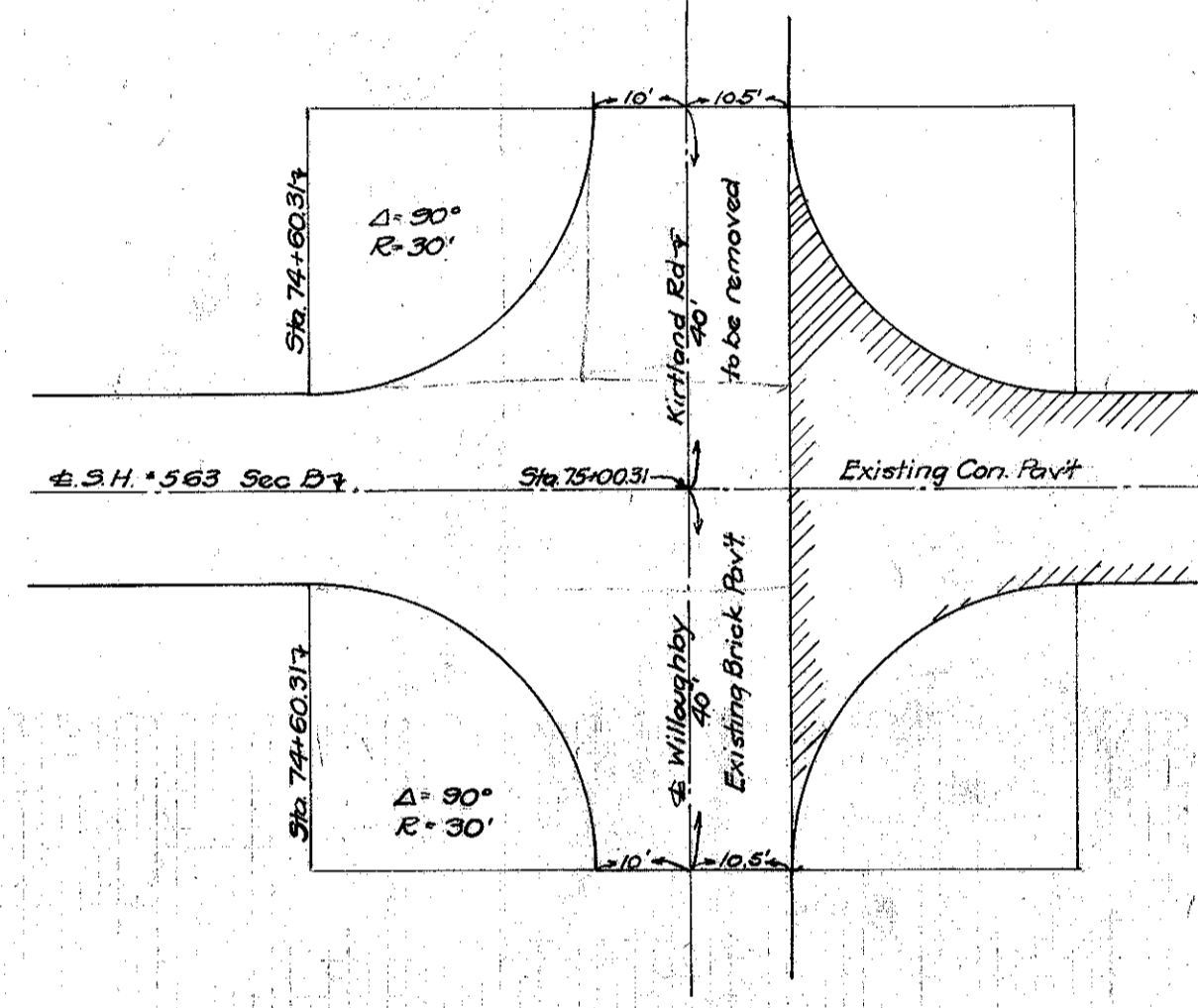

Detail of Intersection at Sta. 75+00.31
93.3 sq yds brick pavt removed (included in excar.)
1796 sq yds extra concrete paving
1" = 20'

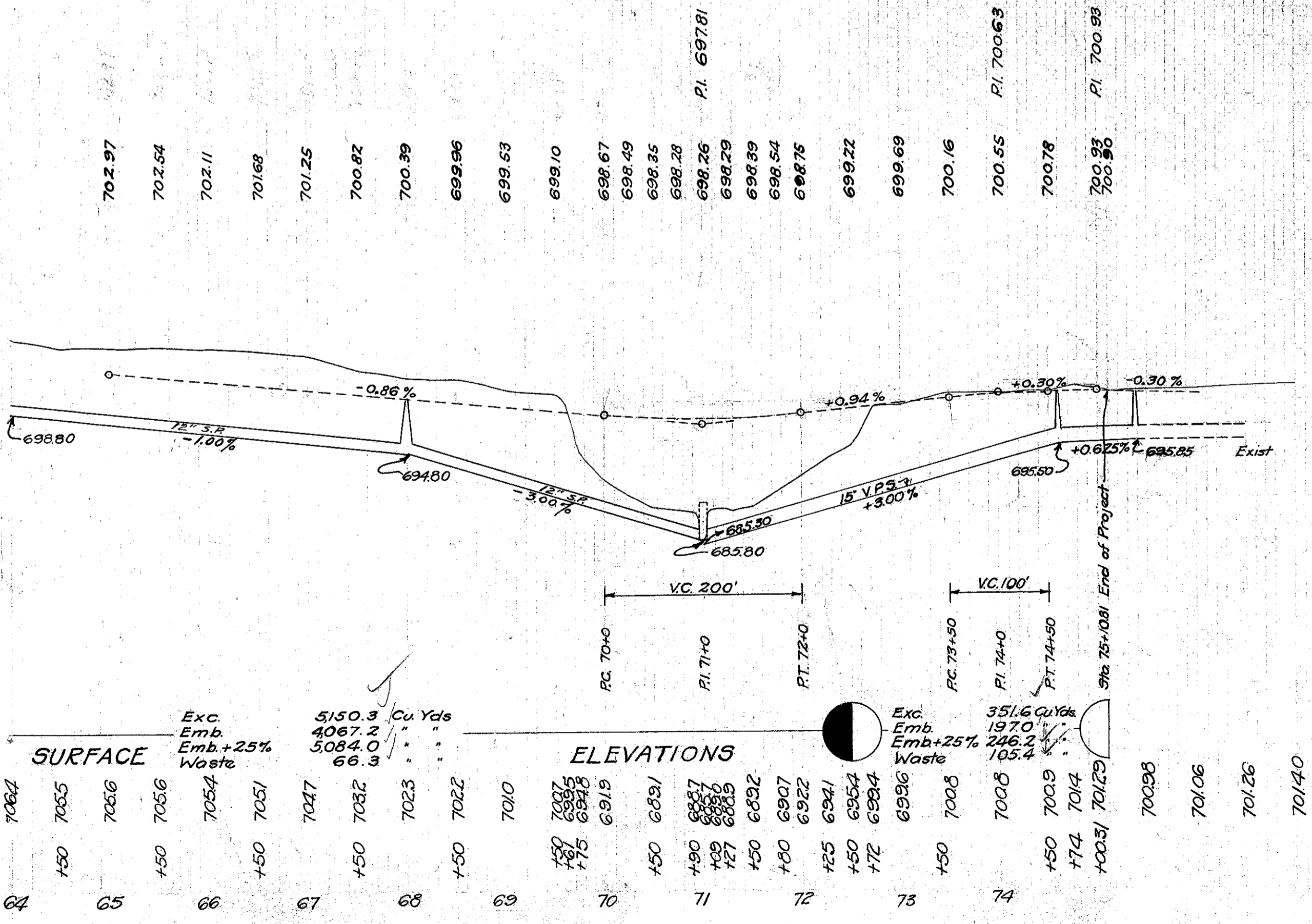

SURFACE

Sta.	Elev.
64	706.2
65	706.5
66	706.6
67	706.4
68	706.5
69	706.7
70	706.8
71	706.9
72	707.0
73	707.1
74	707.2

ELEVATIONS

Sta.	Elev.
69	698.0
70	698.5
71	699.0
72	699.5
73	700.0
74	700.5

Exc. Emb. +25% Waste
5150.3 Cu Yds
4067.2
3084.0
66.3

Exc. Emb. +25% Waste
351.6 Cu Yds
197.0
246.2
105.4