

FED. RD. DIST. NO.	STATE	FISCAL YEAR
10	OHIO	1936

2
2

S.H. 563 SEC. F(PI) G
LAKE COUNTY
P.I. 155+08.34
Δ = 6°-13'-00" L

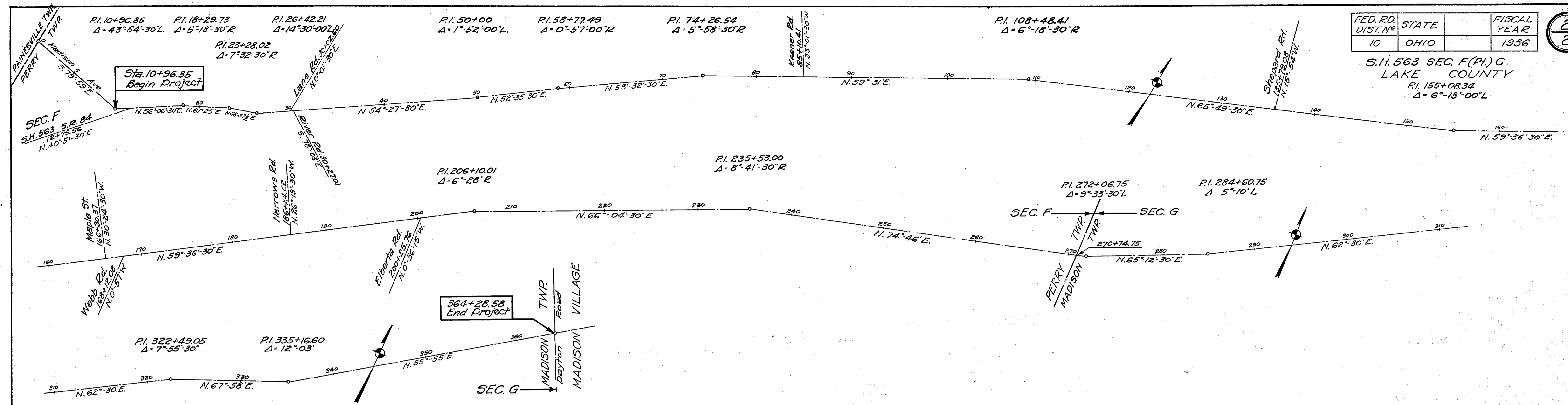

ALIGNMENT & IMPROVEMENT

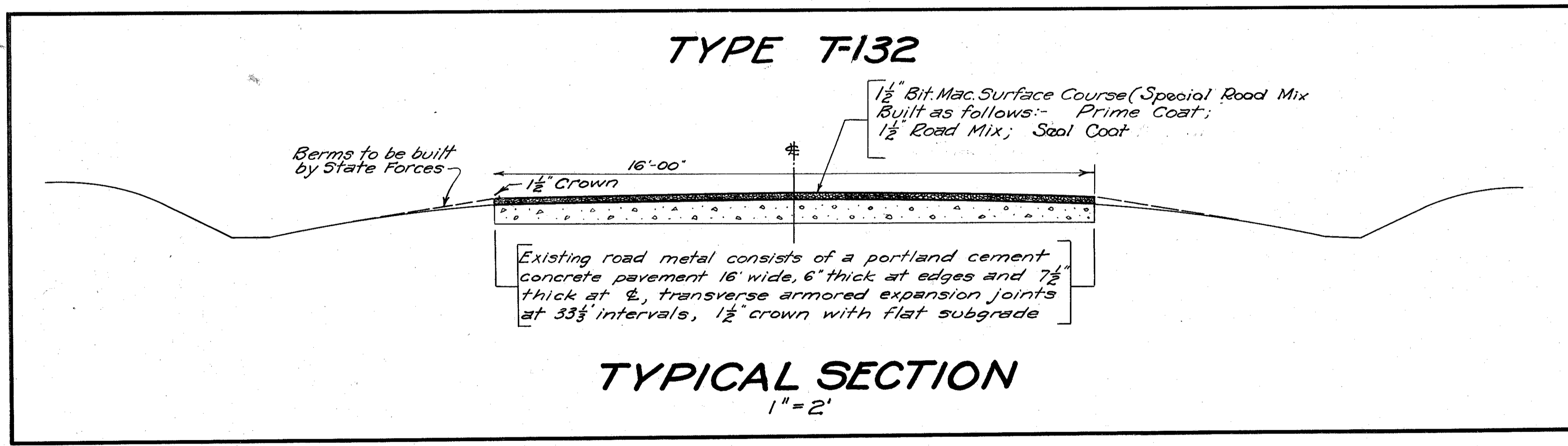

PAVEMENT CALCULATIONS

ITEM	UNITS	QUANTITY
T-30 Bituminous Prime Coat Sec. M-105.6 ACB 3a	Gal.	62,812.85 x 0.1 = 6,281.29
T-132 No. 46 Aggregate for Special Road Mix	Cu. Yds.	62,812.85 x 0.055 = 3,454.51
T-132 No. 6 Aggregate for Seal Coat Sec. M-3.1	Cu. Yds.	62,812.85 x 0.0063 = 396.82
T-132 Fine Aggregate for Filler	Cu. Yds.	62,812.85 x 0.008 = 502.50
BITUMINOUS MATERIAL-USE WITH AGGREGATE		
T-132 Bituminous Material Sec. M-105.6 ACB 3a for Special Road Mix	Gal.	62,812.85 x 1.10 = 69,094.14
T-132 Bituminous Material Sec. M-105.6, ACB 3a for Seal Coat	Gal.	62,812.85 x 0.25 = 15,703.21
BITUMINOUS MATERIAL-USE WITH AGGREGATE		
T-132 Bituminous Material Sec. M-105.6 ACB 3a for Special Road Mix	Gal.	62,812.85 x 1.35 = 84,797.35
T-132 Bituminous Material Sec. M-105.6 ACB 3a for Seal Coat	Gal.	62,812.85 x 0.25 = 15,703.21

BEGIN PROJECT Sta. 10+96.35
 END PROJECT Sta. 364+28.58
 NET LENGTH OF PROJECT 35,332.23 Ft.
 AREA = 35,332.23 x 16' x 9 = 62,812.85 Sq. Yds.

NOTE: The quantities shown on this plan are the estimated quantities necessary to complete the project. The exact proportions will be determined by the Laboratory. The contractor shall submit samples of all materials to be used to the Department prior to the starting of the work.