

Detail of Anchor to be used for Guard Rail Abutting Bridge

Guard Rail Type "D"  
Sta 530+81 to Sta 531+69 Build 88 Lin. Ft. on Left  
Sta 531+68 to Sta 531+60 Build 32 Lin. Ft. on Right  
Sta 532+73 to Sta 534+57 Build 184 Lin. Ft. on Right  
Total 304 Lin. Ft.

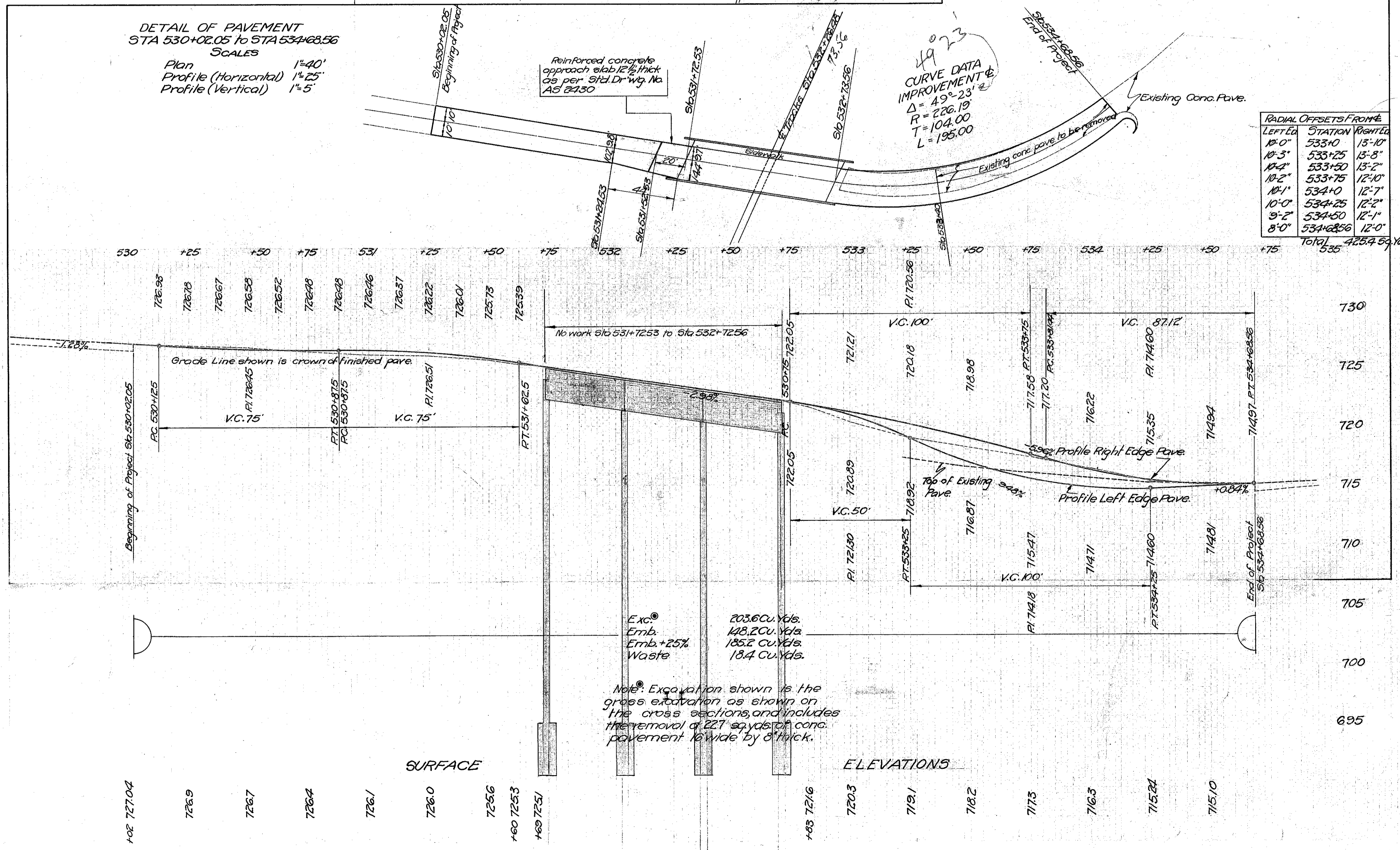
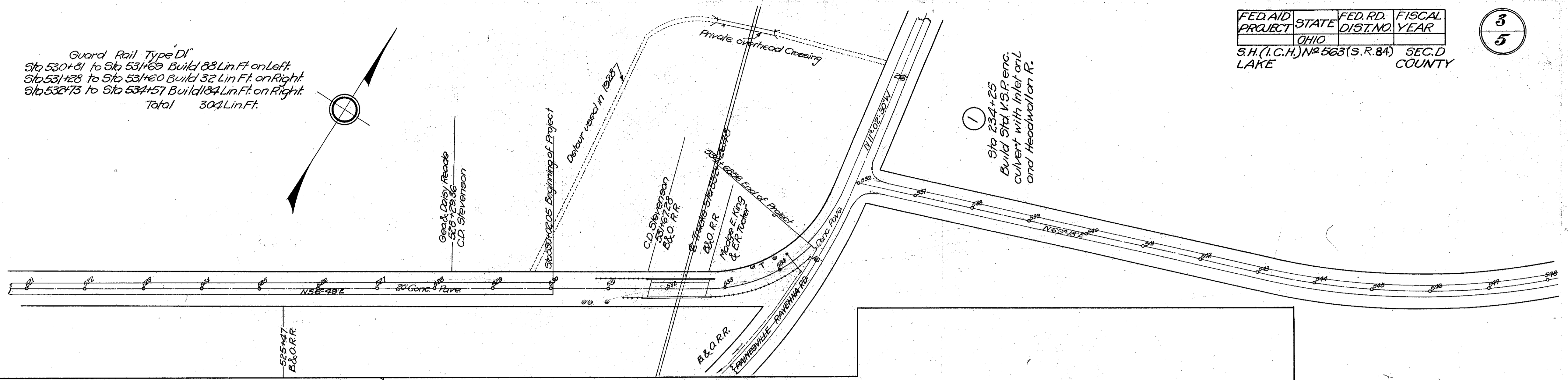

TOTAL QUANTITIES

Excavation (roadway)	204 Cu. Yds.
Guard Rail Type "D"	304 Lin. Ft.
Concrete Pave Type C (9'-7'-9")	823 Sq. Yds.
Reinforced Conc. App. Slab 12" thick	52 Sq. Yds.
Excavation (Culvert)	40 Cu. Yds.
12" V.S.P.	46 Lin. Ft.
1-8 Concrete	4.7 Cu. Yds.
1-5/8 Concrete	1.0 Cu. Yds.
Std. Slab Ditch Inlet Complete	1
Finishing shoulders, slopes and ditches (both sides)	366 Lin. Ft.
Dowels drilled and grouted in	9

Finishing shoulders, slopes and ditches (both sides) 366 Lin. Ft. Dowels drilled and grouted in 9