

SEE SHEET NO. 34

CALC. BY CCH  
DATE 4/5/80  
CHKD. BY BOB  
DATE 4/12/80

LAK 84 - 17.20

OHIO  
FHWA  
REGION

42  
53

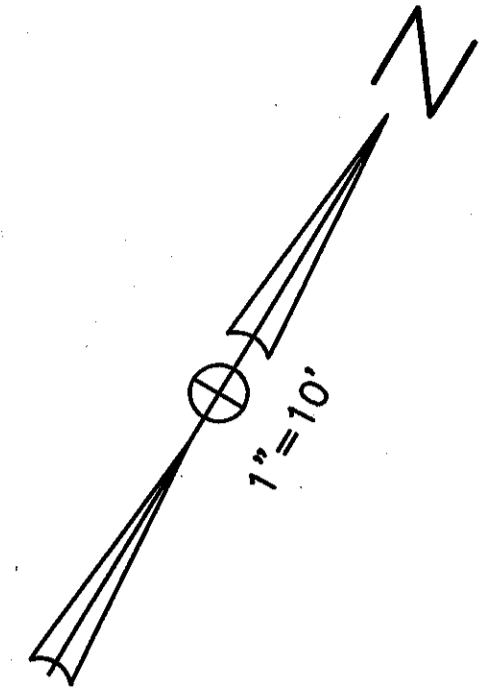
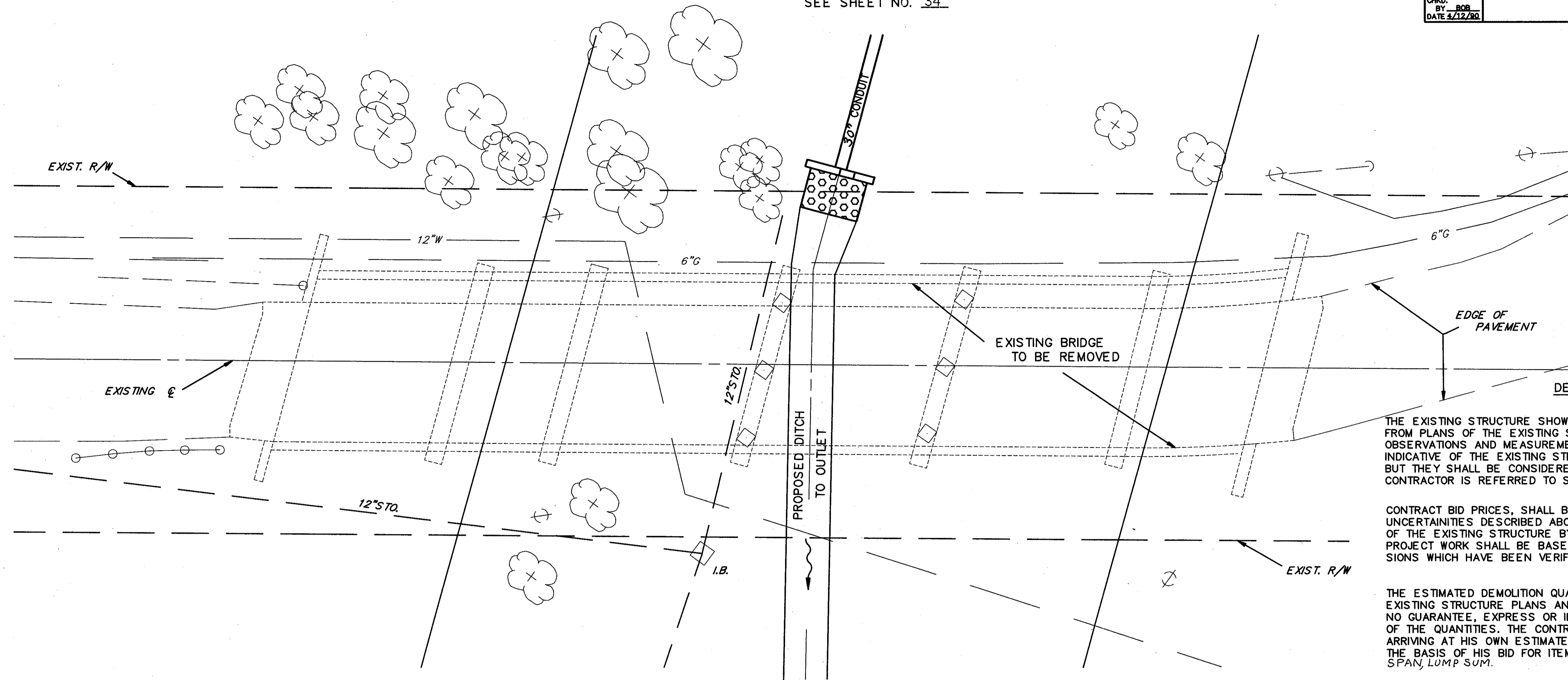

THE EXISTING STRUCTURE SHOWN ON THIS SHEET HAS BEEN PLOTTED FROM PLANS OF THE EXISTING STRUCTURE AND/OR FROM FIELD OBSERVATIONS AND MEASUREMENTS. CONSEQUENTLY, THEY ARE INDICATIVE OF THE EXISTING STRUCTURE AND THE PROPOSED WORK, BUT THEY SHALL BE CONSIDERED TENTATIVE AND APPROXIMATE. THE CONTRACTOR IS REFERRED TO SECTION 102.05 AND 105.02.

CONTRACT BID PRICES, SHALL BE BASED UPON A RECOGNITION OF THE UNCERTAINTIES DESCRIBED ABOVE AND UPON A PREBID EXAMINATION OF THE EXISTING STRUCTURE BY THE CONTRACTOR. HOWEVER, ALL PROJECT WORK SHALL BE BASED UPON ACTUAL DETAILS AND DIMENSIONS WHICH HAVE BEEN VERIFIED BY THE CONTRACTOR IN THE FIELD.

THE ESTIMATED DEMOLITION QUANTITIES HAVE BEEN ARRIVED AT USING EXISTING STRUCTURE PLANS AND ARE GIVEN FOR INFORMATION ONLY. NO GUARANTEE, EXPRESS OR IMPLIED, CAN BE GIVEN FOR ACCURACY OF THE QUANTITIES. THE CONTRACTOR SHALL BE RESPONSIBLE FOR ARRIVING AT HIS OWN ESTIMATED DEMOLITION QUANTITIES AS PART OF THE BASIS OF HIS BID FOR ITEM 202, STRUCTURE REMOVED OVER 20' SPAN, LUMP SUM.

THE FOLLOWING ESTIMATED DEMOLITION QUANTITIES DO NOT NECESSARILY LIST ALL ITEMS OF DEMOLITION WORK:

DESCRIPTION	QUANTITY	UNIT
SUPERSTRUCTURE CONCRETE	338	C.Y.
SUBSTRUCTURE CONCRETE	1,226 *	C.Y.
STRUCTURAL STEEL	111,000 *	LBS.

THE ABOVE LISTED QUANTITIES ARE FOR INFORMATIONAL PURPOSES ONLY

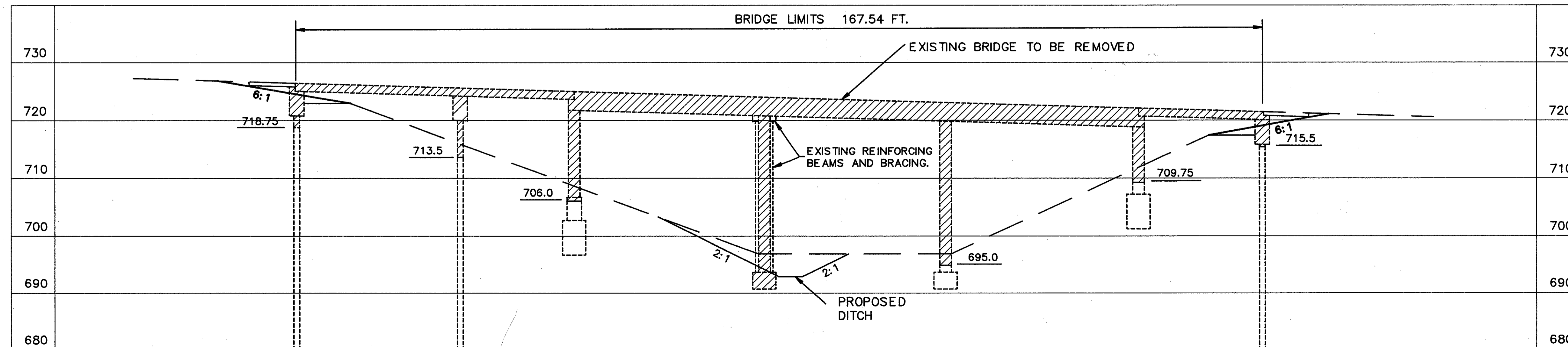

\* INCLUDES ADDED REINFORCING BEAMS AND BRACING.

DEMOLITION PLAN

STATE ROUTE 84