

SEE SHEET 178 FOR CLARK STREET EXTRA AREA
 SEE SHEETS 141, 183 FOR CATCH BASIN CROSS-OVERS
 SEE SHEET 202 FOR WATER WORK QUANTITIES
 SEE SHEET 60 FOR STORM CONNECTIONS
 SEE SHEET 61 FOR DRIVE QUANTITIES
 SEE SHEET 96 FOR ESTIMATED DRAINAGE QUANTITIES
 SEE SHEET 202 FOR UTILITY RELOCATION

LEGEND

- W --- EX. WATER LINE
- SAN --- EX. SANITARY LINE
- G --- EX. GAS LINE
- S --- EX. STORM LINE
- T --- EX. TELEPHONE LINE

BENCH MARK: ELEV. 198.660
 STA. 5+259.17, OFFSET 7.26 m LT.
 HYDRANT
 TOP STEM

(*) 707.41 NON-PERFORATED,
 ASTM D-3034 SDR 35,
 707.33 OR 707.42

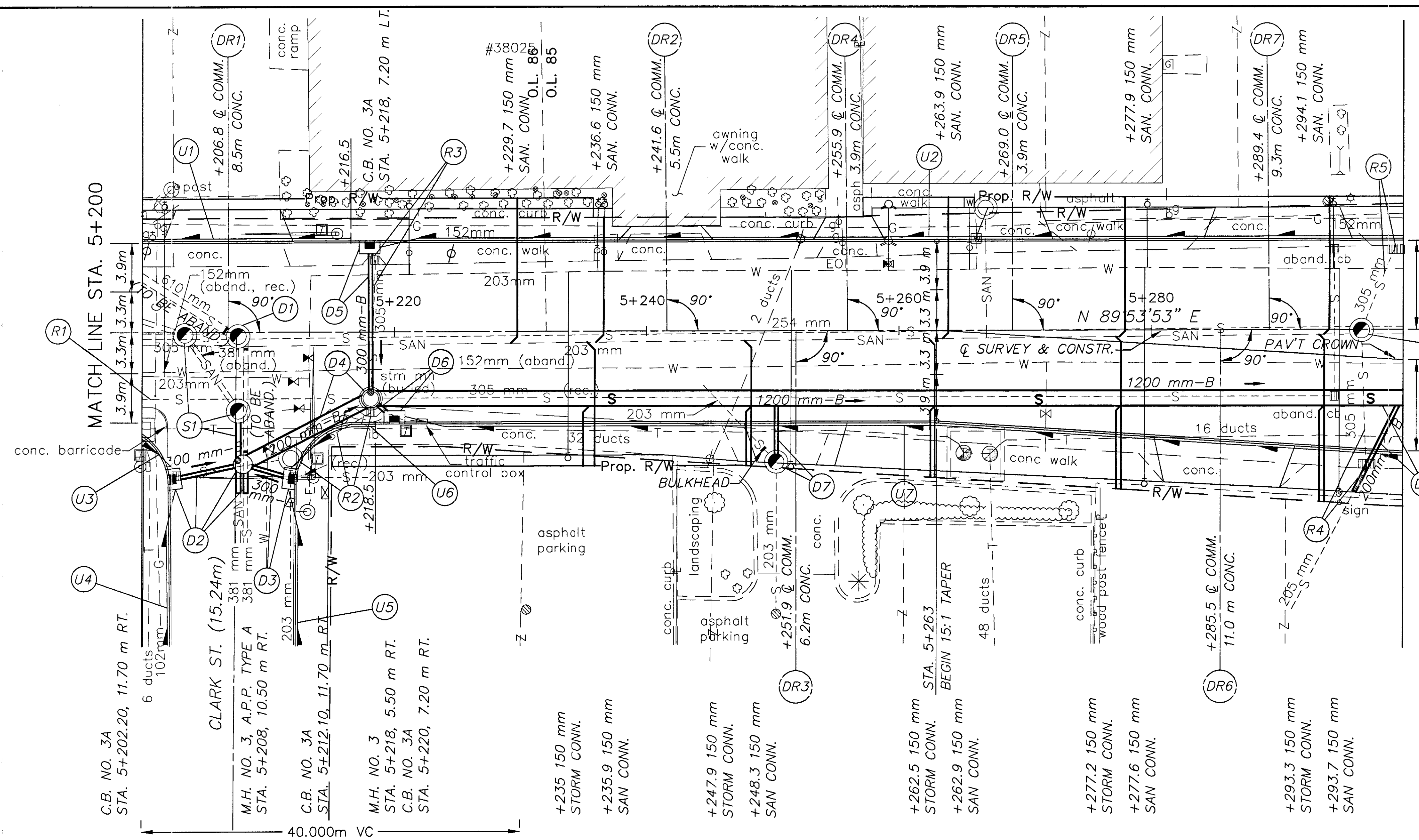

UNDERDRAINS						
REFERENCE NUMBER	STATION		SIDE	603	605	BENDS AND BRANCHES FOR INFORMATION ONLY 150 mm X 45°
	FROM	TO		150 mm CONDUIT, TYPE F (*)	150 mm SHALLOW PIPE UNDERDRAIN WITH FABRIC WRAP	
	ELEV.	ELEV.		METER	METER	
U1	5+200	5+216.5	L		16.5	
	195.92	196.14				
U2	5+218	5+300	L	3	79	1
	196.15	196.82				
U3	5+200	5+202	R	3	1	1
	195.92	195.90				
U4	5+202	5+202	R	3	20.3	1
	195.90	196.58				
U5	5+212	5+212	R	3	20.3	1
	195.90	196.58				
U6	5+212	5+218.5	R	3	5.8	1
	195.90	196.17				
U7	5+220	5+300	R	3	77	1
	196.21	196.77				
TOTALS CARRIED TO SHEET 96				18	219.9	6

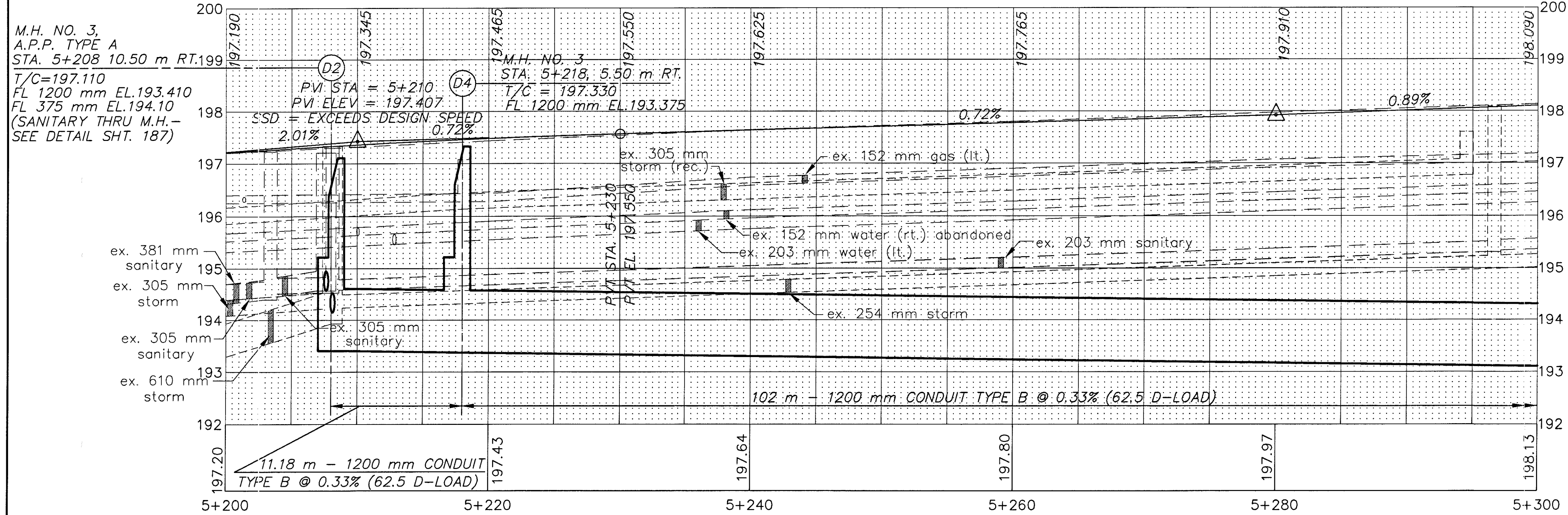

PLAN AND PROFILE SHEET
 STA. 5+200 TO STA. 5+300 S.R. 640
 LAK-640-3.444