

TEMPORARY RAMP DETAIL
RAMP #11 CLOSED
POSTED SPEED FOR RAMPS
(20 MPH)

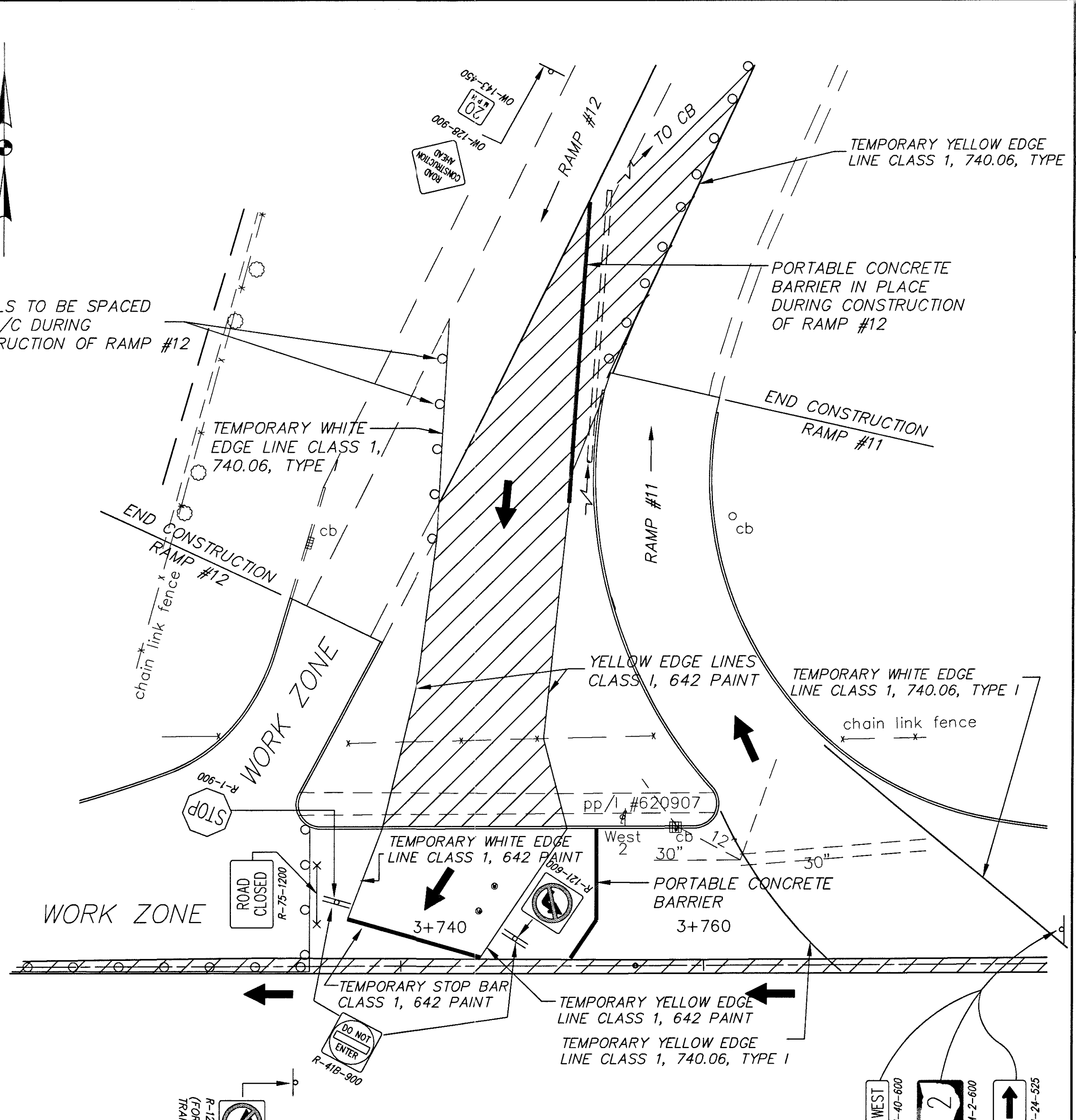

TEMPORARY RAMP DETAIL
RAMP #12 CLOSED
POSTED SPEED FOR RAMPS
(20 MPH)

NOTES FOR TEMPORARY RAMP CONSTRUCTION
RAMPS 11 AND 12

- FENCE BETWEEN RAMPS TO BE REMOVED FOR CONSTRUCTION OF TEMPORARY RAMP AND REPLACED AT THE COMPLETION OF THE RAMP CONSTRUCTION.
- PORTIONS OF THE MEDIAN SHALL BE REMOVED AND REPLACED WITH THE TEMPORARY PAVEMENT TO ALLOW FOR ACCESS TO RAMPS.
- RAMP #11 TO BE CONSTRUCTED FIRST.
- YELLOW EDGE LINES TO BE PAINTED ALONG BOTH SIDES OF TEMPORARY RAMP.
- 18 m CONDUIT TO BE INSTALLED FOR TEMPORARY DRAINAGE BETWEEN RAMPS.
QUANTITY CARRIED TO SHEET NO. 62
- BARRELS TO BE 3 m APART ON ALL TAPERS.

LEGEND

TEMPORARY PAVEMENT