

CALC. BY:
CHECKED BY:

MAINTENANCE OF TRAFFIC
SECTION 3 - PHASE 1

LAK-640-3.444

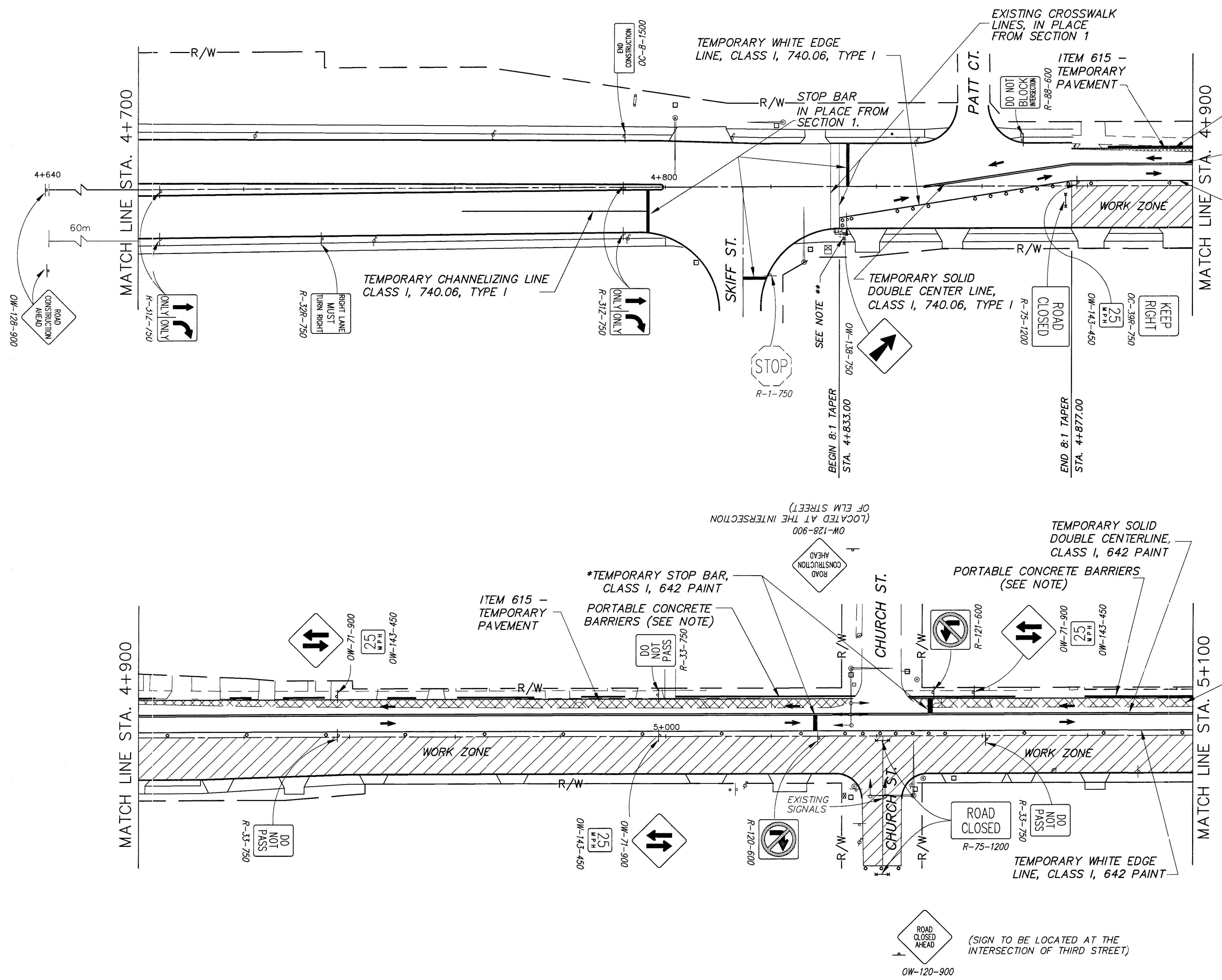

- NOTES:
- BARRELS SHALL BE SPACED OUT ALONG ROADWAY AT 15m ON CENTER EXCEPT FOR TAPERS AND CLOSED INTERSECTIONS, WHERE THE BARRELS SHALL BE SPACED AT 3m ON CENTER. BARRELS SHALL NOT PROHIBIT ACCESS TO ANY INTERSECTION OR DRIVEWAY NOT UNDER CONSTRUCTION.
 - EXISTING CONFLICTING SIGNS, SIGNALS AND PAVEMENT MARKING ON VINE STREET SHALL BE COVERED (SIGNS AND SIGNALS) OR REMOVED (PAVEMENT MARKINGS).
 - ALL INTERSECTIONS THAT ARE CLOSED DUE TO CONSTRUCTION SHALL HAVE EMERGENCY ACCESS MAINTAINED.
 - PORTABLE CONCRETE BARRIERS ARE TO HAVE AN OPENING FOR EACH DRIVEWAY. THE WIDTH OF EACH OPENING SHALL MEASURE FROM 2 METERS WEST OF THE EDGE OF THE DRIVE TO 2 METERS EAST OF THE EDGE OF THE DRIVE. CONCRETE BARRIERS SHALL BE ANGLED AT 15° AT ENDS WHICH FACE TRAFFIC
 - ** CONTRACTOR SHALL ERECT A BARRICADE ACROSS THE SIDEWALK WITH A SIGN INDICATING THE SIDEWALK IS CLOSED AND TO CROSS IN THE CROSSWALK.

