

SEE SHEET 180 FOR ERIE STREET EXTRA AREA  
 SEE SHEET 144 FOR CATCH BASIN CROSS-OVERS  
 SEE SHEET 203 FOR WATER WORK QUANTITIES  
 SEE SHEET 60 FOR STORM CONNECTIONS  
 SEE SHEET 61 FOR DRIVE QUANTITIES  
 SEE SHEET 96 FOR ESTIMATED DRAINAGE QUANTITIES  
 SEE SHEET 203 FOR UTILITY RELOCATION

**LEGEND**

- W --- EX. WATER LINE
- SAN --- EX. SANITARY LINE
- G --- EX. GAS LINE
- S --- EX. STORM LINE
- T --- EX. TELEPHONE LINE

NEW CONCRETE PAVEMENT WITH ASPHALT OVERLAY

BENCH MARK: ELEV. 199.263  
 STA. 5+323.35, OFFSET 7.88 m LT.  
 HYDRANT TOP STEM

(\*) 707.41 NON-PERFORATED,  
 ASTM D-3034 SDR 35,  
 707.33 OR 707.42

**UNDERDRAINS**

| REFERENCE NUMBER                  | STATION |         | SIDE | 603                        |   | 605          |  | BENDS AND BRANCHES FOR INFORMATION ONLY |
|-----------------------------------|---------|---------|------|----------------------------|---|--------------|--|---|
|                                   | FROM    | TO      |      | 150 mm CONDUIT, TYPE F (*) | 150 mm SHALLOW PIPE UNDERDRAIN WITH FABRIC WRAP | 150 mm x 45' |  |   |
|                                   | E ELEV. | E ELEV. |      | METER                      | METER   | EACH         |  |   |
| U1                                | 5+300   | 5+316.5 | L    |                            | 16.5  |              |  |   |
|                                   | 196.82  | 196.880 |      |                            |   |              |  |   |
| U2                                | 5+318   | 5+378   | L    | 3                          | 63.8  | 1            |  |   |
|                                   | 196.96  |         |      |                            |   |              |  |   |
| U3                                | 5+300   | 5+315.0 | R    |                            | 15.0  |              |  |   |
|                                   | 196.77  | 196.925 |      |                            |   |              |  |   |
| U4                                | 5+316.5 | 5+375.5 | R    | 3                          | 64.8  | 1            |  |   |
|                                   | 196.94  |         |      |                            |   |              |  |   |
| <b>TOTALS CARRIED TO SHEET 96</b> |         |         |      | 6                          | 160.1   | 2            |  |   |

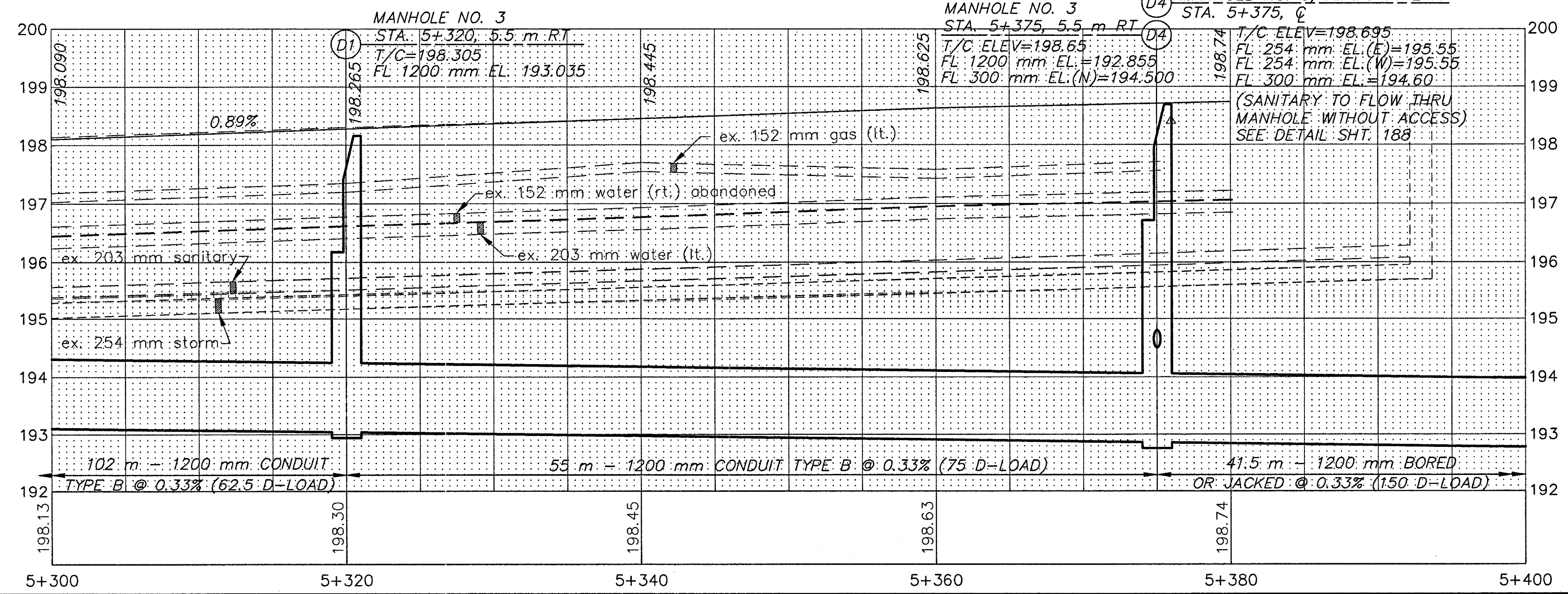
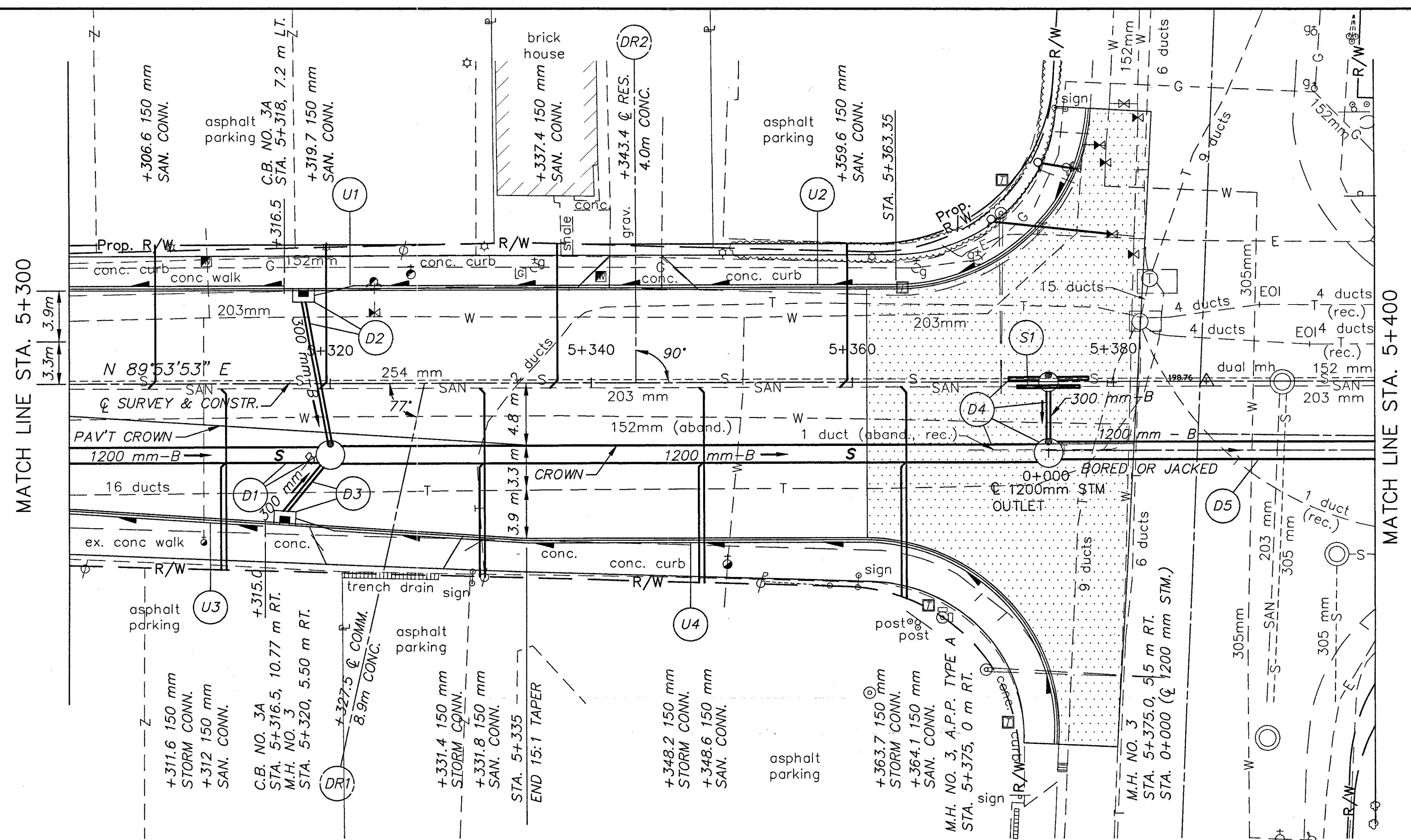

PLAN AND PROFILE SHEET  
 STA. 5+300 TO 5+400 S.R. 640  
 LAK-640-3.444  
 95  
 214