

STORM WATER POLLUTION PREVENTION PLAN
STA. 4+880 TO STA. 5+400

LAK-640-3.444

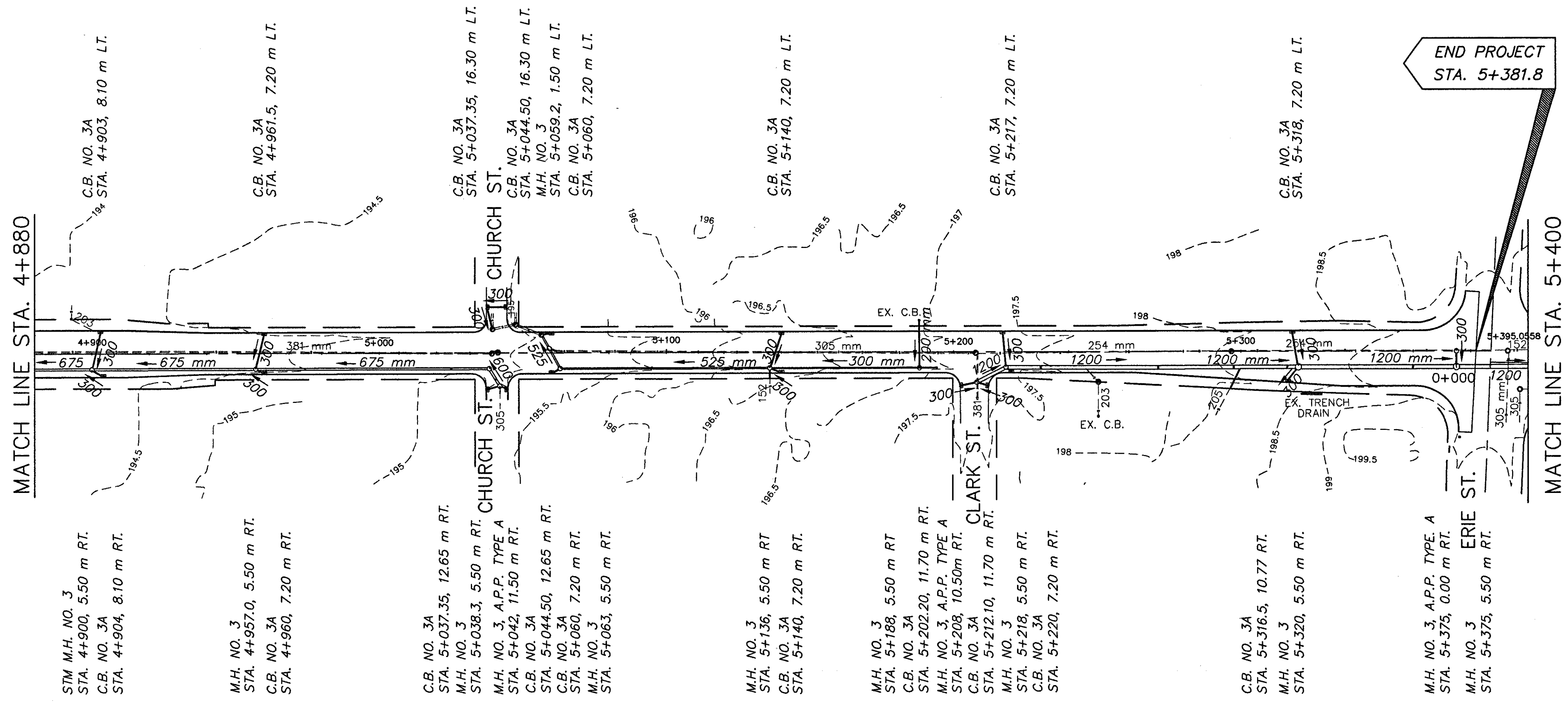

PROJECT DESCRIPTION

THIS PROJECT CONSIST OF TOTAL REPLACEMENT OF APPROXIMATELY 1.90 KILOMETERS OF FOUR LANE DIVIDED AND UNDIVIDED, URBAN ARTERIAL ROADWAY, SITUATED IN THE CITY OF WILLOUGHBY. THE PROJECT HAS AN EAST-WEST ORIENTATION STARTING APPROXIMATELY AT EAST 364th ST. AND ENDING AT STATE ROUTE 20, ERIE ST. .

USGS QUADRANT NO. 41081-F4
EASTLAKE, OHIO
LONGITUDE: 81°25'05"
LATITUDE: 41°38'33"

* LONGITUDE AND LATITUDE TO APPROX. CENTER OF PROJECT

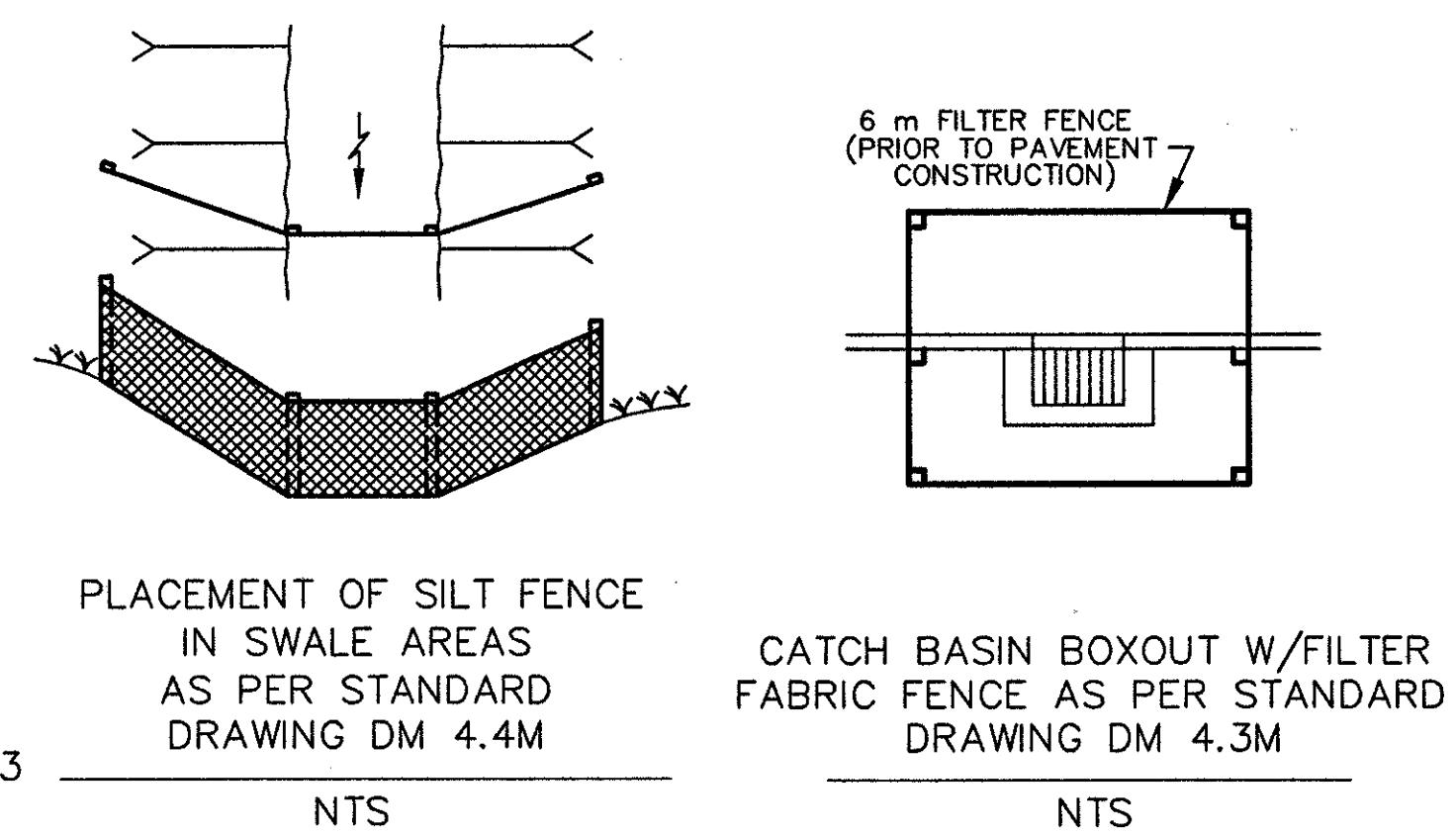

- LEGEND**
- ▨ CONCRETE SLOPE PROTECTION
 - ▣ CATCH BASIN (6 METERS SILT FENCE), CB-3A, 6
 - ▣ CATCH BASIN (8 METERS SILT FENCE), CB-3
 - ▣ CATCH BASIN (6 METERS SILT FENCE), CB 2-2B,2-3
 - MANHOLE
 - MANHOLE, ADJUSTED TO GRADE
 - ◻ EXISTING CATCH BASIN
 - ✂ FILTER FABRIC FENCE (4 METERS SILT FENCE PER CROSSING)
 - SWALE FLOW

PROJECT DATA	
TOTAL AREA (RIGHT-OF-WAY)	= 23.5 AC.
AREA TO UNDERGO EXCAVATION, FILLING, OR GRADING	= 16.7 AC.
RUNOFF COEFFICIENT FOR PRE-CONSTRUCTION SITE	= .79
RUNOFF COEFFICIENT FOR POST CONSTRUCTION SITE	= .79
SOIL DATA	SEE SOIL PROFILES
IMMEDIATE RECEIVING WATERS	CHAGRIN RIVER

ESTIMATED QUANTITIES					
ITEM NO.		877	877	870	870
LOCATION	SIDE				
	TEMPORARY PERIMETER FILTER FABRIC FENCE	METERS	METERS	SQ. M.	KG
CATCH BASIN NO. 3A	L&R	0	108	0	0
TOTAL CARRIED TO SHEET 67		0	108	0	0