

HORIZONTAL SCALE IN METERS

CALC. BY: CHECKED BY:

INTERSECTION DETAIL S. R. 91

LAK - 640 - 2.865 (1.78)

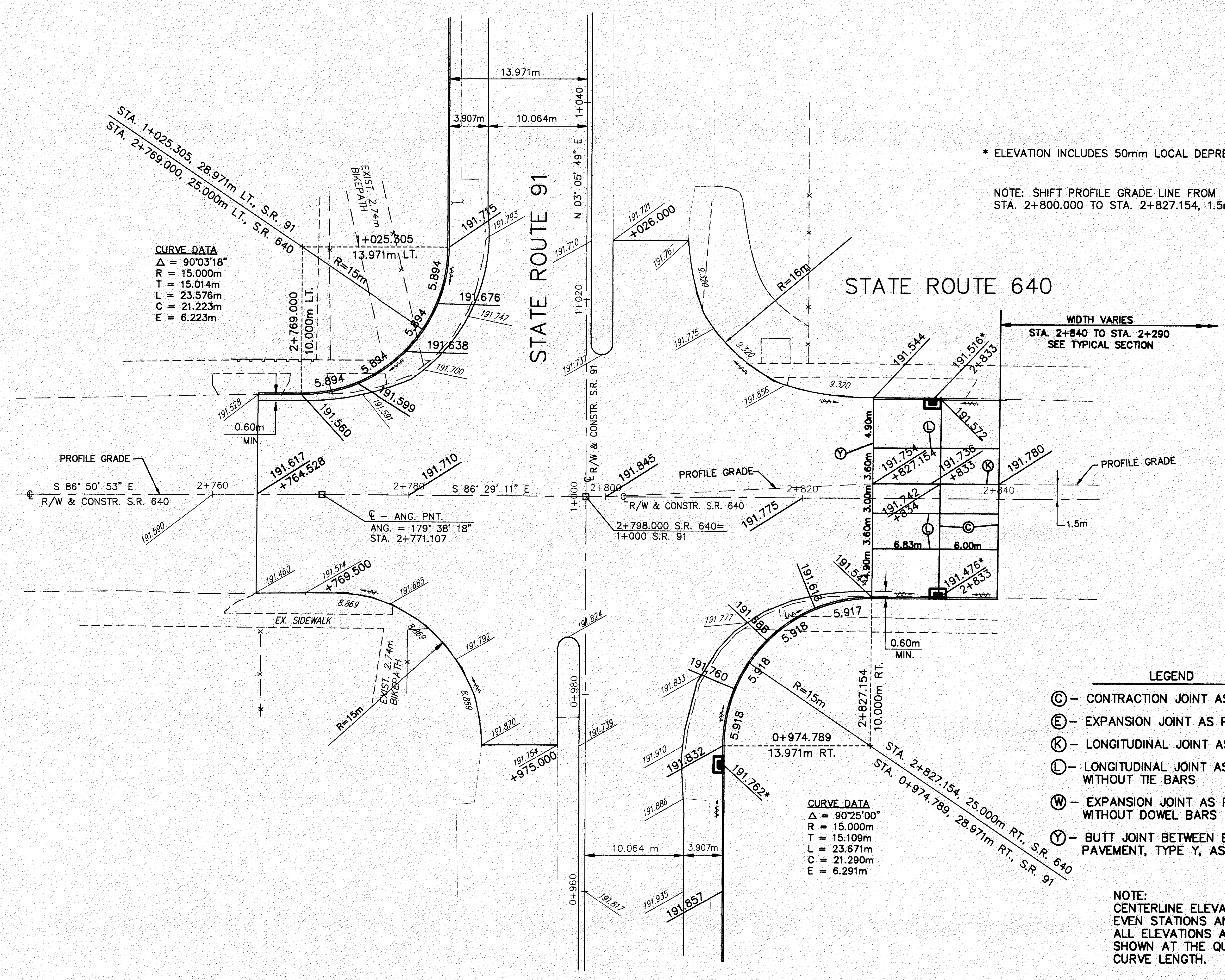

\* ELEVATION INCLUDES 50mm LOCAL DEPRESSION

NOTE: SHIFT PROFILE GRADE LINE FROM STA. 2+800.000 TO STA. 2+827.154, 1.5m LT.

WIDTH VARIES  
STA. 2+840 TO STA. 2+290  
SEE TYPICAL SECTION

**CURVE DATA**  
 $\Delta = 90^{\circ}03'18''$   
 $R = 15.000m$   
 $T = 15.014m$   
 $L = 23.576m$   
 $C = 21.223m$   
 $E = 6.223m$

**LEGEND**

- (C) - CONTRACTION JOINT AS PER BP-2.1M
- (E) - EXPANSION JOINT AS PER BP-2.2M
- (K) - LONGITUDINAL JOINT AS PER BP-2.1M
- (L) - LONGITUDINAL JOINT AS PER BP-2.1M WITHOUT TIE BARS
- (W) - EXPANSION JOINT AS PER BP-2.2M WITHOUT DOWEL BARS
- (Y) - BUTT JOINT BETWEEN EXISTING AND PROPOSED PAVEMENT, TYPE Y, AS PER PLAN BP-2.5M

NOTE: CENTERLINE ELEVATIONS ARE SHOWN AT EVEN STATIONS AND AT 20 m INCREMENTS. ALL ELEVATIONS ALONG THE TURNOUT ARE SHOWN AT THE QUARTER POINTS OF THE CURVE LENGTH.

EDGE OF PAVEMENT ELEVATIONS AND RADII ARE TO THE BOTTOM FACE OF CURB.

H: /1998/98208/DWG/98028IN1.DWG