

MAINTENANCE OF TRAFFIC MISCELLANEOUS DETAILS

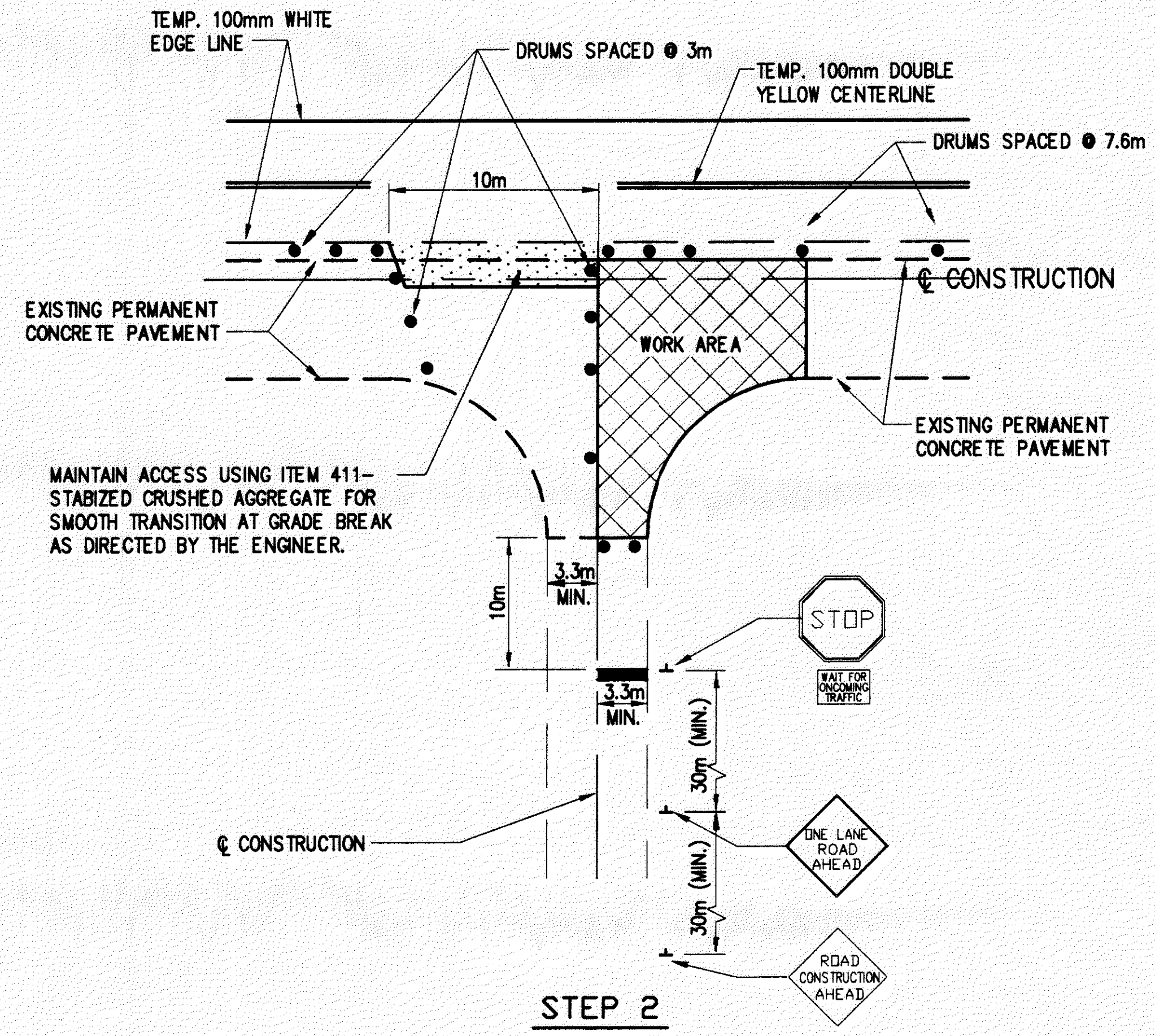
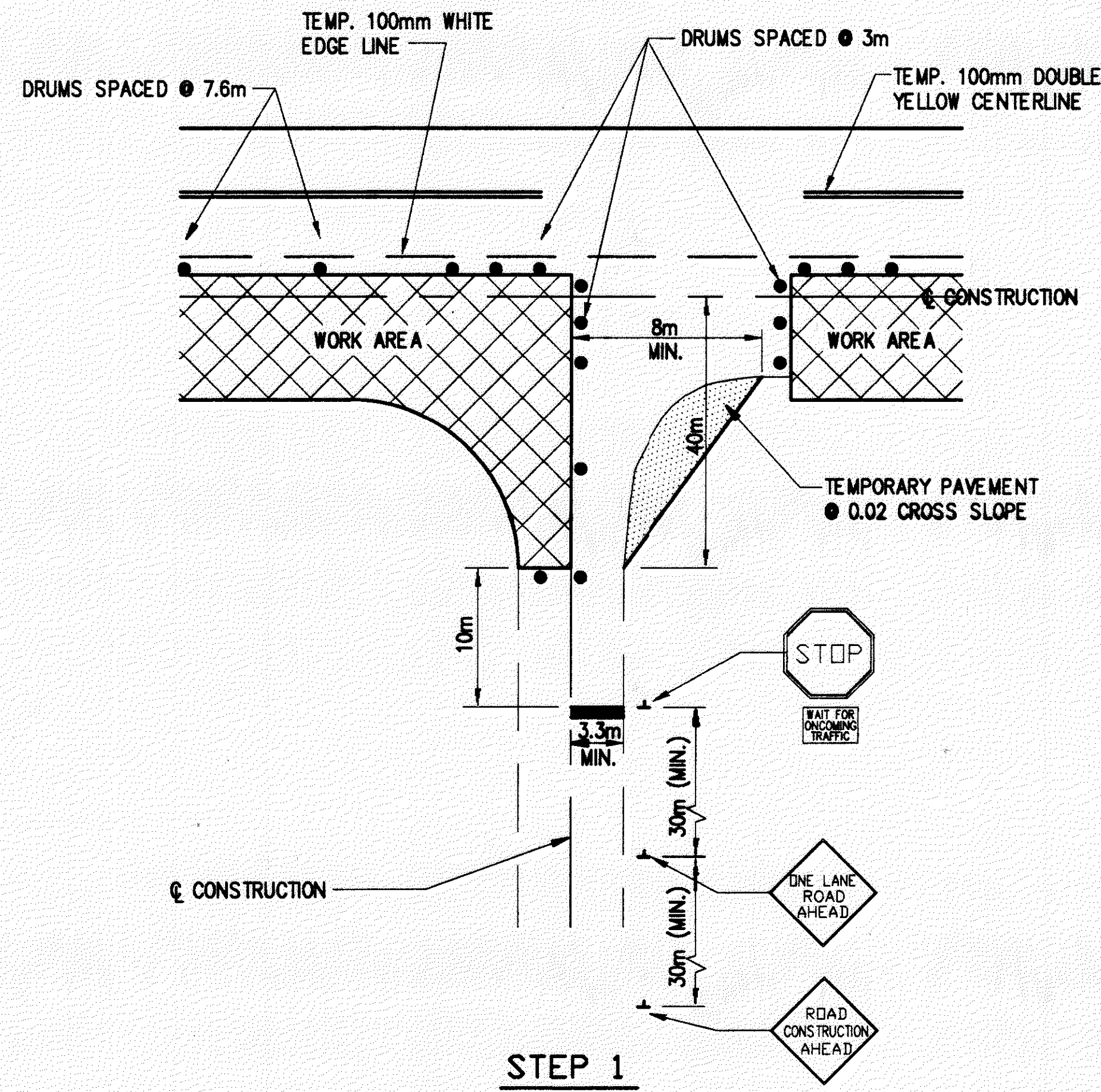

REDUCTION TO ONE LANE SIDE STREET ACCESS

TRAFFIC TO BE MAINTAINED ON THE FOLLOWING SIDE OF THE ROADWAY USING TEMPORARY PAVEMENT DURING STEP 1 OF INTERSECTION CONSTRUCTION	
SIDESTREET:	SIDE OF ROADWAY:
E. 355 TH STREET	EAST SIDE
E. 357 TH STREET	EAST SIDE
E. 359 TH STREET	EAST SIDE
E. 360 TH STREET	EAST SIDE
E. 362 ND STREET	WEST SIDE
E. 363 RD STREET	WEST SIDE

NOTES:

NO TEMPORARY PAVEMENT REQUIRED AT E. 357 TH. STREET

ALL OTHER INTERSECTIONS TO BE CLOSED DURING FULL DEPTH PAVEMENT REPLACEMENT.

PLEASE REFER TO SIDE STREET CROSS SECTIONS FOR APPROXIMATE LIMITS OF TEMPORARY PAVEMENT AND GRADING.

H:\1998\98208\DWG\MOT_TRAF\14199GI.DWG (PLOT1)

CALC. BY:
A.E.P.
CHECKED BY:
I.M.H.

MAINTENANCE OF TRAFFIC
MISCELLANEOUS DETAILS

LAK-640-2.865 (178)