

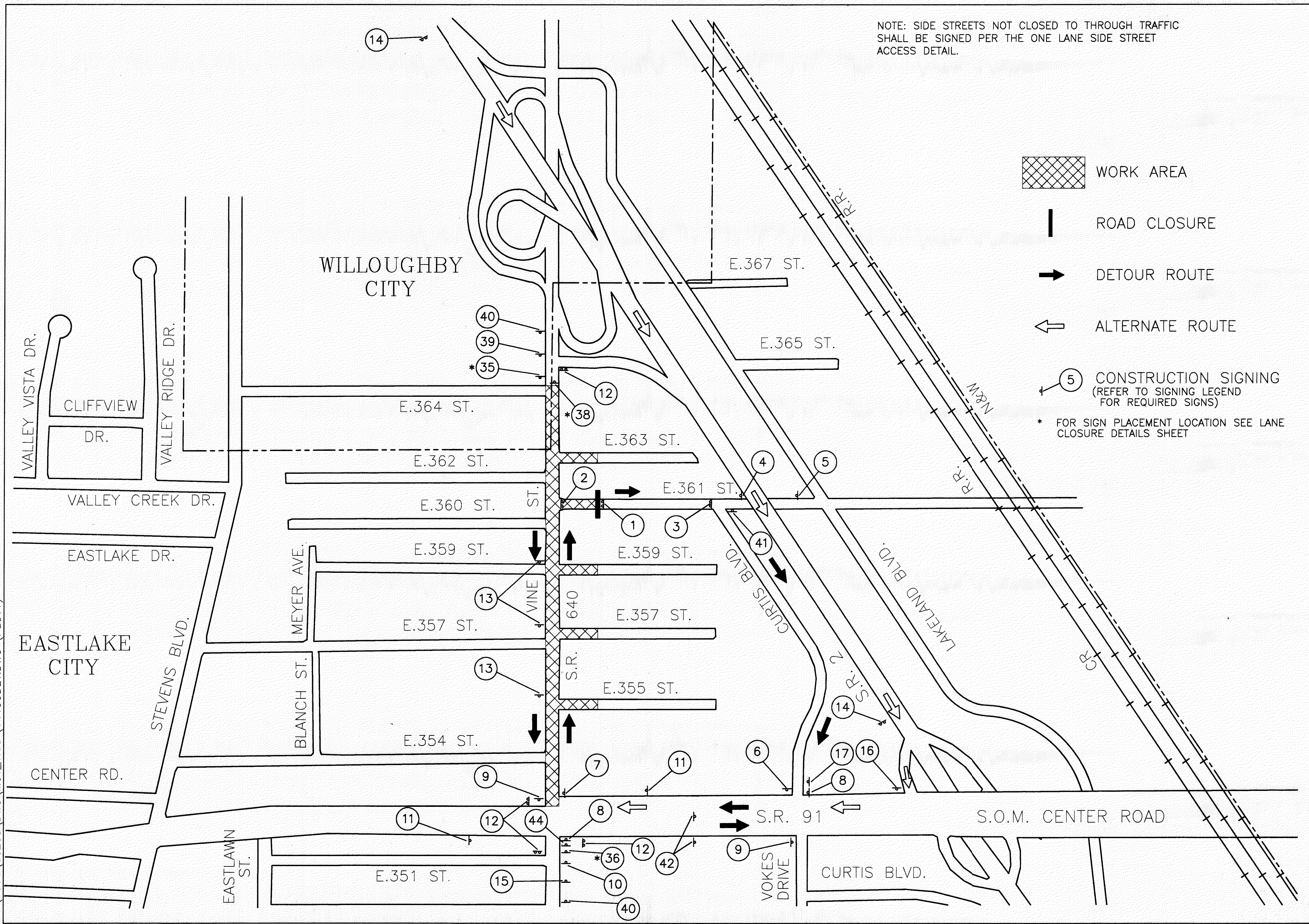

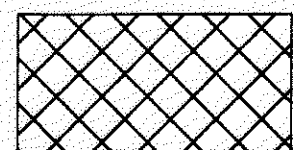

H:\1998\98208\DWG\MOT_TRAF\14199DET.DWG (PLOT1)

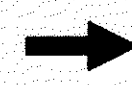
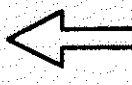

NOTE: SIDE STREETS NOT CLOSED TO THROUGH TRAFFIC SHALL BE SIGNED PER THE ONE LANE SIDE STREET ACCESS DETAIL.

-  WORK AREA
-  ROAD CLOSURE
-  DETOUR ROUTE
-  ALTERNATE ROUTE
-  5 CONSTRUCTION SIGNING (REFER TO SIGNING LEGEND FOR REQUIRED SIGNS)
- * FOR SIGN PLACEMENT LOCATION SEE LANE CLOSURE DETAILS SHEET