

HORIZONTAL SCALE IN METERS

CALC. BY:
CHECKED BY:

INTERSECTION DETAIL E. 357th ST. (NORTH + SOUTH)

LAK - 640 - 2.865 (1.78)

125
189

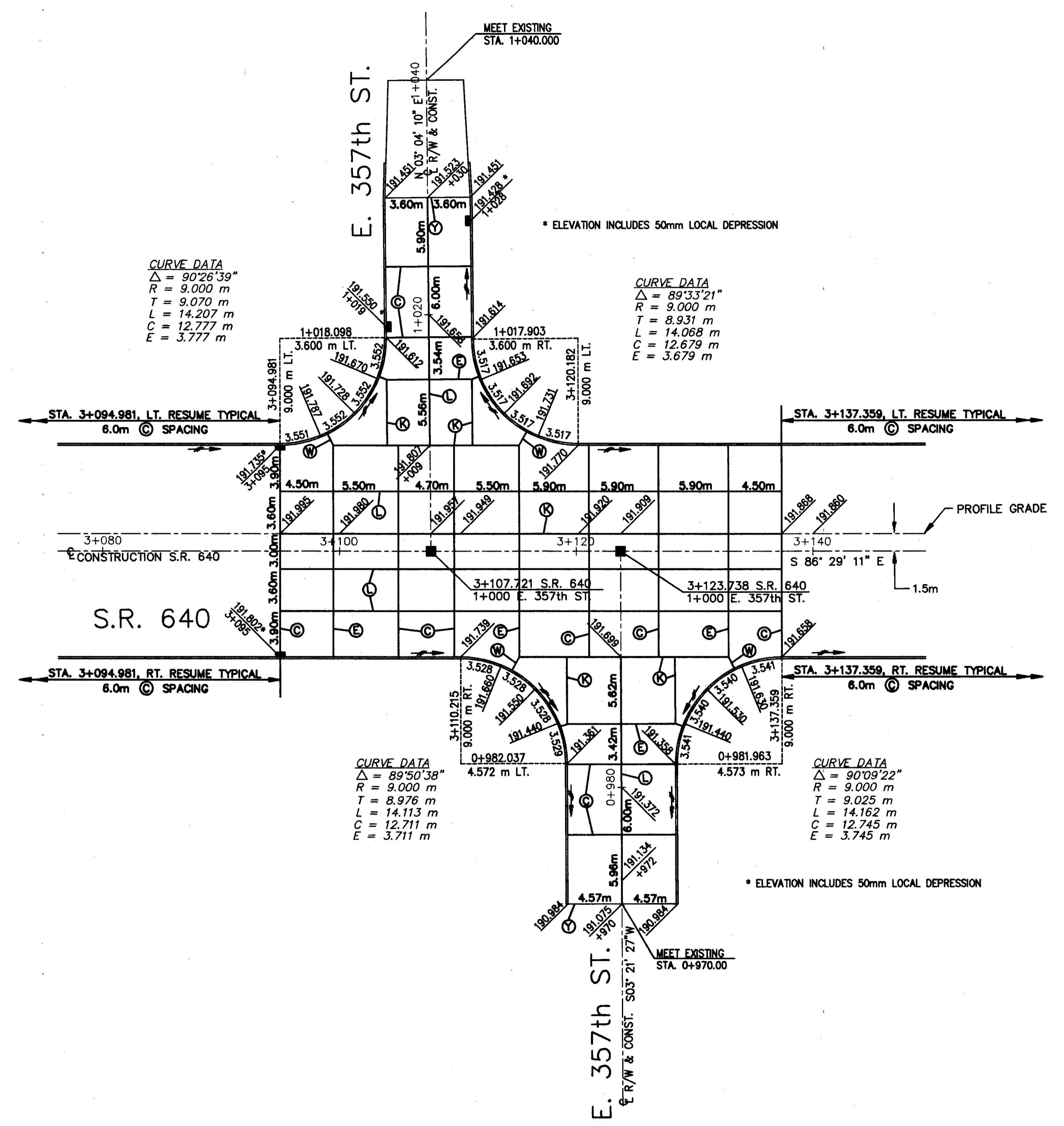

CURVE DATA
 $\Delta = 90^\circ 26' 39''$
 $R = 9.000\text{ m}$
 $T = 9.070\text{ m}$
 $L = 14.207\text{ m}$
 $C = 12.777\text{ m}$
 $E = 3.777\text{ m}$

CURVE DATA
 $\Delta = 89^\circ 33' 21''$
 $R = 9.000\text{ m}$
 $T = 8.931\text{ m}$
 $L = 14.068\text{ m}$
 $C = 12.679\text{ m}$
 $E = 3.679\text{ m}$

CURVE DATA
 $\Delta = 89^\circ 50' 38''$
 $R = 9.000\text{ m}$
 $T = 8.976\text{ m}$
 $L = 14.113\text{ m}$
 $C = 12.711\text{ m}$
 $E = 3.711\text{ m}$

CURVE DATA
 $\Delta = 90^\circ 09' 22''$
 $R = 9.000\text{ m}$
 $T = 9.025\text{ m}$
 $L = 14.162\text{ m}$
 $C = 12.745\text{ m}$
 $E = 3.745\text{ m}$

* ELEVATION INCLUDES 50mm LOCAL DEPRESSION

* ELEVATION INCLUDES 50mm LOCAL DEPRESSION

LEGEND

- ⊙ - CONTRACTION JOINT AS PER BP-2.1M
- ⊕ - EXPANSION JOINT AS PER BP-2.2M
- Ⓚ - LONGITUDINAL JOINT AS PER BP-2.1M
- Ⓛ - LONGITUDINAL JOINT AS PER BP-2.1M WITHOUT TIE BARS
- Ⓜ - EXPANSION JOINT AS PER BP-2.2M WITHOUT DOWEL BARS
- Ⓨ - BUTT JOINT BETWEEN EXISTING AND PROPOSED PAVEMENT, TYPE Y, AS PER PLAN BP-2.5M

NOTE:
 ALL ELEVATIONS ALONG THE TURNOUT ARE SHOWN AT THE QUARTER POINTS OF THE CURVE LENGTH.

EDGE OF PAVEMENT ELEVATIONS AND RADII ARE TO THE BOTTOM FACE OF CURB.

DATE: 02-16-01 - TIME: 16:06 - H:\1898\98208\dwg\98028IN3.DWG