

HORIZONTAL SCALE IN METERS

CALC. BY: J.M.P.
CHECKED BY: W.D.B.

STORM WATER POLLUTION PREVENTION PLAN

LAK - 640 - 2865 (1.78)

ESTIMATED QUANTITIES				877		
STREET	STATION	SIDE	TEMPORARY INLET PROTECTION FILTER FABRIC FENCE METERS	TEMPORARY DITCH CHECK FILTER FABRIC FENCE METERS	TEMPORARY PERIMETER FILTER FABRIC FENCE METERS	
						FROM
AT ALL CATCH BASINS			639	40*	160*	
AT ALL DITCH CHECKS					120*	
S.R. 91	0+810.000	0+970.000	RT.			
S.R. 91	1+030.000	1+150.000	LT.			
TOTALS CARRIED TO DRAINAGE SUB-SUMMARY			639	40*	280*	

* 100% LOCAL PARTICIPATION

USGS QUADRANT NO. 41081-F4
EASTLAKE NORTHEAST OHIO
LONGITUDE: 81°25'30**
LATITUDE: 41°38'33**

** LONGITUDE AND LATITUDE TO APPROX. CENTER OF PROJECT.

LEGEND

- CATCH BASIN (9m EACH), CB-3, CB-3A, CB-2-2B
- STORM SEWER MANHOLE
- SEWER FLOW DIRECTION
- FF FILTER FABRIC FENCE

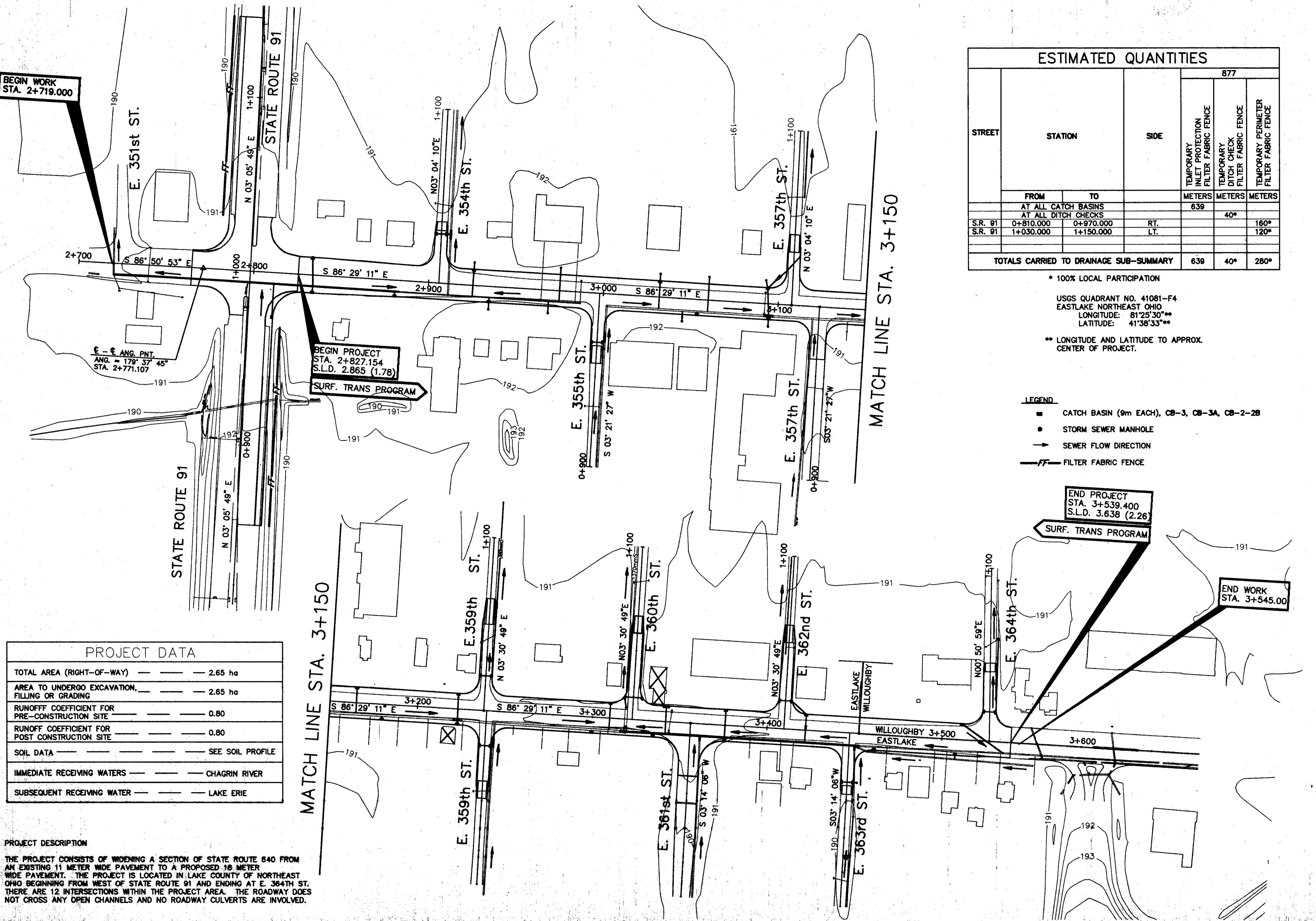

PROJECT DATA	
TOTAL AREA (RIGHT-OF-WAY)	2.65 ha
AREA TO UNDERGO EXCAVATION, FILLING OR GRADING	2.65 ha
RUNOFF COEFFICIENT FOR PRE-CONSTRUCTION SITE	0.80
RUNOFF COEFFICIENT FOR POST CONSTRUCTION SITE	0.80
SOIL DATA	SEE SOIL PROFILE
IMMEDIATE RECEIVING WATERS	CHAGRIN RIVER
SUBSEQUENT RECEIVING WATER	LAKE ERIE

PROJECT DESCRIPTION

THE PROJECT CONSISTS OF WIDENING A SECTION OF STATE ROUTE 640 FROM AN EXISTING 11 METER WIDE PAVEMENT TO A PROPOSED 18 METER WIDE PAVEMENT. THE PROJECT IS LOCATED IN LAKE COUNTY OF NORTHEAST OHIO BEGINNING FROM WEST OF STATE ROUTE 91 AND ENDING AT E. 364TH ST. THERE ARE 12 INTERSECTIONS WITHIN THE PROJECT AREA. THE ROADWAY DOES NOT CROSS ANY OPEN CHANNELS AND NO ROADWAY CULVERTS ARE INVOLVED.

H:\1998\98208\SDSK\SWPPP.DWG