

T.R. Lower Bracket of R.R. Crossing Sign, 20' R of Vine St. Sta. 149+60 Elev. 639.443

B.M. # 6 S.E. Cap Bolt of Fire Hydrant 21' R of Vine St. Sta. 153+04 Elev. 635.085

FED. RD. DIVISION	STATE	PROJECT	FISCAL YEAR
2	OHIO		

LAKE COUNTY  
SEC. LAK-640-2.56  
IN WILLOUGHBY

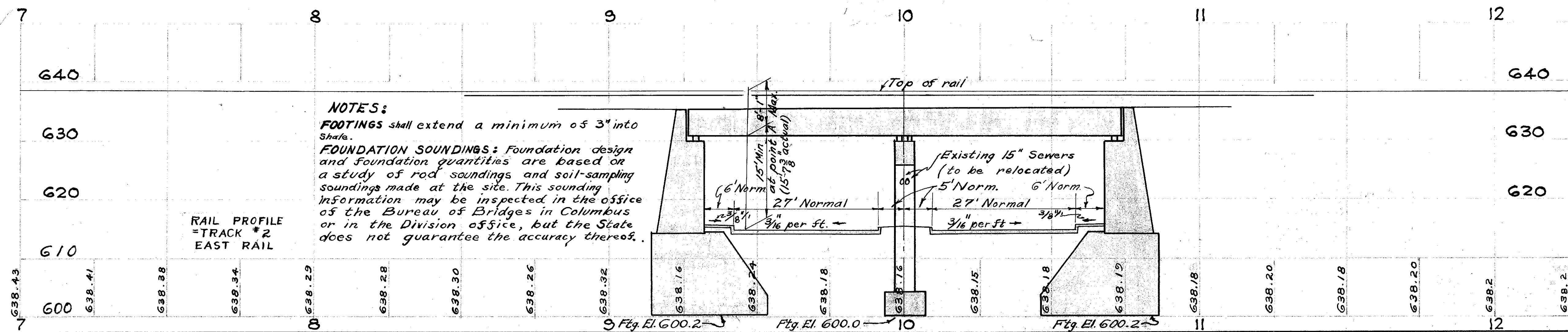
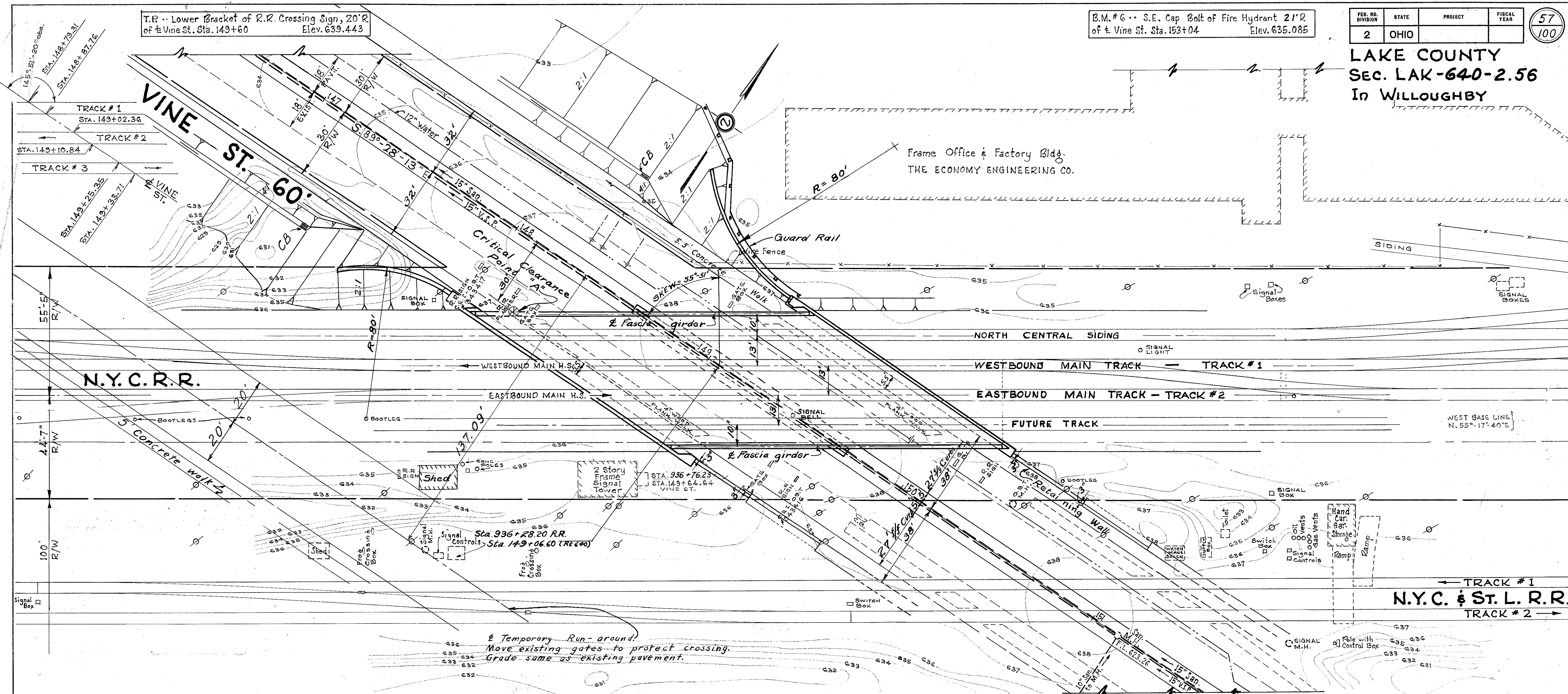

**NOTES:**  
 FOOTINGS shall extend a minimum of 3' into shale.  
 FOUNDATION SOUNDINGS: Foundation design and foundation quantities are based on a study of rod soundings and soil-sampling soundings made at the site. This sounding information may be inspected in the office of the Bureau of Bridges in Columbus or in the Division office, but the State does not guarantee the accuracy thereof.

**PROPOSED STRUCTURE**  
 TYPE: Steel Girder bridge with concrete substructure.  
 SPANS: 2 @ 36' clear (Normal to highway) or 2 @ 70'-4" % bearings (Normal to tracks)  
 WIDTH: 4 tracks 59' ± wide % (Normal to tracks)  
 CLEARANCE: 15'-0" Min. Vertical  
 LOADING: Cooper's E-72  
 SKEW: 55°-51'  
 ALIGNMENT: R.R. & Highway Tangent

STATE OF OHIO DEPARTMENT OF HIGHWAYS BUREAU OF BRIDGES			
<b>SITE PLAN</b>			
Bridge No LAK-640-0282			
N.Y.C. R.R. - VINE ST BRIDGE			
Scale 1" = 20'			
TOPOGRAPHY		PROPOSED WORK	
SURVEY DR. BY	DESIGN	DR. BY	CH'KD
	J.H.B.	J.H.B.	J.P.R.
			P.E.S.

N.Y.C.R.R. - VINE ST. BRIDGE SITE PLAN