

LAK-040-0.98  
LAK-283-383  
LAK-91-549

REF.	Location	025														010									
		Messenger Wire	5/16" W/ Accessories	Traffic Signal Heads	0" 3 Section, 1-Way	Traffic Signal Heads	0" 3 Section, 2-Way	Covering of Traffic Signal Heads	Cable Support Assembly	Signal Cable 5/8"	Power Cable	Service Cable	Conduit 1"	Trench	Weather Head and Conduit Riser, 2"	Pull Box	Loop Detector Wire	Loop Detector Lead-in Cable	Loop Detector Pavement Cutting	Semi-Actuated 2-Phase Controller	Loop Detector Amplifier	Ground Rod	Signal Strain Pole 7.8A, 2.4"x11"	Signal Strain Pole 3.8A, 2.5"x10"	Concrete for Signal Support Foundations
L.F.	EA.	EA.	EA.	EA.	L.F.	L.F.	L.F.	L.F.	L.F.	EA.	EA.	EA.	EA.	EA.	L.F.	L.F.	L.F.	EA.	EA.	EA.	EA.	EA.	EA.	C.Y.	
A	N. Corner									1	60	30	5												125*
B	W Side of Lake Shore																								125*
C	N. Side of Hillcrest																								
D	N. Corner																								
Span A to B		81	2	2	4																				
Span A to D																									
A to C																									
TOTALS		81	2	2	4																				250

\*Foundation Size  
2.5' Dia. u. 75' Min. Depth

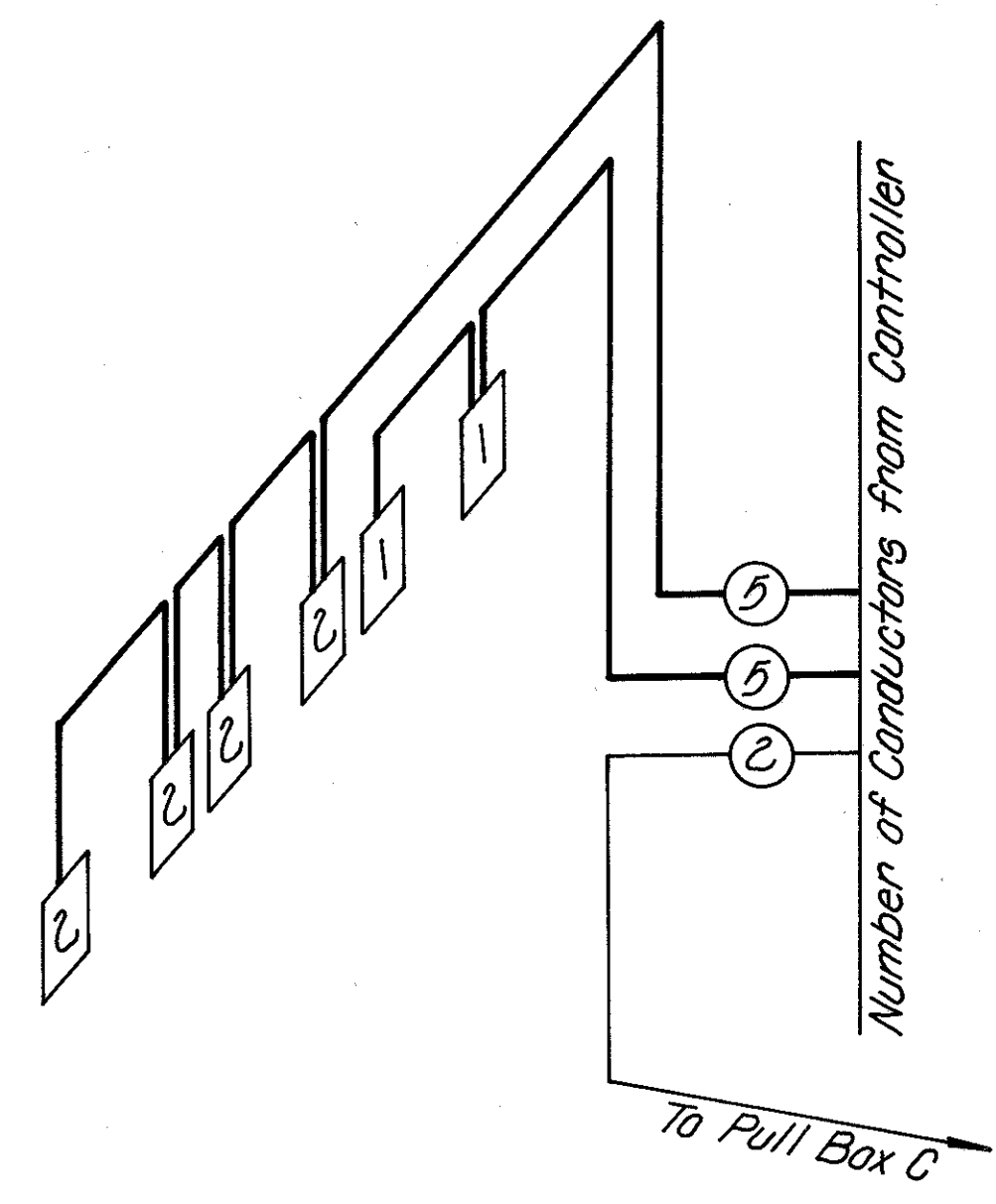

WIRING DIAGRAM

Timing Dial Setting	Sequence	
	Initial	Vehicle
Initial	5	—
Vehicle	3	—
Maximum	15	—
Minimum	—	59
Clearance (Yellow)	3	3
Clearance (Red)	0	0

Signal	Phase				Flash
	A R/W	B C	A R/W	B C	
Signal 1	G	Y	R	R	R
Signal 2	R	R	G	Y	Y

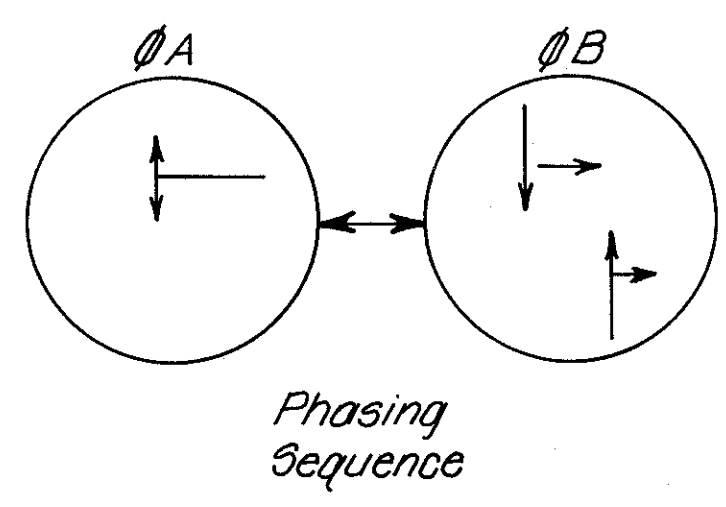

Phasing Sequence

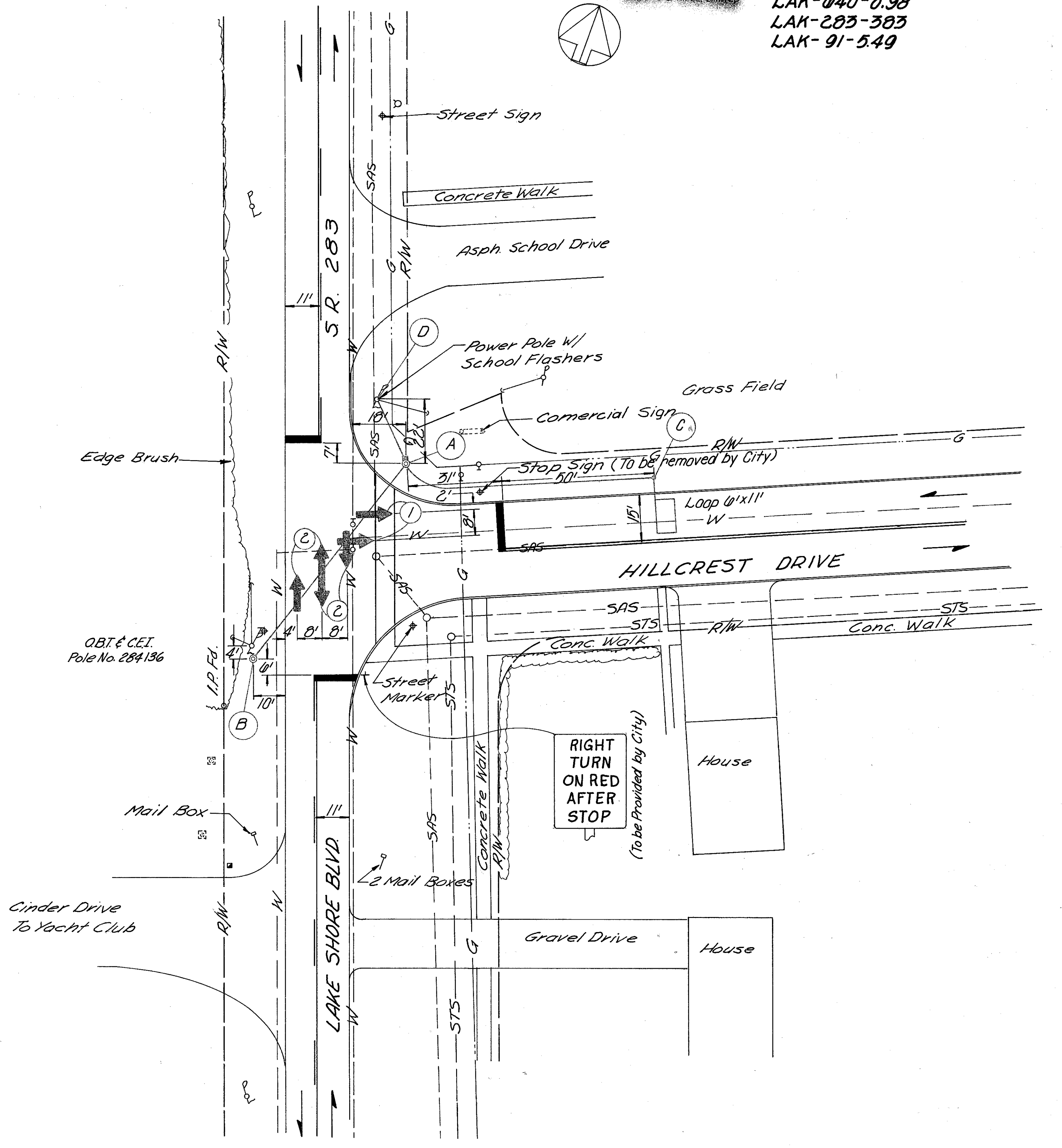

LAKE SHORE BLVD. & HILLCREST DR. SIGNAL PLAN