

PAVEMENT MARKING SUB-SUMMARY

REFERENCE NO.	LOCATION	STATION		CENTER LINE, DOUBLE SOLID MILES	24" STOP LINES LIN. FT.	CROSSWALK LINES LIN. FT.
		FROM	TO			
1	LLOYD ROAD				18	
2	LLOYD ROAD				18	
3	LLOYD ROAD	21+95	40+35	.35		
4						

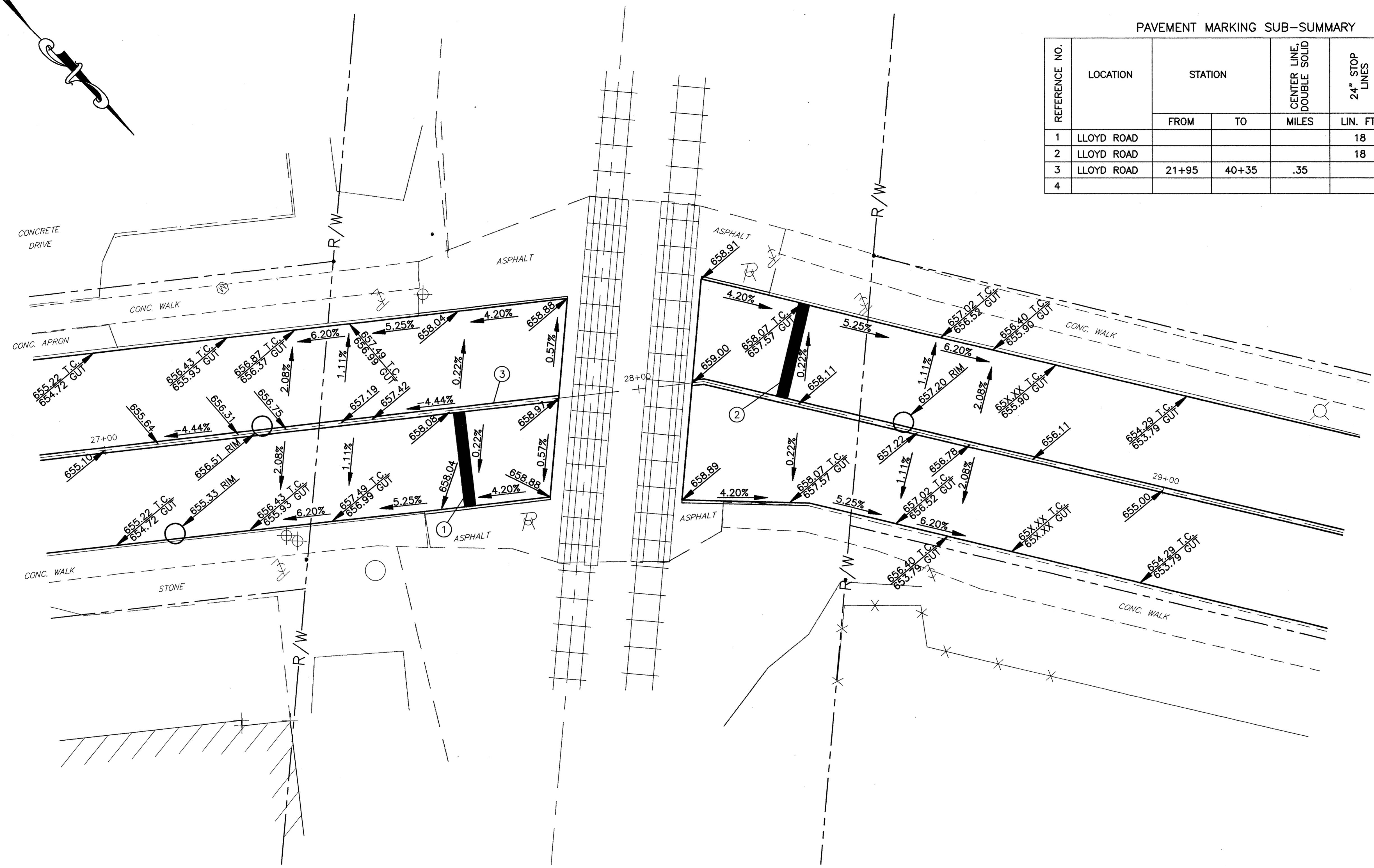

LLOYD ROAD AND NORFOLK & WESTERN RAILROAD

CT Consultants, Inc.
Engineers • Architects • Planners
 Willoughby • Mentor • Columbus • North Canton • Youngstown



REV. NO.	DESCRIPTION	DATE	BY	CH'K'D.

LLOYD ROAD IMPROVEMENTS
 CITY OF WICKLIFFE, LAKE COUNTY, OHIO

DATE:	2-14-00
DRAWN BY:	M.F.L.
CHECKED BY:	P.J.F.
APPROVED BY:	D.W.
F.B. No.:	PG. —

INTERSECTION / TRAFFIC DETAILS

SCALE	
1"=10'	
CONTRACT No.	
98367	
SHEET NO.	OF
13	20

COPYRIGHT - DATE: 02-14-00 13: CT CONSULTANTS INC. H: 1998/08347/DWG/INTERSECDWG