

(C1) RAMP C @ CURVE DATA

P.I. STA. = 76+23.75
 $\Delta = 8' 18' 08''$
 $D_c = 1' 30' 00''$
 $R = 3819.72'$
 $L = 277.23'$
 $T = 553.49'$
 $E = 10.05'$
 $e_{max} = 0.028$
 FC STA. = 73+46.52
 PCC STA. = 79+00.01

(C2) RAMP C @ CURVE DATA

P.I. STA. = 79+95.92
 $\Delta = 5' 44' 59''$
 $D_c = 3' 00' 00''$
 $R = 1909.86'$
 $L = 95.91'$
 $T = 191.66'$
 $E = 2.41'$
 $e_{max} = 0.040$
 PCC STA. = 79+00.01
 PT STA. = 80+91.67

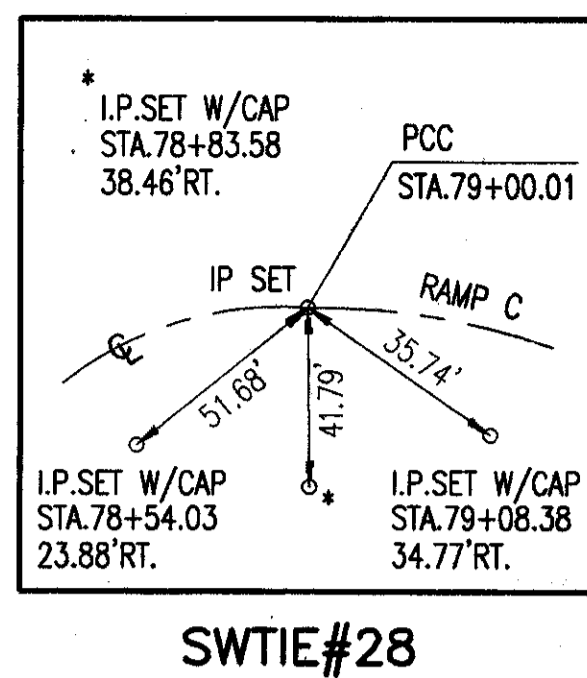
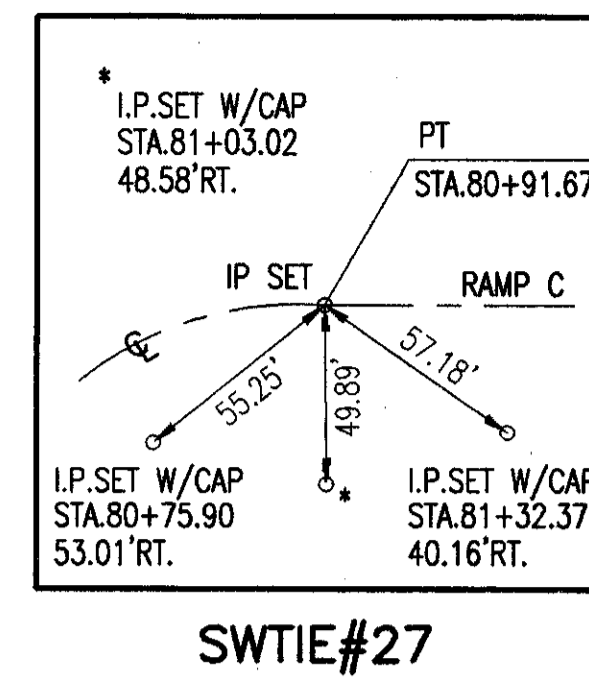

FOR TYPICAL SECTIONS, SEE SHEETS 5 THRU 15
 FOR CROSS SECTIONS AND PIPE PROFILES, SEE SHEETS 216 THRU 225
 FOR SUPERELEVATION TABLES, SEE SHEETS 246 THRU 254
 FOR INTERSECTION DETAILS, SEE SHEETS 255 THRU 262
 FOR SIGNING AND PAVEMENT MARKING PLAN, SEE SHEETS 313 THRU 314

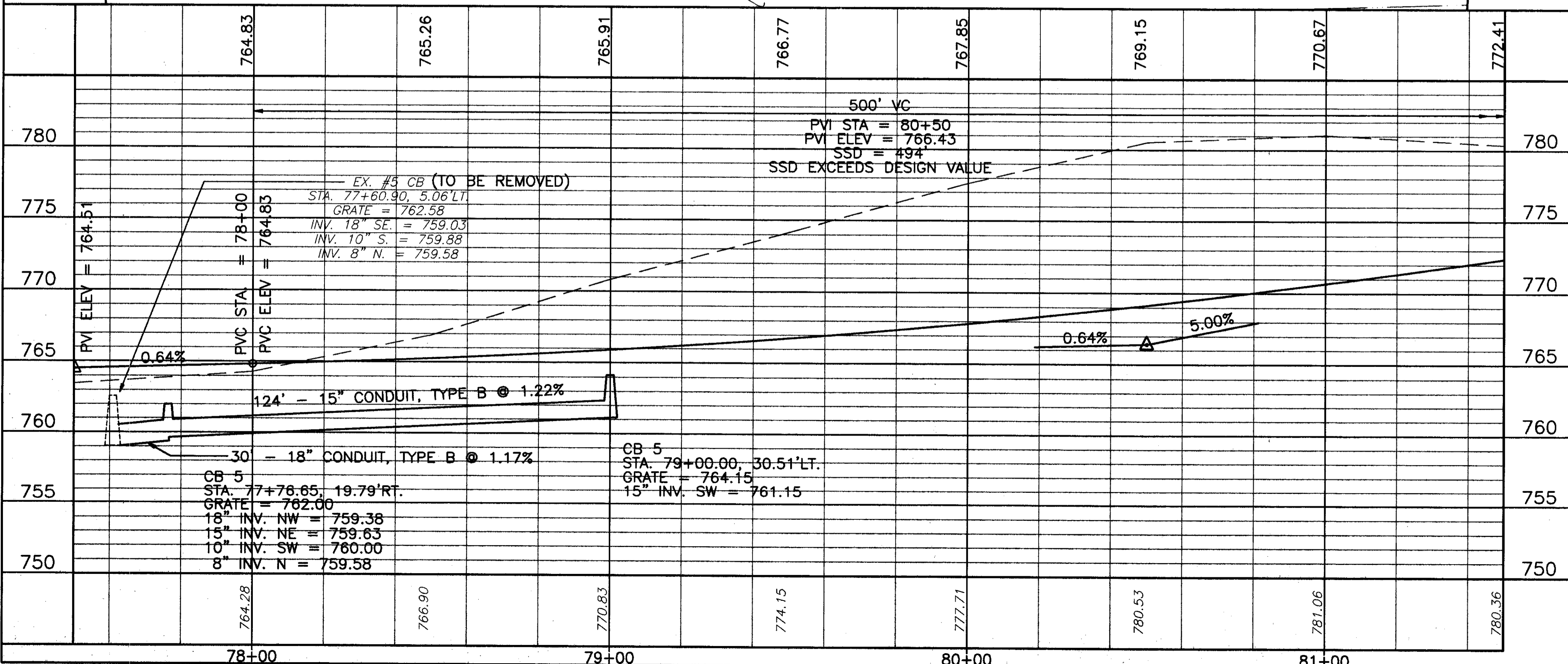

| | | | | | |
|---------------|----------------------------------|---------|-----|---|-----|
| 604 | CATCH BASIN NO. 5, AS PER PLAN | EACH | 1 | 1 | 2 |
| 603 | 18" CONDUIT, TYPE B, AS PER PLAN | LIN.FT. | 30 | | 30 |
| 603 | 15" CONDUIT, TYPE B, AS PER PLAN | LIN.FT. | 124 | | 124 |
| 603 | 10" CONDUIT, TYPE C, AS PER PLAN | LIN.FT. | 6 | | 6 |
| 202 | CATCH BASIN REMOVED | EACH | 1 | | 1 |
| TOTALS | | | | | |

| REF | LOCATION | DRAINAGE |
|---------------|---|----------|
| D-1 | STA. 77+60.90, LT. TO STA. 77+76.65, RT. | |
| D-2 | STA. 77+66.65, 19.79' RT. TO STA. 79+00, 30.51' LT. | |
| R-1 | STA. 77+61.0, 5' LT. | |
| TOTALS | | |