

LAKE COUNTY
 CITY OF MENTOR & VILLAGE OF KIRTLAND HILLS
 T =9&10 N, R =9 W

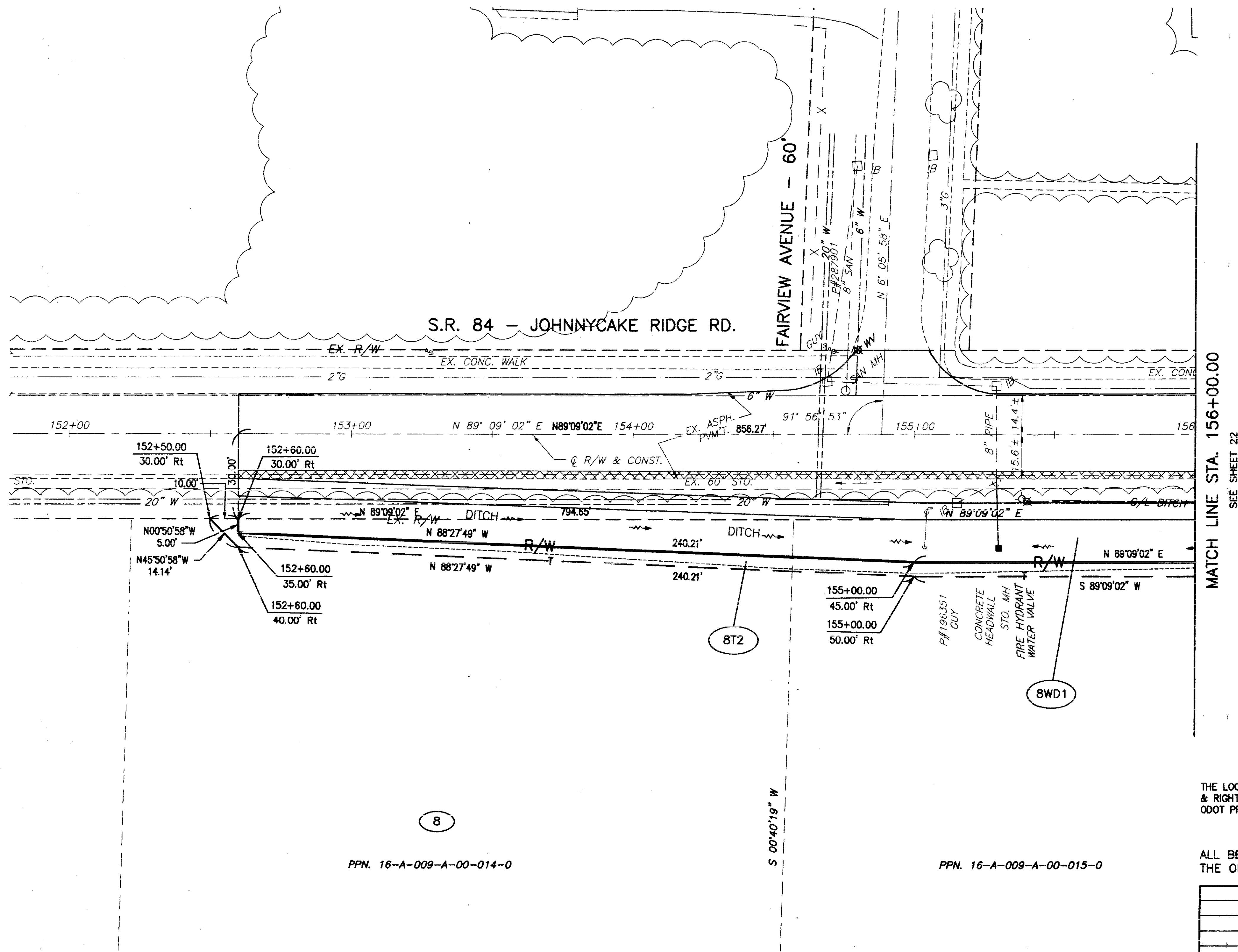

PPN. 16-A-009-A-00-014-0

PPN. 16-A-009-A-00-015-0

THE LOCATION & WIDTH OF THE EXISTING LIMITED ACCESS & RIGHT OF WAY LINES WERE ESTABLISHED USING ODOT PROJECT LAK-1-6.97 (1960) & COUNTY RECORDS.

ALL BEARINGS FOR THIS PROJECT ARE BASED ON THE ODOT PROJECT LAK-1-6.97 (APRIL 1960)

REV	DATE	DESCRIPTION

DATE COMPLETED:



PID NO. 9331
 R/W DESIGNER P.S.L.
 R/W REVIEWER W.D.B.

RIGHT OF WAY PLAN
 STA. 152+00.00 TO STA. 156+00.00

LAK-IR90/SR615-9.26/1.51

21/24

391
 393

H:\CT\97125\SDSK\RW\PARCEL8.dwg 08/23/2000 10:48:00 AM EDT