

LAKE COUNTY
CITY OF MENTOR & VILLAGE OF KIRTLAND HILLS

T = 9&10 N, R = 9 W

PPN. 16-A-009-0-00-001-0

PPN. 16-A-009-A-00-026-0

PPN. 16-A-009-A-00-025-0



PID NO. 9331
R/W DESIGNER P.S.L.
R/W REVIEWER W.D.B.

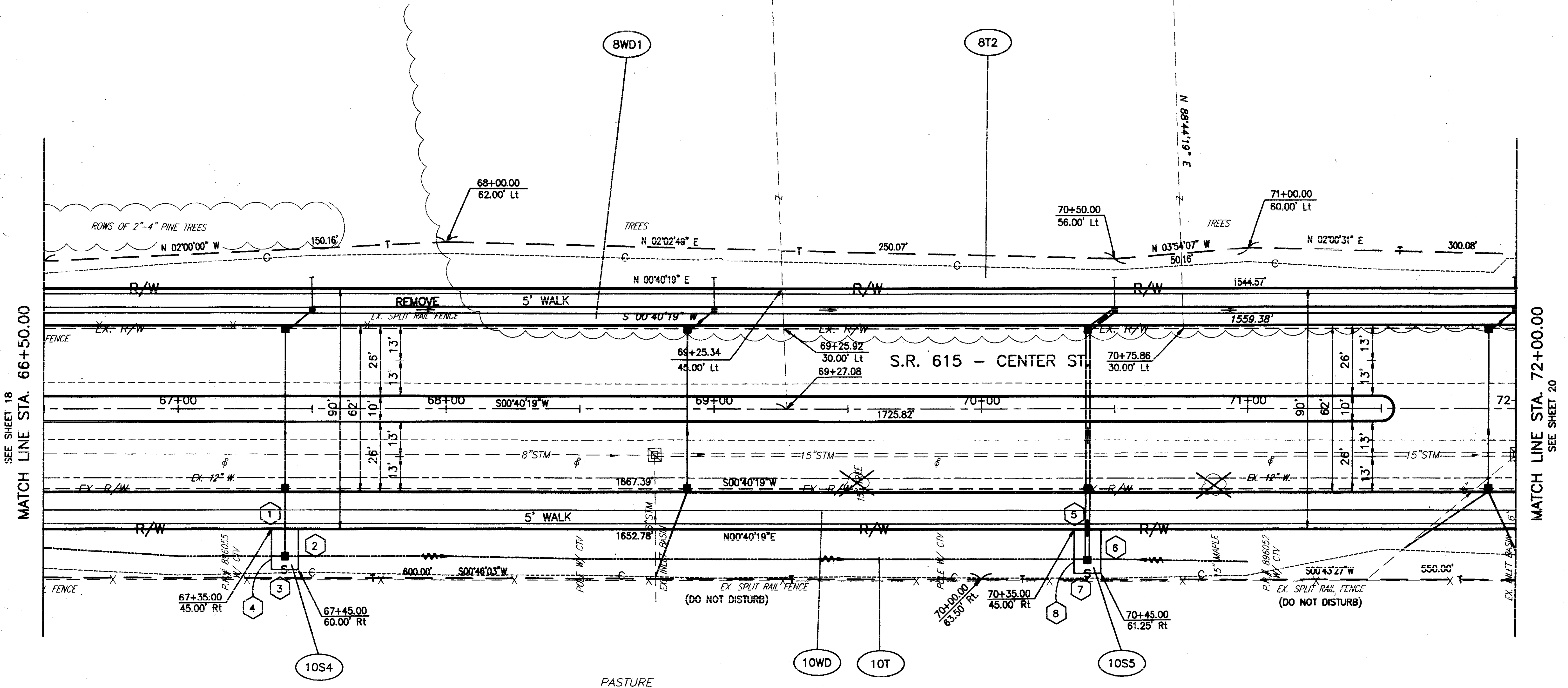

SEE SHEET 18
MATCH LINE STA. 66+50.00

MATCH LINE STA. 72+00.00
SEE SHEET 20

RIGHT OF WAY PLAN
STA. 66+50.00 TO STA. 72+00.00

10S4

1	N00°40'19"E	10.00'
2	S89°19'41"E	15.00'
3	S00°40'19"W	10.00'
4	N89°19'41"W	15.00'

PARCEL 10S4 OVERLAPS PARCEL 10T BY 150 S.F.

PPN. 16-A-011-0-00-001-0

10S5

5	N00°40'19"E	10.00'
6	S89°19'41"E	16.25'
7	S00°40'19"W	10.00'
8	N89°19'41"W	16.25'

PARCEL 10S5 OVERLAPS PARCEL 10T BY 163 S.F.

THE LOCATION & WIDTH OF THE EXISTING LIMITED ACCESS & RIGHT OF WAY LINES WERE ESTABLISHED USING ODOT PROJECT LAK-1-6.97 (1960) & COUNTY RECORDS.

ALL BEARINGS FOR THIS PROJECT ARE BASED ON THE ODOT PROJECT LAK-1-6.97 (APRIL 1960)

REV	DATE	DESCRIPTION

H:\CT\97125\SDSK\RW\PARCEL8.dwg 08/23/2000 10:48:00 AM EDT