

G CURVE DATA
 P.I. STA. = 3+05.63
 $\Delta = 47^\circ 30' 00''$
 $D_c = 38^\circ 11' 50''$
 $R = 150.00'$
 $T = 66.00'$
 $L = 124.36'$
 $E = 13.88'$
 $e_{max} = -0.020$
 P.C. STA. = 2+39.63
 P.T. STA. = 3+63.99

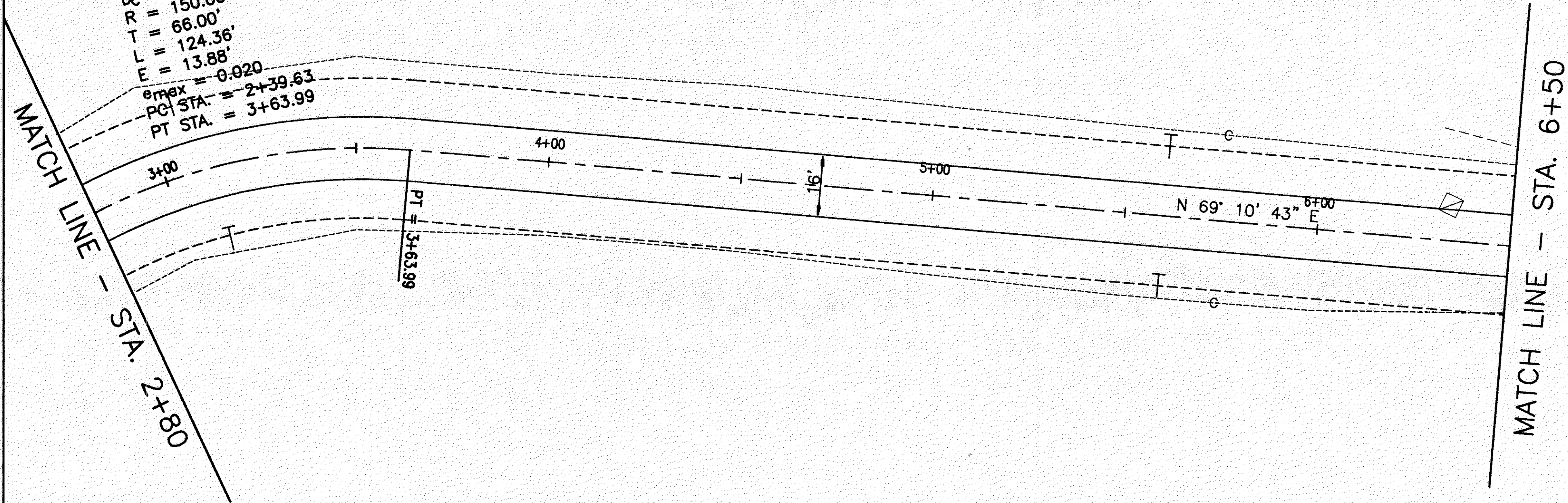

	772.98		773.23		773.48		773.73		773.98		774.23		774.48	
785														785
780														780
775														775
770														770
765														765
760														760
	774.80		774.83		774.34		774.97		775.55		775.96		776.05	
3+00					4+00				5+00				6+00	

BENCH MARK #8
 TOP RR SPIKE 1' UP EAST
 SIDE 9" MAPLE TREE
 STA. 111+32±, 84'±LT.
 ELEV. 750.99

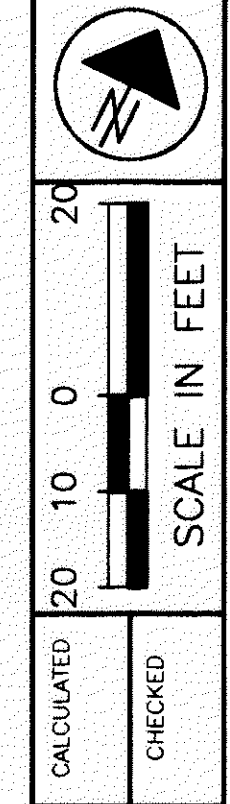

CALCULATED
 CHECKED

OSBORNE DRIVE RELOCATION
 PLAN AND PROFILE STA. 2+80 TO STA. 6+50