

PLAN

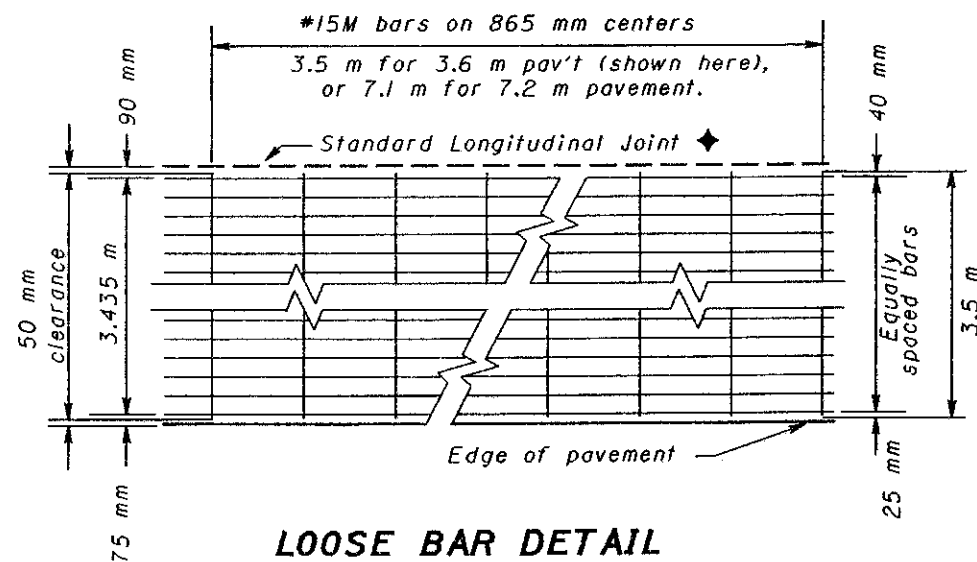

LOOSE BAR DETAIL

STEEL REQUIREMENTS		
T (mm)	Bar Size	No. Bars per 3.6 m Lane
200	#15M	23
230	#20M	18
250	#20M	20
280	#20M	22
300	#25M	18
330	#25M	20
360	#25M	21

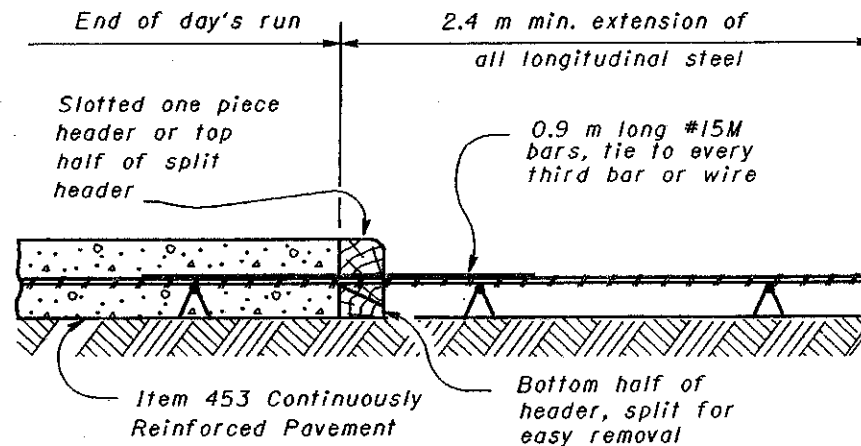

CONSTRUCTION JOINT

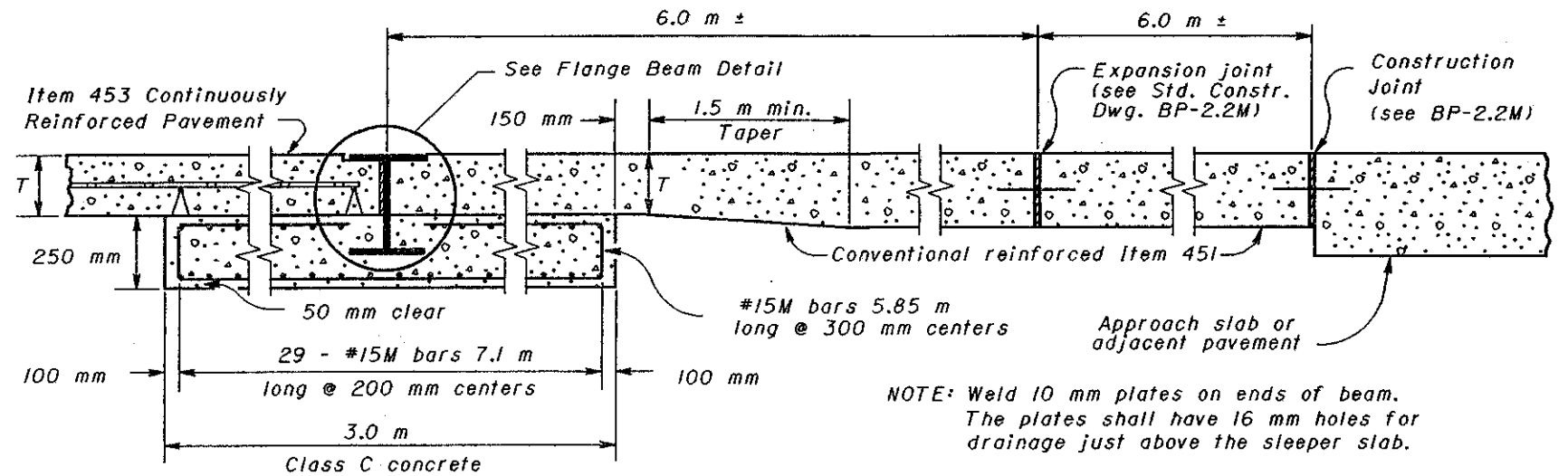

FLANGE BEAM JOINT

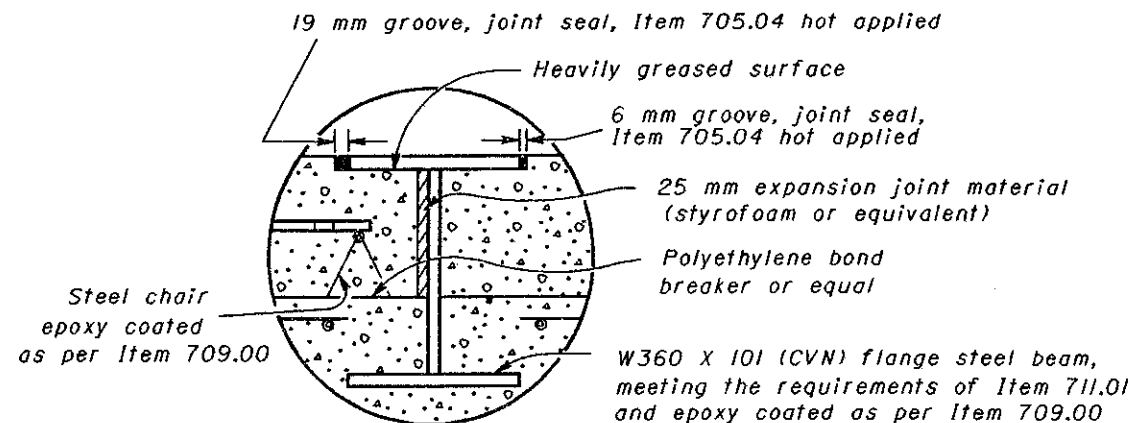

FLANGE BEAM DETAIL

NOTES

REINFORCING STEEL: All steel shall be placed in the concrete so that the longitudinal steel is located between a minimum cover of 65 mm and a maximum depth of T/2.

ALL LONGITUDINAL LAPS: Laps shall be tied so as to provide continuous longitudinal reinforcing.

ITEM 709.03 BARS: All bars shall be epoxy coated as per Item 709.00 and shall be set on chairs ahead of paving operation. Minimum bar length 12.2 m.

⊗ No lap shall occur within 2.4 m ahead or 0.9 m behind a construction joint in the direction of paving.

◆ If 7.2 m bars are used, omit tie bars.



BUREAU OF LOCATION AND DESIGN
OHIO DEPARTMENT OF TRANSPORTATION

CONTINUOUSLY REINFORCED PAVEMENT

DATE: 10-28-94

STANDARD CONSTRUCTION DRAWING **BP-1.2M**

APPROVED: *D.K. Anderson*
ENGR., L & D