

NOTE: REPLACE EXISTING DETECTOR LOOPS AS INDICATED ON THE PLANS. CONTACT THE CITY OF MENTOR FOR FINAL LOOP LOCATIONS. DETECTOR LOOPS SHALL BE RECONNECTED TO EXISTING LEAD-IN CABLE.

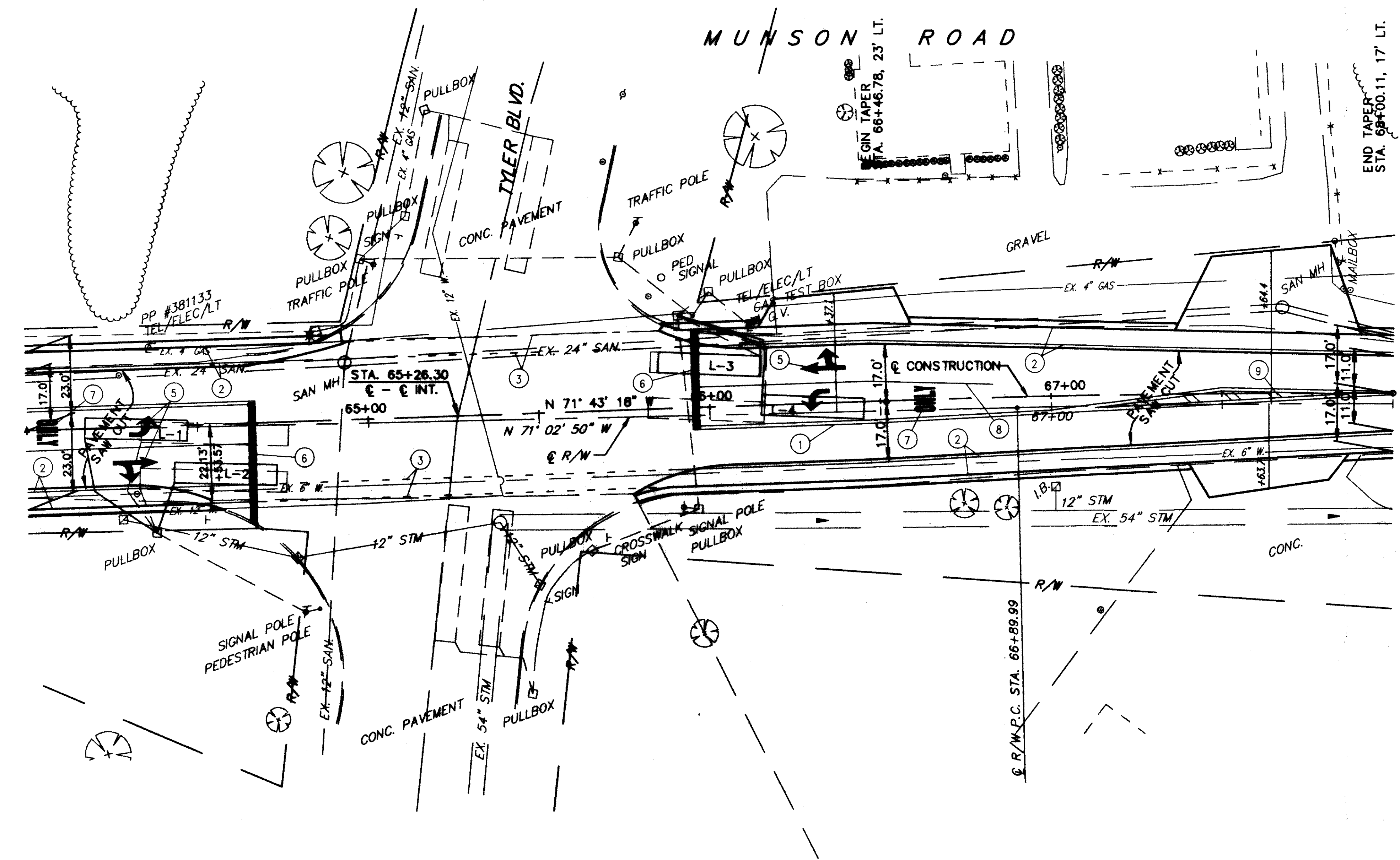
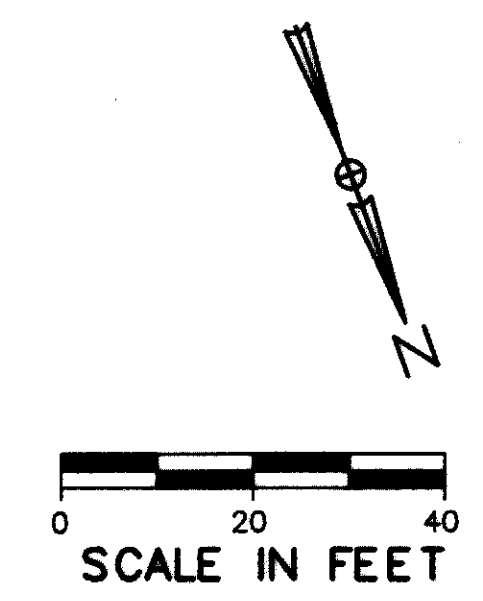

- LEGEND
- ① ITEM 642 - CENTER LINE, DOUBLE, SOLID (EXISTING)
 - ② ITEM 642 - EDGE LINE, WHITE
 - ③ ITEM 642 - DOTTED LINE, 4" WHITE
 - ④ ITEM 642 - CROSSWALK LINE (EXISTING)
 - ⑤ ITEM 642 - LANE ARROW (EXISTING)
 - ⑥ ITEM 642 - STOP LINE (EXISTING)
 - ⑦ ITEM 642 - WORD ON PAVEMENT (EXISTING)
 - ⑧ ITEM 642 - CHANNELIZING LINE (EXISTING)
 - ⑨ ITEM 642 - TRANSVERSE LINE (EXISTING)

LOOP	SIZE	TURNS	MODE	DELAY	PHASE	REMARK	INHIBITED DELAY	LOCATION 1st FRONT CORNER	LOCATION 2nd FRONT CORNER
L-1	6X30	2				REPLACE EXIST		STA. 64+47, 1.5' LT	STA. 64+47, 4.5' RT
L-2	6X30	2				REPLACE EXIST		STA. 64+73, 12.4' RT	STA. 64+73, 18.4' RT
L-3	6X30	2				REPLACE EXIST		STA. 65+85, 10.7' LT	STA. 65+85, 16.7' LT
L-4	6X30	2				REPLACE EXIST		STA. 66+15, 3' LT	STA. 66+15, 3' RT

LOOP DETECTOR CHART

SIGNAL REVISIONS		DETECTOR LOOP
REF	DESCRIPTION	EACH
L-1	REPLACE DETECTOR LOOP	1
L-2	REPLACE DETECTOR LOOP	1
L-3	REPLACE DETECTOR LOOP	1
L-4	REPLACE DETECTOR LOOP	1
TOTALS		4

DATE: 02-12-99 - 11:30, CT CONSULTANTS INC. H:\CT\92535\CA0\TRAFFIC\TYLER.DWG Scale: 1"=20'