

NOTE: CONTRACTOR SHALL HAND DIG AROUND EXISTING DETECTOR LOOPS. CONTRACTOR SHALL REPLACE PULL BOX AND CONDUIT AS INDICATED ON THE PLANS. CONTACT PAUL CIUPA AT THE CITY OF MENTOR (440) 255-1100 PRIOR TO HAND DIGGING LOOPS. LOOP LEAD-IN CABLE SHALL BE PULLED OUT OF THE EXISTING CONDUIT AND CONNECTED TO THE LOOPS THROUGH THE NEW CONDUIT. INSTALLATION OF NEW LOOPS SHALL OCCUR ONLY IF EXISTING LOOPS ARE DAMAGED BY CONTRACTOR'S OPERATIONS. COST OF INSTALLATION OF NEW LOOPS SHALL BE THE RESPONSIBILITY OF THE GENERAL CONTRACTOR.

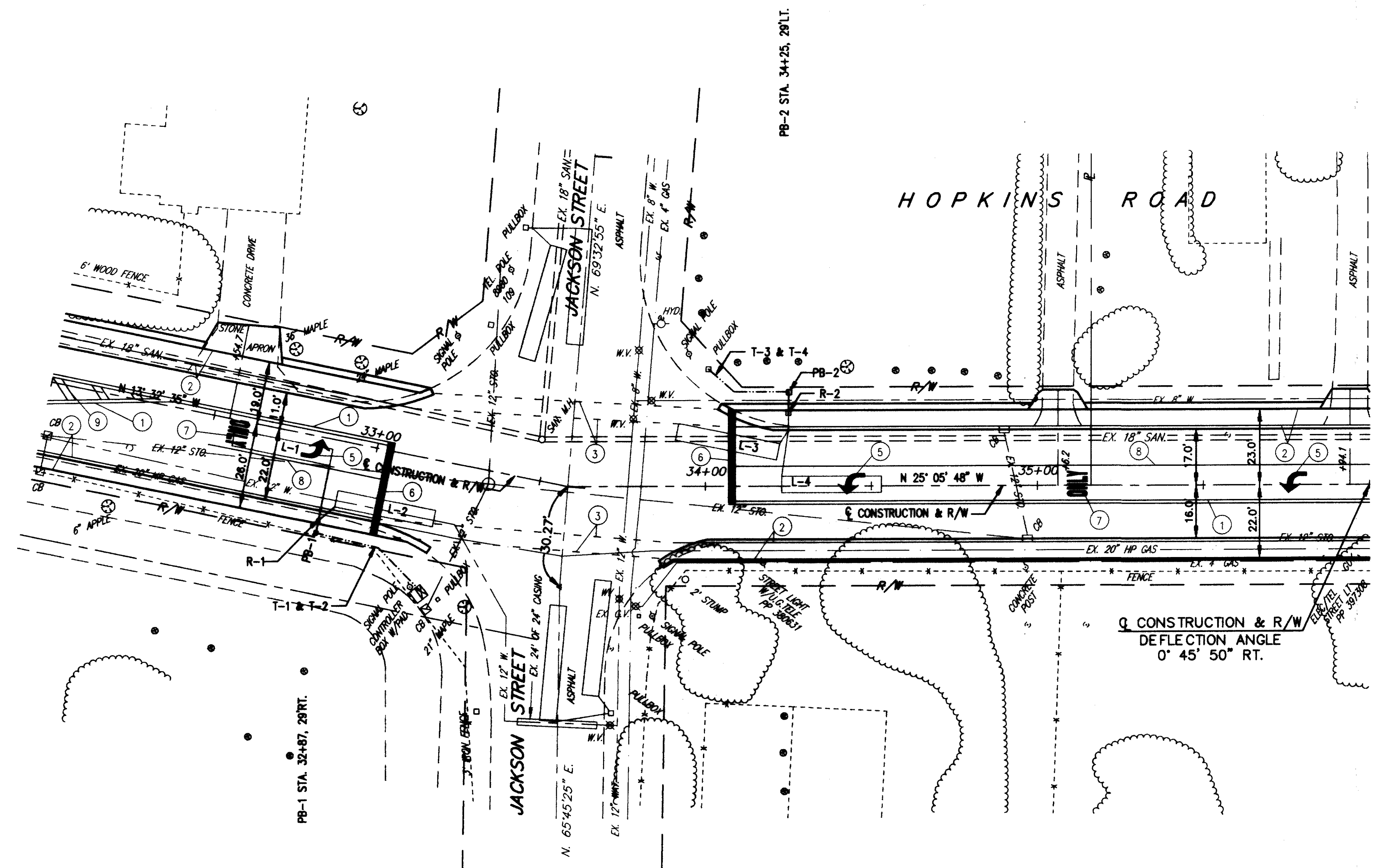
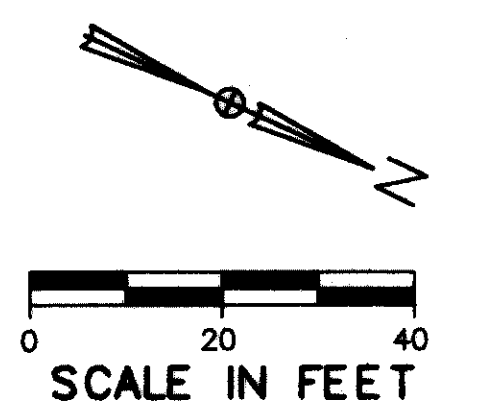

- LEGEND**
- ① ITEM 642 - CENTER LINE, DOUBLE, SOLID
 - ② ITEM 642 - EDGE LINE, WHITE
 - ③ ITEM 642 - DOTTED LINE, 4" WHITE
 - ④ ITEM 642 - CROSSWALK LINE
 - ⑤ ITEM 645 - LANE ARROW (REMOVE & REPLACE)
 - ⑥ ITEM 645 - STOP LINE (REMOVE & REPLACE)
 - ⑦ ITEM 645 - WORD ON PAVEMENT (REMOVE & REPLACE)
 - ⑧ ITEM 645 - CHANNELIZING LINE (REMOVE & REPLACE)
 - ⑨ ITEM 642 - TRANSVERSE LINE

LOOP	SIZE	URNS	MODE	DELAY	PHASE	RE.MARK	INHIBITED DELAY	LOCATION 1st FRONT CORNER	LOCATION 2nd FRONT CORNER
L-1	6X30	2				SAVE EXIST.		STA. 32+87, 2'RT	STA. 32+87, 8'RT
L-2	5X30	2				SAVE EXIST.		STA. 32+91, 15'RT	STA. 32+91, 20'RT
L-3	5X30	2				SAVE EXIST.		STA. 34+21, 8'LT	STA. 34+22, 13'LT
L-4	6X30	2				SAVE EXIST.		STA. 34+23, 3'RT	STA. 34+23, 3'LT

LOOP DETECTOR CHART

REF	SIGNAL REVISIONS DESCRIPTION	QUANTITIES			
		EACH	EACH	LN.FT.	LN.FT.
L-1	HAND DIG AROUND DETECTOR LOOP				
L-2	HAND DIG AROUND DETECTOR LOOP				
L-3	HAND DIG AROUND DETECTOR LOOP				
L-4	HAND DIG AROUND DETECTOR LOOP				
PB-1	INSTALL NEW PULL BOX	1			
PB-2	INSTALL NEW PULL BOX	1			
T-1	INSTALL NEW 2" CONDUIT			38	
T-2	REUSE LEAD-IN CABLE				48
T-3	INSTALL NEW 2" CONDUIT			27	
T-4	REUSE LEAD-IN CABLE				37
R-1	REMOVE PULL BOX		1		
R-2	REMOVE PULL BOX		1		
TOTALS		2	2	65	85

SIGNAL PLAN

DATE: 07-22-98, CT CONSULTANTS, INC. H:\VCT\22535\CAD\TRAFFIC\JACKSON.DWG Scale: 1"=20'