

MARC J. & GAIL A. STEINDLER
VOL. 138, PG. 235

FRANK JR. & MARY R. TERDAN
VOL. 30, PG. 328
VOL. 399, PG. 278

JOHN F. JR. & MARY E. BENCHINA
VOL. 416, PG. 736
HOUSE # 8727

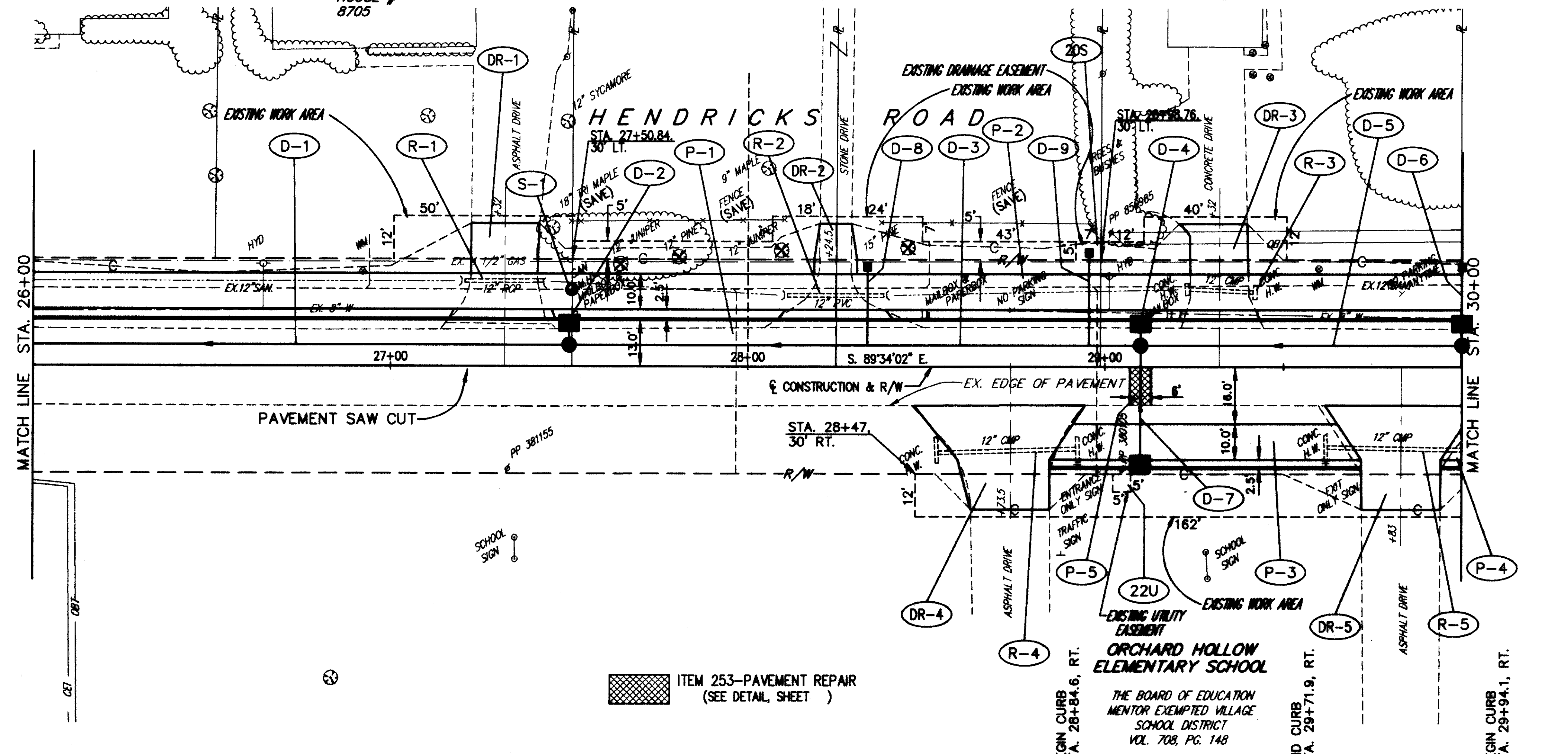

BENCH MARK #3
SW CORNER OF 7.0'x 0.8' CONCRETE HEADWALL WEST SIDE OF DRIVE TO (ENTRANCE) ORCHARD HOLLOW SCHOOL
ELEV. = 621.10

FOR TYPICAL SECTIONS SEE SHEET 13
FOR CROSS-SECTIONS SEE SHEETS 149 THRU 165
FOR DRIVEWAY SCHEDULE & DETAILS SEE SHEET 24
FOR DRIVEWAY PROFILES SEE SHEET 166
FOR PAVEMENT DETAILS SEE SHEET 171
FOR TRAFFIC CONTROL DETAILS SEE SHEETS 172 THRU 198
FOR MAINTENANCE OF TRAFFIC DETAILS SEE SHEETS 17 & 18

ITEM	DESCRIPTION	UNIT	AMOUNT	AMOUNT	AMOUNT	AMOUNT	AMOUNT	AMOUNT	AMOUNT
830	CURB, TYPE 6	LI. FT.	400						400
830	CURB, TYPE 3	LI. FT.	400						400
448	1-1/4" ASPH. CONC. SURFACE COURSE, TYPE 1, PG84-22	CU. YD.	20.1						20.1
448	1-3/4" ASPH. CONC. INTERMEDIATE COURSE, TYPE 2, PG84-22	CU. YD.	28.1						28.1
408	BITUMINOUS PRIME COAT (0.40 GAL./SQ.YD.)	GAL.	231						231
407	TACK COAT FOR INTERMEDIATE COURSE (0.05 GAL./SQ.YD.)	GAL.	28.9						28.9
407	TACK COAT (0.10 GAL./SQ.YD.)	GAL.	57.8						57.8
304	6" AGGREGATE BASE, AS PER PLAN	CU. YD.	74.1						74.1
304	4" AGGREGATE BASE, AS PER PLAN	CU. YD.	14.9						14.9
301	6" BITUMINOUS AGGREGATE BASE, PG84-22	CU. YD.	0.5						0.5
263	PAVEMENT REPAIR	SQ. YD.	8						8
203	SUBGRADE COMPACTION	SQ. YD.	1115						1115
SPEC.	SOIL STERILANT	SQ. YD.	537						537
									TOTALS

REF	LOCATION	AMOUNT	AMOUNT
P-1	STA. 26+00 TO 26+00, LT. = 5200 SF.		
P-2	STA. 26+00 TO 30+00, LT. = 4000 SF.		
P-3	STA. 28+84.60 TO 29+71.89, RT. = 806 SF.		
P-4	STA. 28+84.60 TO 30+00, RT. = 28 SF.		
P-5	STA. 29+07 TO 29+13, RT.		
		TOTALS	

REF	LOCATION	LI. FT.	LI. FT.
R-1	STA. 27+21 TO STA. 27+43, LT.	22	
R-2	STA. 28+11 TO STA. 28+38, LT.	27	
R-3	STA. 29+22 TO STA. 29+42, LT.	20	
R-4	STA. 28+53 TO STA. 28+93, RT.	40	
R-5	STA. 29+62 TO STA. 30+00, RT.	38	
		TOTALS	147

REF	LOCATION	LI. FT.	LI. FT.	LI. FT.	EACH	EACH	EACH	EACH	EACH	EACH
D-1	STA. 26+00 TO STA. 27+50, 6' LT.		150		1					
D-2	STA. 27+50, 6' LT. TO 13' LT.	7								
D-3	STA. 27+50 TO STA. 29+10, 6' LT.		180		1					
D-4	STA. 29+10, 6' LT. TO 13' LT.	7								
D-5	STA. 29+10 TO STA. 30+00, 6' LT.	90								
D-6	STA. 30+00, 6' LT. TO 28.5' LT.	22.5								
D-7	STA. 29+10, 6' LT. TO 27.5' LT.	22.5		33.5						
D-8	STA. 28+33.5, 6' LT. TO 28.5' LT.	22.5								
D-9	STA. 28+95.5, 6' LT. TO 32' LT.									
S-1	STA. 27+51, 21.5' LT.	26								
		TOTALS	175	33.5	310	3	1	3	1	2

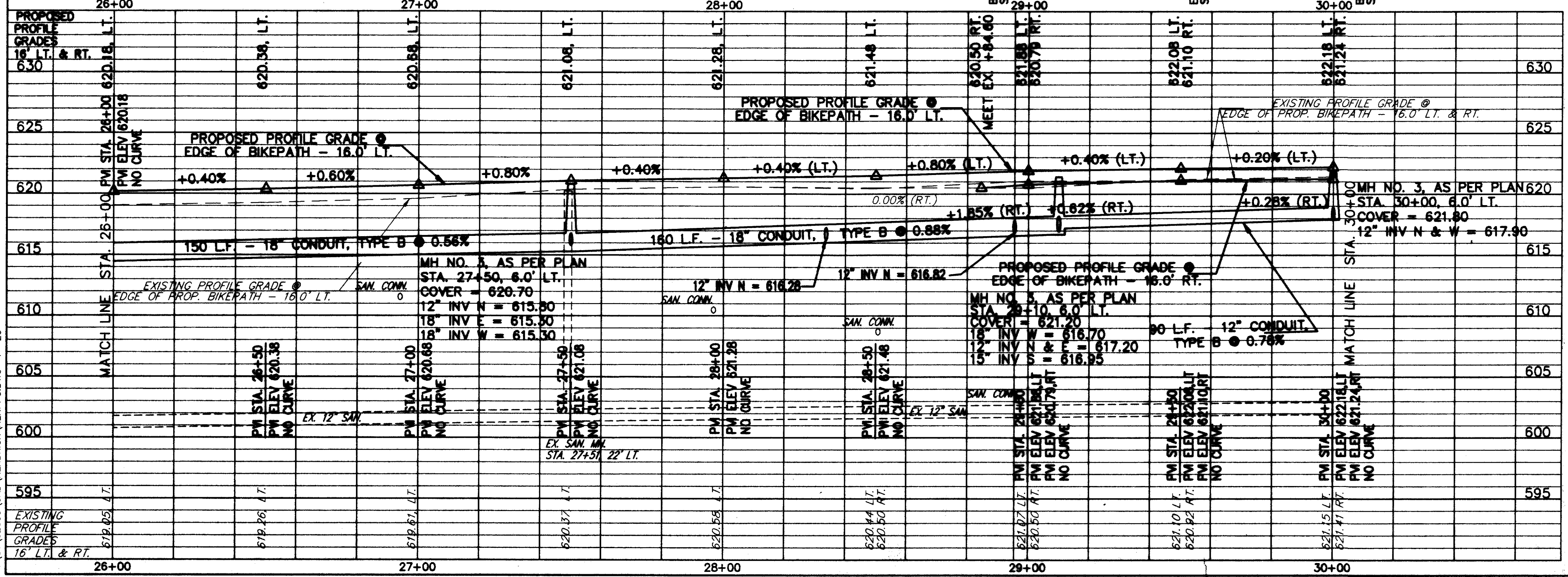

REF	LOCATION	LI. FT.	LI. FT.	LI. FT.	EACH	EACH	EACH	EACH	EACH	
D-1	STA. 26+00 TO STA. 27+50, 6' LT.		150		1					
D-2	STA. 27+50, 6' LT. TO 13' LT.	7								
D-3	STA. 27+50 TO STA. 29+10, 6' LT.		180		1					
D-4	STA. 29+10, 6' LT. TO 13' LT.	7								
D-5	STA. 29+10 TO STA. 30+00, 6' LT.	90								
D-6	STA. 30+00, 6' LT. TO 28.5' LT.	22.5								
D-7	STA. 29+10, 6' LT. TO 27.5' LT.	22.5		33.5						
D-8	STA. 28+33.5, 6' LT. TO 28.5' LT.	22.5								
D-9	STA. 28+95.5, 6' LT. TO 32' LT.									
S-1	STA. 27+51, 21.5' LT.	26								
		TOTALS	175	33.5	310	3	1	3	1	2

HENDRICKS ROAD PLAN & PROFILE STA. 26+00 TO STA. 30+00

H:\CT\92535\CAD\HENDRICKS\HENDRICKS.DWG 1"=20'