

BENCH MARK #10
 CHISELED SQ. S.END S.R.BRIGE
 WALL W.SIDE MUNSON RD.
 STA. 73+50± LT.
 ELEV. 649.14

BM10

NO.	DESCRIPTION	CU.YD.	SQ.YD.	EA.	FOOTING	CONC.	ASPH.	BITUM.	OTHR.	TOTAL
830	CURB, TYPE 6, AS PER PLAN									
448	1-1/4" ASPH. CONC. SURFACE COURSE, TYPE 1, PG64-22									
408	BITUMINOUS PRIME COAT (0.40 GAL./SQ.YD.)									
407	TACK COAT (0.10 GAL./SQ.YD.)									
304	6" AGGREGATE BASE, AS PER PLAN									
301	6" BITUMINOUS AGGREGATE BASE, PG64-22									
301	8 3/4" BITUMINOUS AGGREGATE BASE, PG64-22									
203	SUBGRADE COMPACTION									
203	EXCAVATION NOT INCLUDING EMBANKMENT CONSTRUCTION									
TOTALS										

REF	LOCATION	PAVEMENT	TOTALS
P-1	STA. 72+00 TO 73+41.59, LT. = 860 S.F.		
P-2	STA. 72+00 TO 73+41.59, RT. = 881 S.F.		
TOTALS			

FOR TYPICAL SECTIONS SEE SHEETS 9 THRU 12
 FOR CROSS-SECTIONS SEE SHEETS 100 THRU 140
 FOR DRIVEWAY SCHEDULE & DETAILS SEE SHEET 23
 FOR PAVEMENT DETAILS SEE SHEET 171
 FOR TRAFFIC CONTROL DETAILS SEE SHEETS 172 THRU 198

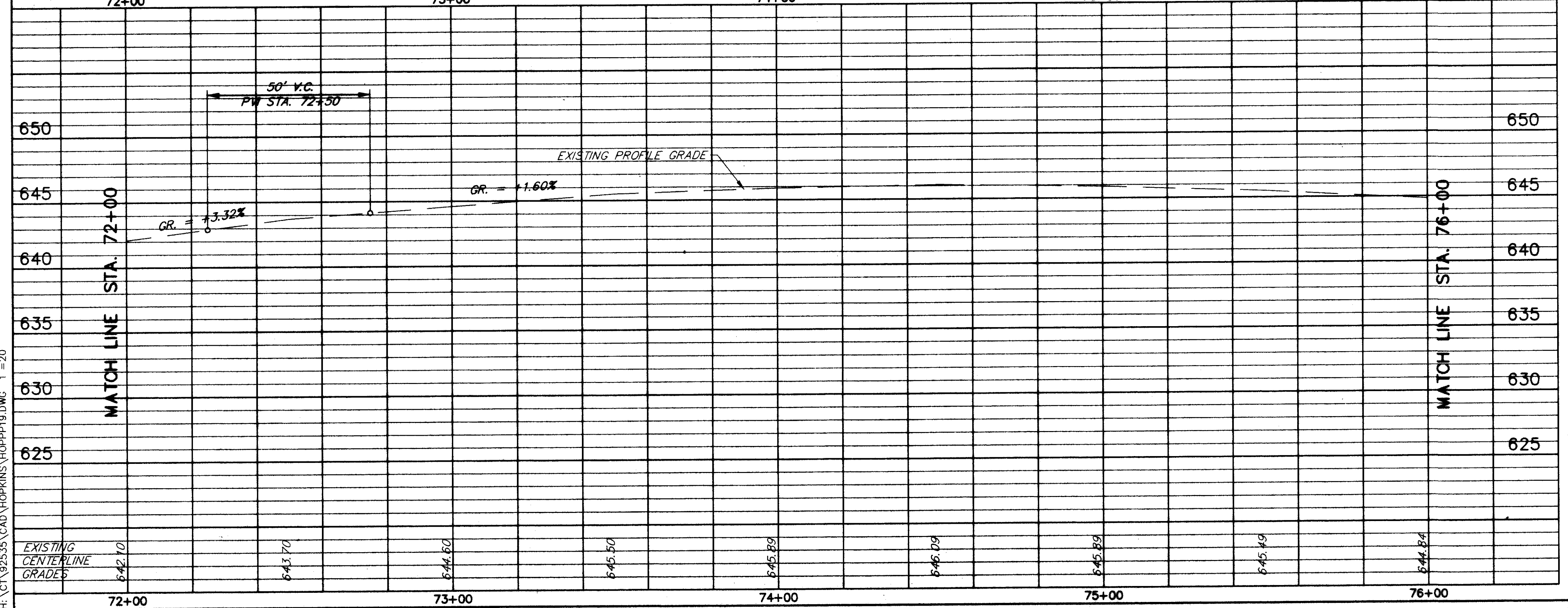
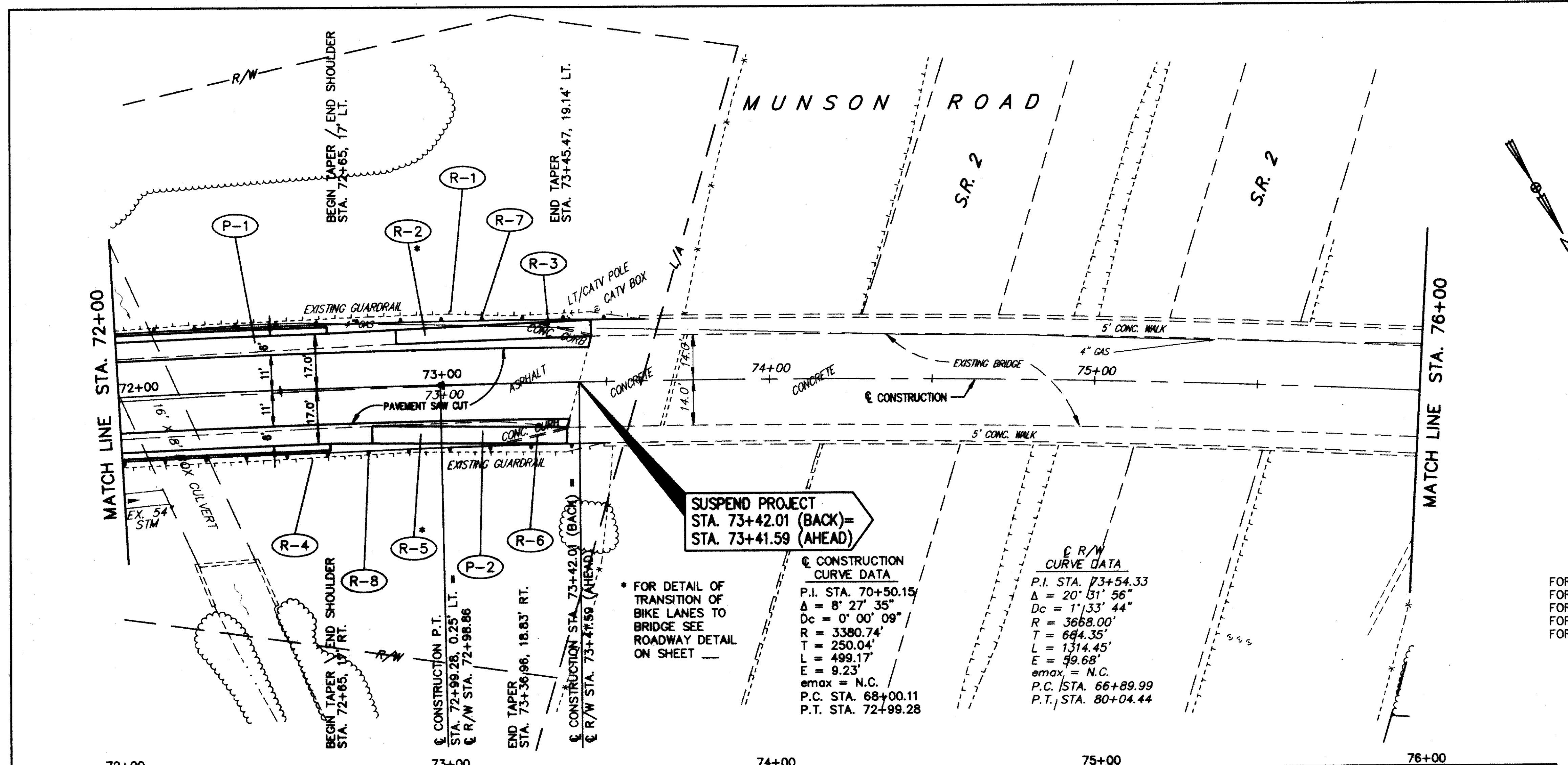

ROADWAY		202	202	606	606	606
REF	LOCATION	LIN.FT.	LIN.FT.	LIN.FT.	EACH	SQ.FT.
R-1	STA. 72+00 TO STA. 73+60, LT.		160			
R-2	STA. 72+86 TO STA. 73+46, LT.					300
R-3	STA. 73+30 TO STA. 73+46, LT.	16				
R-4	STA. 72+00 TO STA. 73+50, RT.		150			
R-5	STA. 72+78 TO STA. 73+38, RT.					300
R-6	STA. 73+19 TO STA. 73+38, RT.	16				
R-7	STA. 72+00 TO STA. 73+60, LT.			162.5	1	
R-8	STA. 72+00 TO STA. 73+50, RT.			153.5	1	
TOTALS		32	310	316	2	600

MUNSON ROAD PLAN & PROFILE STA. 72+00 TO STA. 76+00

H:\CT\92535\CAD\HOPKINS\HOPPP19.DWG 1"=20'