

STATION	DESCRIPTION	QTY	UNIT	TOTAL
830	CURB, TYPE 6, AS PER PLAN		LINE FT.	
448	1-1/4" ASPH. CONC. SURFACE COURSE, TYPE 1, PG#4-22	9.4	SQ. YD.	9.4
408	BITUMINOUS PRIME COAT (@ 0.40 GAL./SQ.YD.)	26.7	106.8	9.4
407	TACK COAT (@ 0.10 GAL./SQ.YD.)	26.7	106.8	9.4
304	6" AGGREGATE BASE, AS PER PLAN	45.4	SQ. YD.	45.4
301	6" BITUMINOUS AGGREGATE BASE, PG#4-22	13.9	55.6	45.4
301	8 3/4" BITUMINOUS AGGREGATE BASE, PG#4-22	15.1	60.4	45.4
203	SUBGRADE COMPACTION	267	SQ. YD.	267
203	EXCAVATION NOT INCLUDING EMBANKMENT CONSTRUCTION	135.1	SQ. YD.	135.1
TOTALS				288.1

FOR TYPICAL SECTIONS SEE SHEETS 9 THRU 12
 FOR CROSS-SECTIONS SEE SHEETS 100 THRU 140
 FOR DRIVEWAY SCHEDULE & DETAILS SEE SHEET 23
 FOR PAVEMENT DETAILS SEE SHEET 171
 FOR TRAFFIC CONTROL DETAILS SEE SHEETS 172 THRU 198

R/W CURVE DATA
 P.I. STA. 73+54.34
 $\Delta = 20^\circ 31' 56''$
 $D_c = 1' 33' 44''$
 $R = 3668.00'$
 $T = 664.35'$
 $L = 1314.45'$
 $E = 59.68'$
 $e_{max} = N.C.$
 P.C. STA. 66+89.99
 P.T. STA. 80+04.44

CONSTRUCTION CURVE DATA
 P.I. STA. 70+50.15
 $\Delta = 8^\circ 27' 35''$
 $D_c = 0' 00' 09''$
 $R = 3380.74'$
 $T = 250.04'$
 $L = 499.17'$
 $E = 9.23'$
 $e_{max} = N.C.$
 P.C. STA. 68+00.11
 P.T. STA. 72+99.28

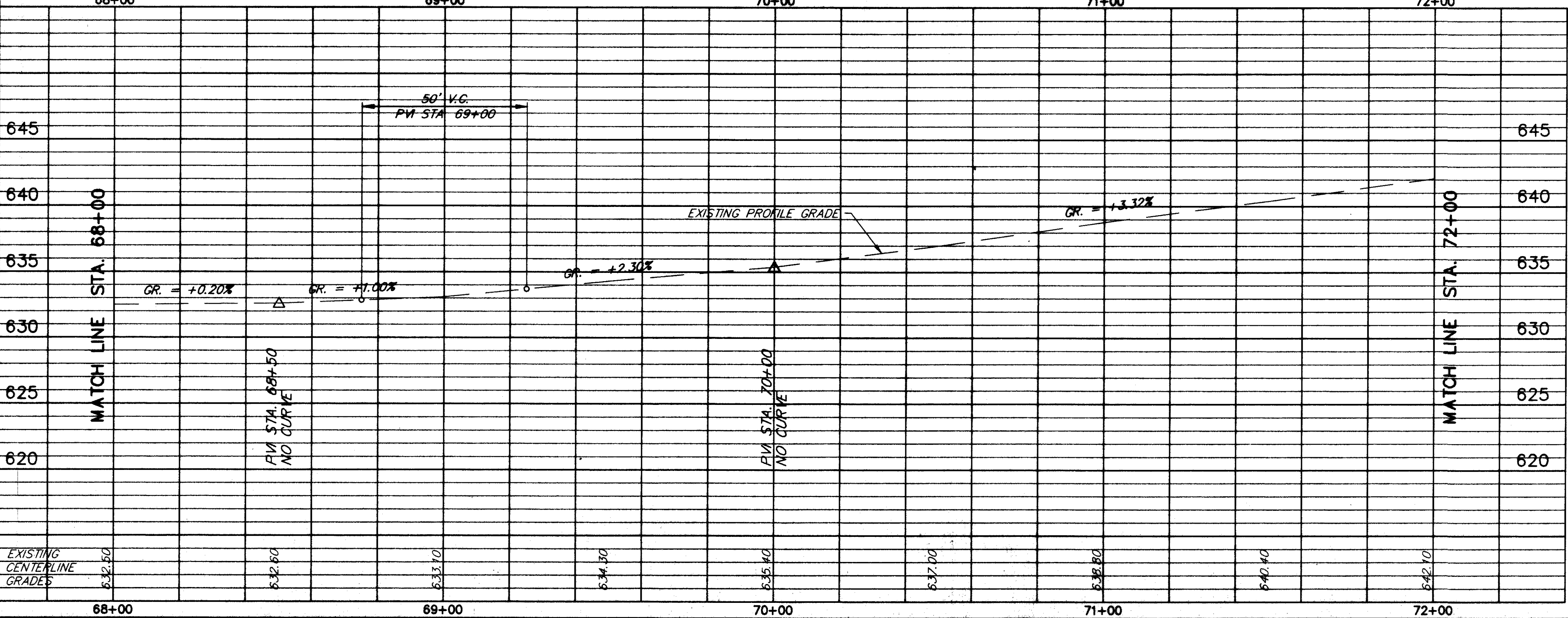

ROADWAY		202	606	606	606
REF	LOCATION	GUARDRAIL REMOVED	GUARDRAIL TYPE 5, AS PER PLAN	ANCHOR ASSEMBLY, TYPE A, AS PER PLAN	ANCHOR ASSEMBLY, TYPE T, AS PER PLAN
R-1	STA. 69+90 TO STA. 72+00, LT.		200	1	
R-2	STA. 69+93 TO STA. 72+00, LT.		207		
R-3	STA. 69+75 TO STA. 72+00, RT.		196.5	1	
R-4	STA. 69+73 TO STA. 72+00, RT.		227		
TOTALS		434	396.5	1	1

H:\CT\92535\CAD\HOPKINS\HOPPI.BDWG 1"=20'

MUNSON ROAD PLAN & PROFILE STA. 68+00 TO STA. 72+00