

MUNSON ROAD

BENCH MARK #9
 HOLE REF. ON TRAFFIC MH
 SW COR. TYLER/HOPKINS
 STA. 64+97± LT.
 ELEV. 634.44

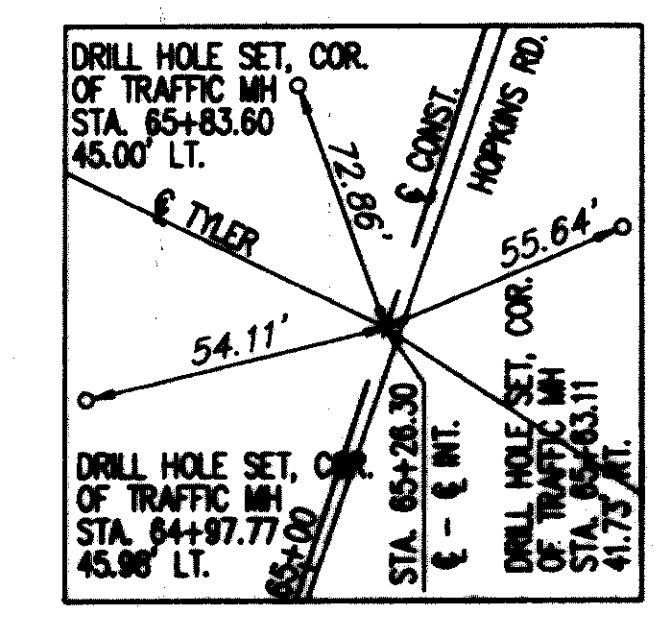

REF	LOCATION	QTY	UNIT	TOTAL
830	CURB, TYPE 6, AS PER PLAN		LN.FT.	
448	1-1/4" ASPH. CONC. SURFACE COURSE, TYPE 1, P684-22		SQ.YD.	
408	BITUMINOUS PRIME COAT (0.40 GAL./SQ.YD.)		SQ.YD.	
407	TACK COAT (0.10 GAL./SQ.YD.)		SQ.YD.	
304	6" AGGREGATE BASE, AS PER PLAN		SQ.YD.	
301	6" BITUMINOUS AGGREGATE BASE, P684-22		SQ.YD.	
301	8 3/4" BITUMINOUS AGGREGATE BASE, P684-22		SQ.YD.	
203	SUBGRADE COMPACTION		SQ.YD.	
203	EXCAVATION NOT INCLUDING EMBANKMENT CONSTRUCTION		CU.YD.	
TOTALS				

SWTIE #12

FOR TYPICAL SECTIONS SEE SHEETS 9 THRU 12
 FOR CROSS-SECTIONS SEE SHEETS 100 THRU 140
 FOR DRIVEWAY SCHEDULE & DETAILS SEE SHEET 23
 FOR PAVEMENT DETAILS SEE SHEET 171
 FOR TRAFFIC CONTROL DETAILS SEE SHEETS 172 THRU 198

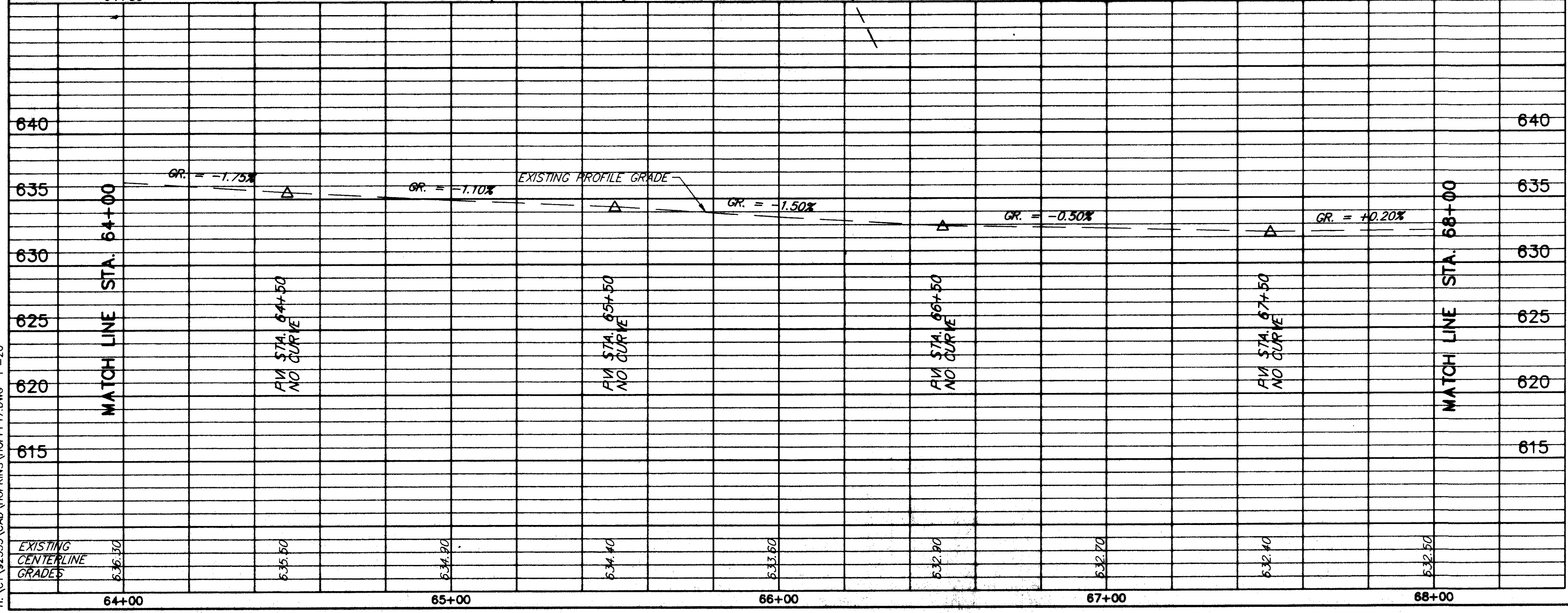
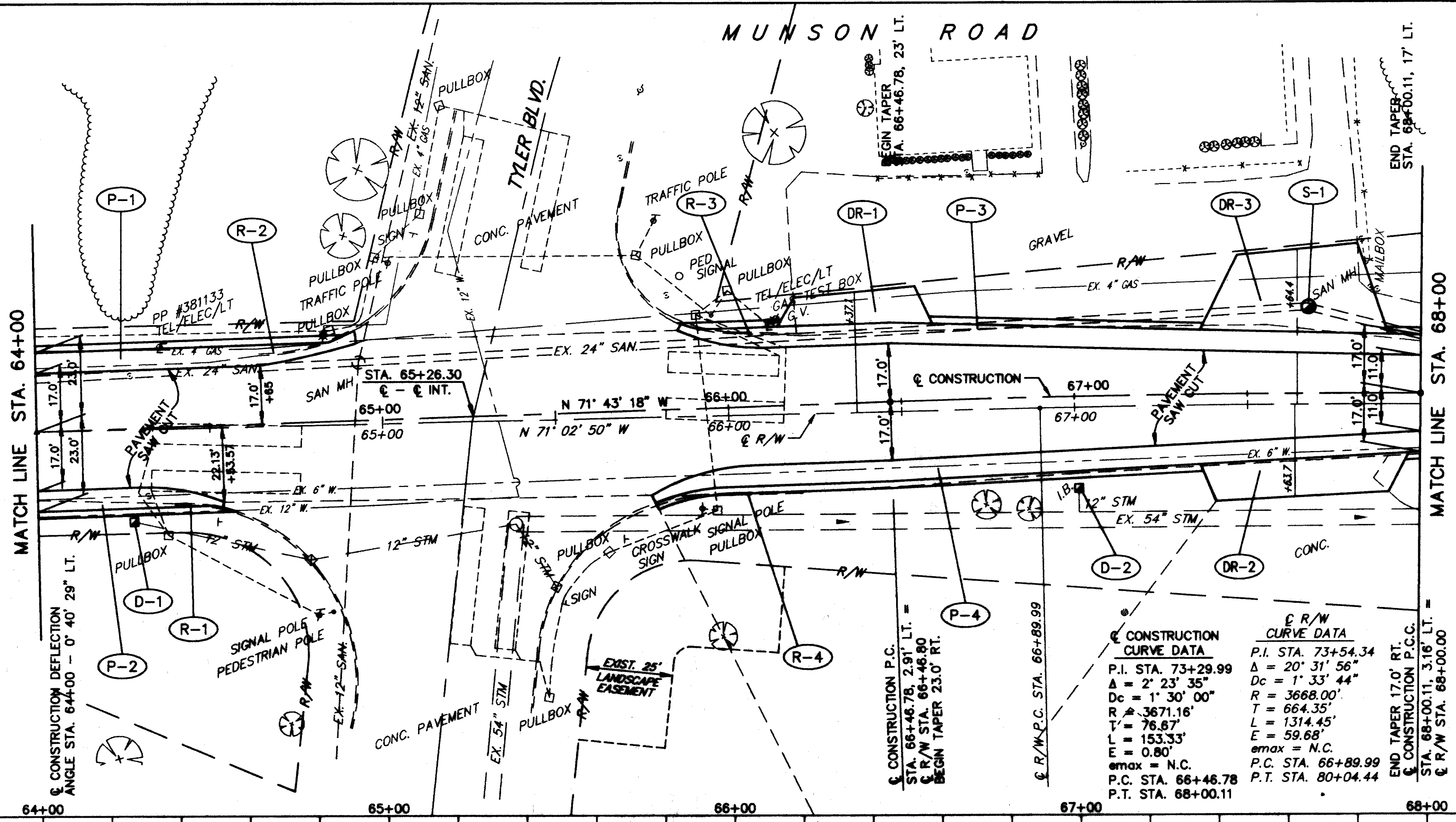

REF	LOCATION	LN.FT.	CURB REMOVED
R-1	STA. 64+39 TO STA. 64+57, RT.	18	
R-2	STA. 64+65 TO STA. 64+90, LT.	25	
R-3	STA. 65+86 TO STA. 66+15, LT.	29	
R-4	STA. 65+79 TO STA. 66+22, RT.	43	
TOTALS			115

REF	LOCATION	EACH	EACH	
D-1	STA. 64+27, RT.	1		
D-2	STA. 67+00, RT.	1		
TOTALS				2

MUNSON ROAD PLAN & PROFILE STA. 64+00 TO 68+00