

CALC. BY: WDB
DATE: 7-99
CHKD. BY: CCH
DATE: 8/99

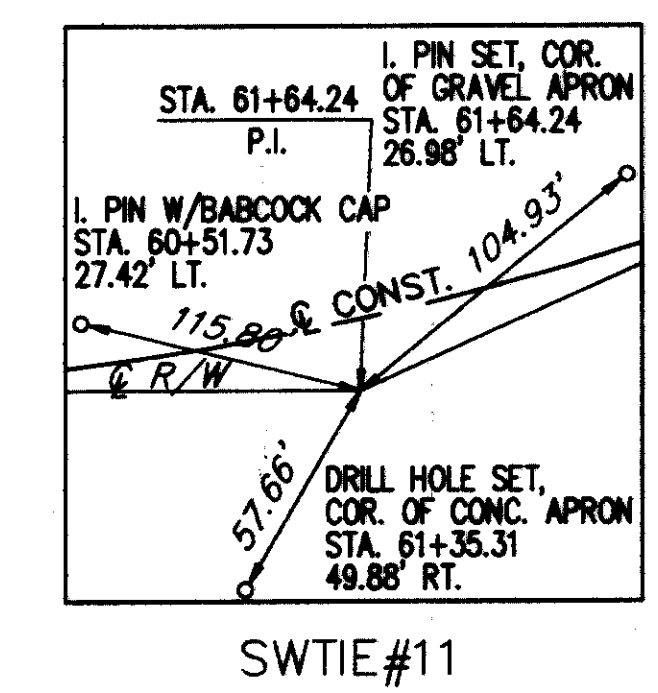

ITEM NO.	DESCRIPTION	CU. YD.	SO. YD.	CU. YD.	SO. YD.	TOTAL
830	CURB, TYPE 6, AS PER PLAN					
448	1-1/4" ASPH. CONC. SURFACE COURSE, TYPE 1, PG84-22	12.8				12.8
408	BITUMINOUS PRIME COAT (0.40 GAL./SQ.YD.)	148.0				148.0
407	TACK COAT (0.10 GAL./SQ.YD.)	36.5				36.5
304	6" AGGREGATE BASE, AS PER PLAN	62.1				62.1
301	6" BITUMINOUS AGGREGATE BASE, PG84-22	10.8				10.8
301	8 3/4" BITUMINOUS AGGREGATE BASE, PG84-22	91.3				91.3
203	SUBGRADE COMPACTION	287				287
203	EXCAVATION NOT INCLUDING EMBANKMENT CONSTRUCTION	130.9				130.9
TOTALS		632.4				632.4

FOR TYPICAL SECTIONS SEE SHEETS 9 THRU 12
FOR CROSS-SECTIONS SEE SHEETS 100 THRU 140
FOR DRIVEWAY SCHEDULE & DETAILS SEE SHEET 23
FOR PAVEMENT DETAILS SEE SHEET 171
FOR TRAFFIC CONTROL DETAILS SEE SHEETS 172 THRU 198

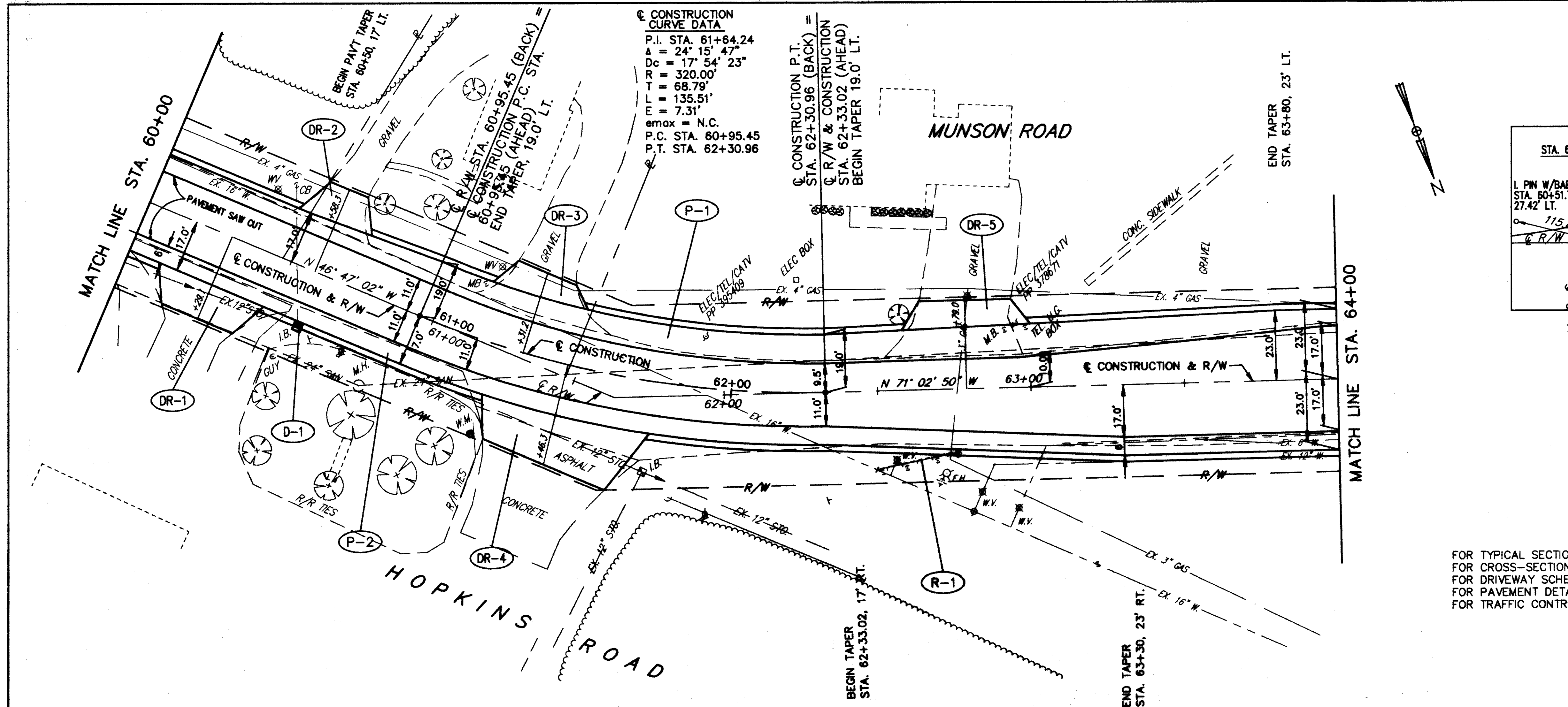
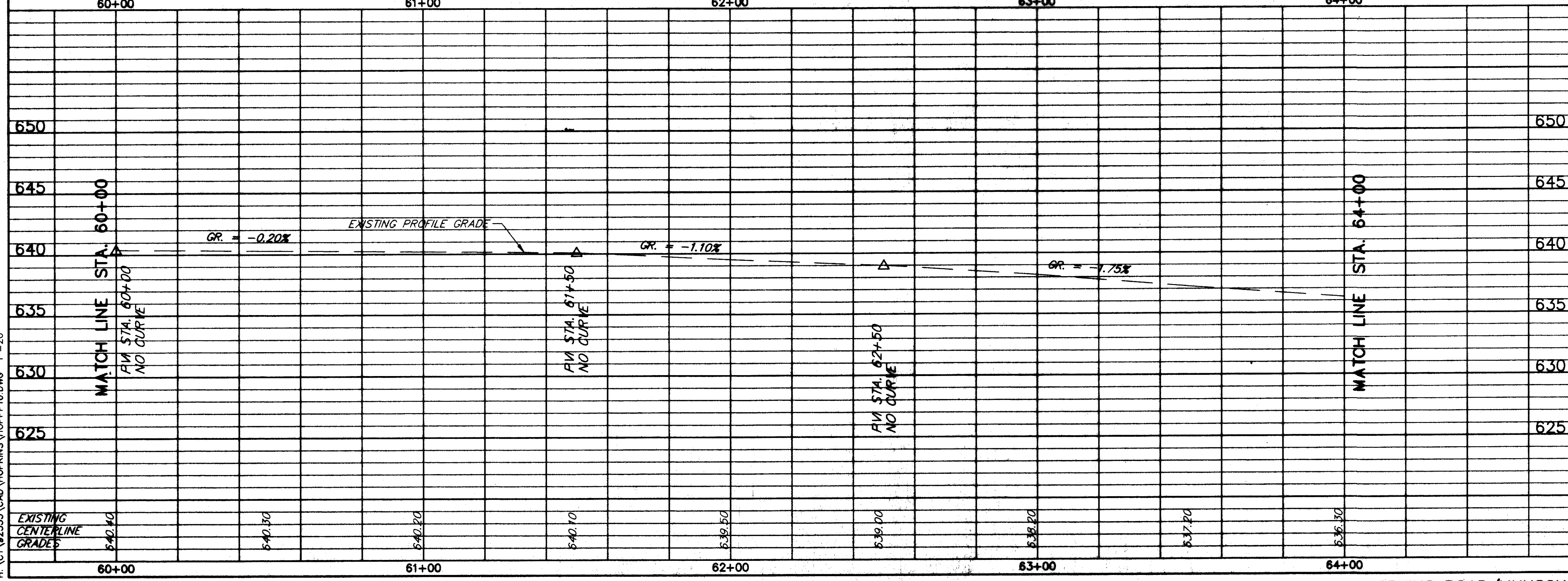

ROADWAY			GUARDRAIL REMOVED
REF	LOCATION	LIN. FT.	
R-1	STA. 62+45 TO STA. 62+75, RT.	30	
TOTALS		30	

DRAINAGE & SANITARY			INLET ADJUSTED TO GRADE, AS PER PLAN
REF	LOCATION	EACH	
D-1	STA. 60+61, 19' RT.	1	
TOTALS		1	

H:\CT\92335\CAD\HOPKINS\HOPPP16.DWG 1"=20'

HOPKINS ROAD/MUNSON ROAD PLAN & PROFILE STA. 60+00 TO STA. 64+00