

| ITEM NO.      | DESCRIPTION                                      | UNIT    | QUANTITY | UNIT PRICE | TOTAL          |
|---------------|--|---------|----------|------------|----------------|
| 830           | CURB, TYPE 6, AS PER PLAN                        | LI. FT. |          |            |                |
| 448           | 1-1/4\"/>  |         |          |            |                |
| 408           | BITUMINOUS PRIME COAT (0.40 GAL./SQ.YD.)         | GAL.    | 124.8    | 10.9       | 1368.72        |
| 407           | TACK COAT (0.10 GAL./SQ.YD.)                     | GAL.    | 31.2     | 10.9       | 340.08         |
| 304           | 6\"/>  |         |          |            |                |
| 301           | 6\"/>  |         |          |            |                |
| 301           | 8 3/4\"/>  |         |          |            |                |
| 203           | SUBGRADE COMPACTION                              | SQ. YD. | 154.5    | 1.56       | 241.02         |
| 203           | EXCAVATION NOT INCLUDING EMBANKMENT CONSTRUCTION | CU. YD. | 300.2    | 0.64       | 192.13         |
| <b>TOTALS</b> |  |         |          |            | <b>2410.95</b> |

FOR TYPICAL SECTIONS SEE SHEETS 9 THRU 12  
 FOR CROSS-SECTIONS SEE SHEETS 100 THRU 140  
 FOR DRIVEWAY SCHEDULE & DETAILS SEE SHEET 23  
 FOR PAVEMENT DETAILS SEE SHEET 171  
 FOR TRAFFIC CONTROL DETAILS SEE SHEETS 172 THRU 198

| REF           | LOCATION                             | PAVEMENT | TOTALS         |
|---------------|--------------------------------------|----------|----------------|
| P-1           | STA. 24+00 TO 24+50, LT. = 2000 S.F. |          |                |
| P-2           | STA. 24+00 TO 28+00, RT. = 2000 S.F. |          |                |
| <b>TOTALS</b> |                                      |          | <b>2410.95</b> |

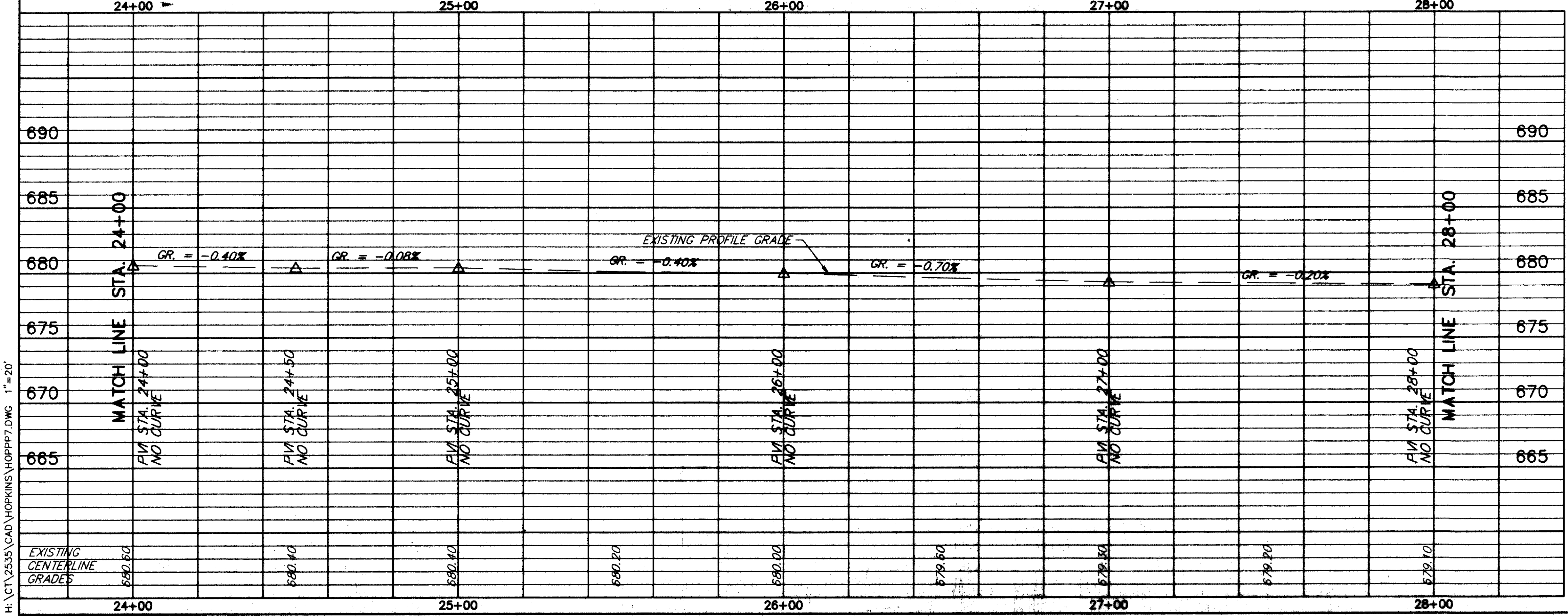

| DRAINAGE & SANITARY |                   |      | 604                                   |
|---------------------|-------------------|------|---------------------------------------|
| REF                 | LOCATION          | EACH | MANHOLE ADJUSTED TO GRADE AS PER PLAN |
| S-1                 | STA. 25+43, 14'L. | 1    |                                       |
| <b>TOTALS</b>       |                   |      | <b>1</b>                              |

HOPKINS ROAD PLAN & PROFILE STA. 24+00 TO STA. 28+00

H:\CTV\2535\CAD\HOPKINS\HOPP7.DWG 1"=20'