

BENCH MARK #1
 BOTTOM STEP (SW COR)
 HOUSE #7115
 STA. 5+05± RT.
 ELEV. 696.05

BM1

| ITEM | DESCRIPTION | UNIT | AMOUNT | PRICE | TOTAL |
|---------------|--|-------|--------|-------|-------|
| 830 | CURB, TYPE 6, AS PER PLAN | CU YD | 19.7 | 19.7 | 19.7 |
| 448 | 1-1/4" ASPH. CONC. SURFACE COURSE, TYPE 1, PG84-22 | CU YD | 4.1 | 4.1 | 4.1 |
| 408 | BITUMINOUS PRIME COAT (0.40 GAL./SQ.YD.) | GAL | 16.4 | 16.4 | 16.4 |
| 407 | TACK COAT (0.10 GAL./SQ.YD.) | GAL | 16.4 | 16.4 | 16.4 |
| 304 | 6" AGGREGATE BASE, AS PER PLAN | CU YD | 19.7 | 19.7 | 19.7 |
| 301 | 6" BITUMINOUS AGGREGATE BASE, PG84-22 | CU YD | 4.1 | 4.1 | 4.1 |
| 301 | 8 3/4" BITUMINOUS AGGREGATE BASE, PG84-22 | CU YD | 19.7 | 19.7 | 19.7 |
| 203 | SUBGRADE COMPACTION | CU YD | 19.7 | 19.7 | 19.7 |
| 203 | EXCAVATION NOT INCLUDING EMBANKMENT CONSTRUCTION | CU YD | 19.7 | 19.7 | 19.7 |
| TOTALS | | | | | |

FOR TYPICAL SECTIONS SEE SHEETS 9 THRU 12
 FOR CROSS-SECTIONS SEE SHEETS 100 THRU 140
 FOR DRIVEWAY SCHEDULE & DETAILS SEE SHEET 23
 FOR PAVEMENT DETAILS SEE SHEET 171
 FOR TRAFFIC CONTROL DETAILS SEE SHEETS 172 THRU 198

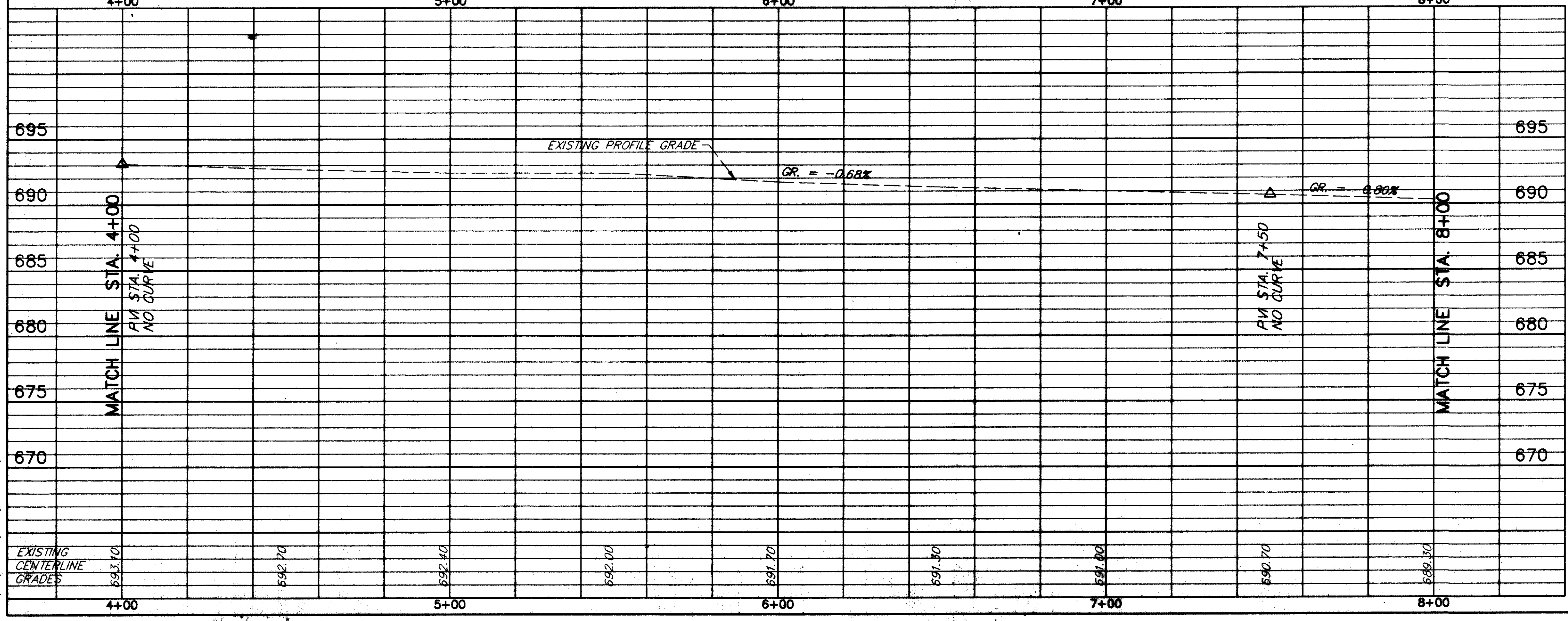
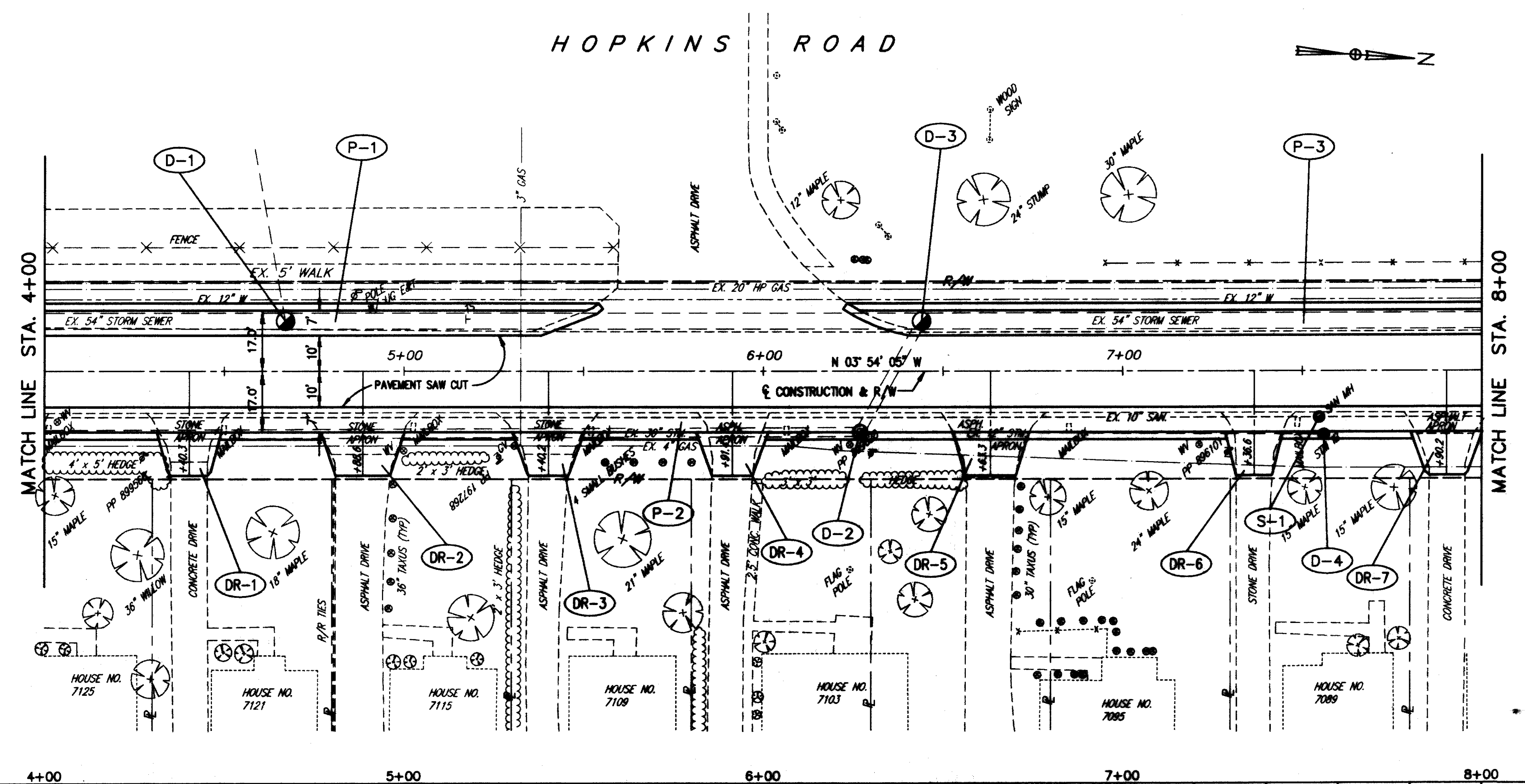

| DRAINAGE & SANITARY | | INLET ADJUSTED TO GRADE AS PER PLAN | | MANHOLE MANHOLE TO GRADE AS PER PLAN | |
|---------------------|--------------------|-------------------------------------|----------|--------------------------------------|----------|
| REF | LOCATION | EACH | EACH | EACH | EACH |
| D-1 | STA. 4+67, 14'L.T. | | 1 | | |
| D-2 | STA. 6+27, 17'R.T. | | 1 | | |
| D-3 | STA. 6+45, 14'L.T. | | 1 | | |
| D-4 | STA. 7+55, 18'R.T. | 1 | | | |
| S-1 | STA. 7+54, 13'R.T. | | | 1 | |
| TOTALS | | 1 | 4 | 1 | 0 |

HOPKINS ROAD PLAN & PROFILE STA. 4+00 TO STA. 8+00

H:\CT\92535\CAD\HOPKINS\HOPPP2.DWG 1"=20'