

CALC. BY: KCB  
DATE: 7-99  
CHKD. BY: CWT  
DATE: 8-99

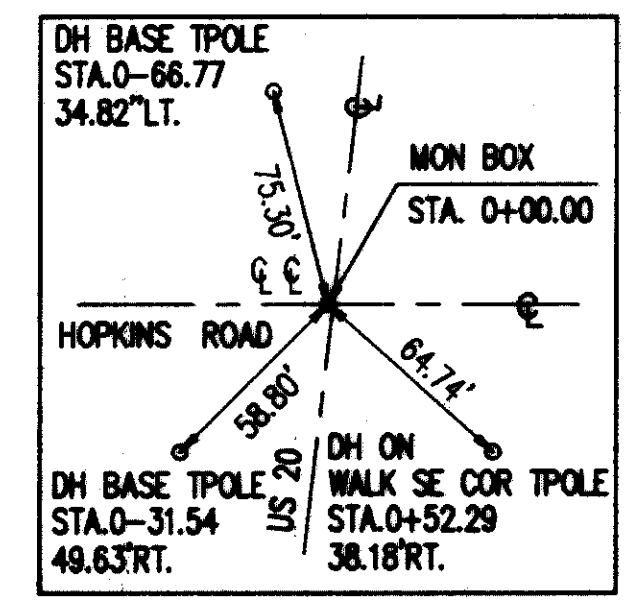
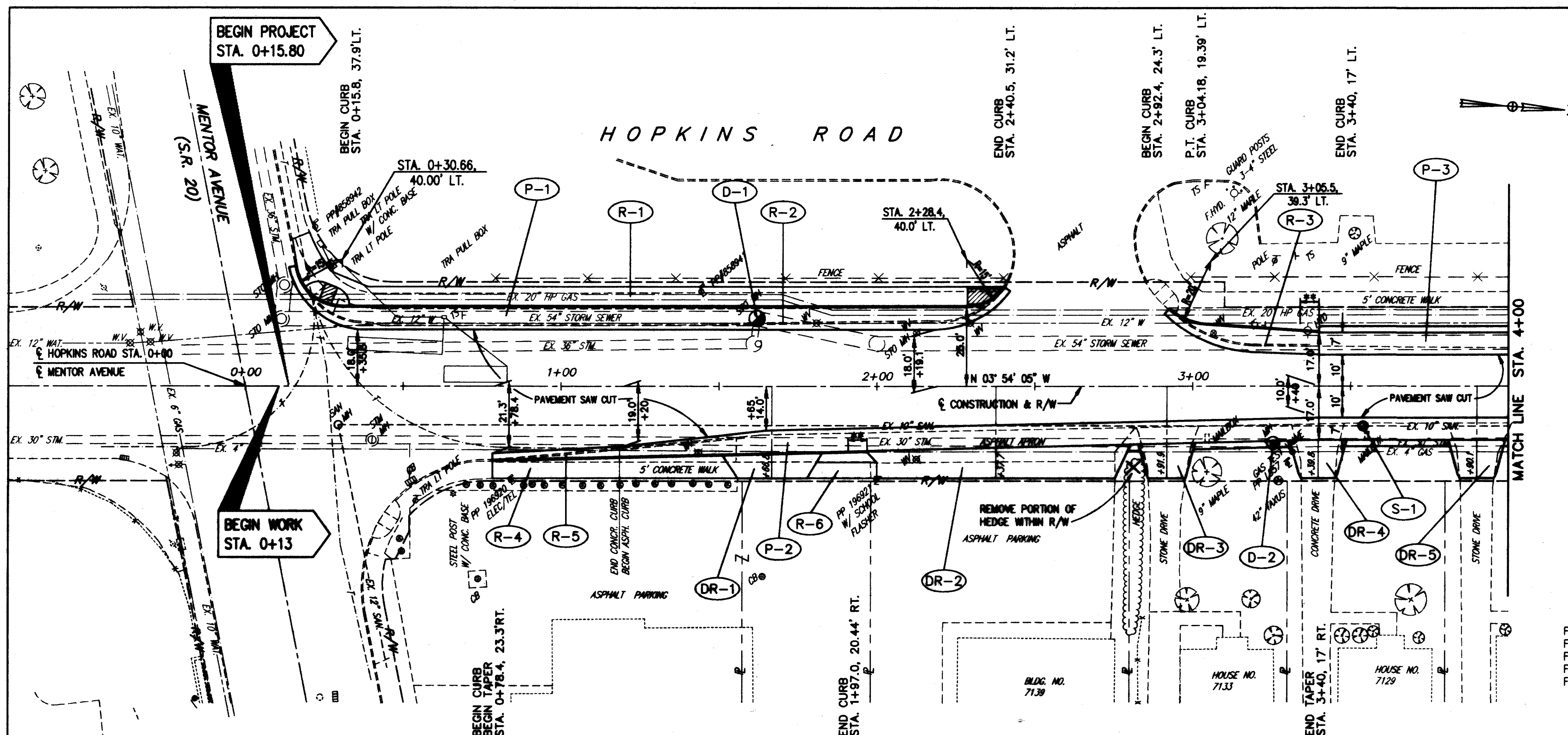

NOTE:  
\*\* TRANSITION CURB HEIGHT FROM  
7-1/4" TO 1-1/4" IN 6'-0"

FOR TYPICAL SECTIONS SEE SHEETS 9 THRU 12  
FOR CROSS-SECTIONS SEE SHEETS 100 THRU 140  
FOR DRIVEWAY SCHEDULE & DETAILS SEE SHEET 23  
FOR PAVEMENT DETAILS SEE SHEET 171  
FOR TRAFFIC CONTROL DETAILS SEE SHEETS 172 THRU 198

| ITEM NO.      | DESCRIPTION  | UNIT       | QUANTITY | UNIT PRICE | TOTAL          |
|---------------|--|------------|----------|------------|----------------|
| 830           | CURB, TYPE 6, AS PER PLAN                          | LINEAL FT. | 208      | 18.3       | 3806.4         |
| 448           | 1-1/4" ASPH. CONC. SURFACE COURSE, TYPE 1, PG84-22 | SQ. YD.    | 278      | 2.8        | 781.6          |
| 408           | BITUMINOUS PRIME COAT (@ 0.40 GAL./SQ.YD.)         | GAL.       | 1104     | 0.28       | 309.12         |
| 407           | TACK COAT (@ 0.10 GAL./SQ.YD.)                     | GAL.       | 1104     | 0.08       | 88.32          |
| 304           | 6" AGGREGATE BASE, AS PER PLAN                     | CY         | 27.8     | 15.3       | 425.34         |
| 301           | 6" BITUMINOUS AGGREGATE BASE, PG84-22              | CY         | 1.4      | 2.3        | 3.22           |
| 301           | 8 3/4" BITUMINOUS AGGREGATE BASE, PG84-22          | CY         | 19.4     | 2.3        | 44.62          |
| 203           | SUBGRADE COMPACTION                                | SQ. YD.    | 108      | 0.00       | 0.00           |
| 203           | EXCAVATION NOT INCLUDING EMBANKMENT CONSTRUCTION   | SQ. YD.    | 391      | 0.00       | 0.00           |
| <b>TOTALS</b> |  |            |          |            | <b>4699.70</b> |

| REF | LOCATION                          | PAVEMENT | TOTALS |
|-----|-----------------------------------|----------|--------|
| P-1 | STA. 0+14 TO 2+42, LT. = 1480 SF. |          |        |
| P-2 | STA. 0+88 TO 4+00, RT. = 2008 SF. |          |        |
| P-3 | STA. 2+80 TO 4+00, LT. = 720 SF.  |          |        |

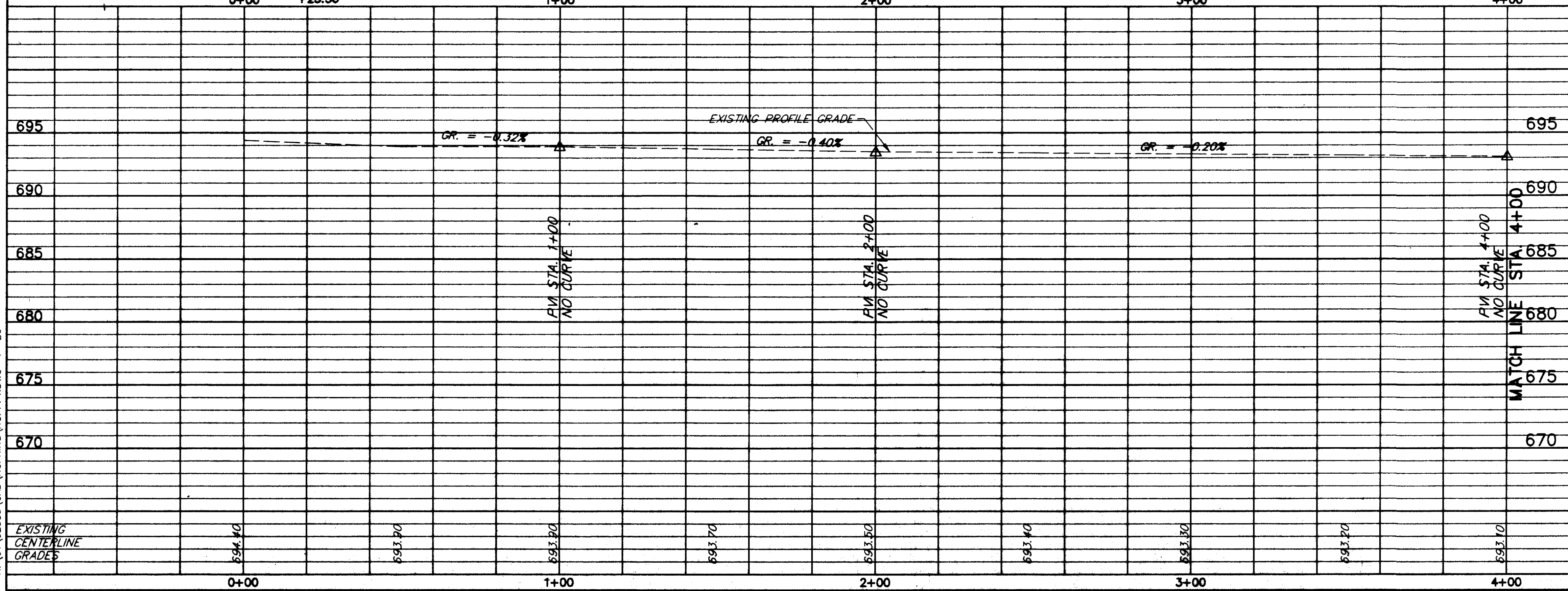

| ROADWAY       |                                |             |            |             |            |
|---------------|--------------------------------|-------------|------------|-------------|------------|
| REF           | LOCATION                       | SQ. FT.     | LN. FT.    | SQ. FT.     | EACH       |
| R-1           | STA. 0+16 TO STA. 2+40 LT.     | 1181        | 1445       | 1           | 1          |
| R-2           | STA. 0+16 TO STA. 2+40 LT.     | 240         | 48         |             |            |
| R-3           | STA. 2+92.4 TO STA. 3+38 LT.   | 608         | 476        |             |            |
| R-4           | STA. 0+88.4 TO STA. 1+55 RT.   | 95          | 115        |             |            |
| R-5           | STA. 0+88.4 TO STA. 1+18 RT.   |             |            |             |            |
| R-6           | STA. 0+78.8 TO STA. 2+00.3 RT. |             |            |             |            |
| <b>TOTALS</b> |                                | <b>1884</b> | <b>329</b> | <b>2036</b> | <b>1 1</b> |

| DRAINAGE & SANITARY |                    |          |                                       |              |              |
|---------------------|--------------------|----------|---------------------------------------|--------------|--------------|
| REF                 | LOCATION           | EACH     | MANHOLE ADJUSTED TO GRADE AS PER PLAN | WALK REMOVED | CURB REMOVED |
| D-1                 | STA. 1+62, 22' LT. | 1        |                                       |              |              |
| D-2                 | STA. 3+25, 17' RT. | 1        |                                       |              |              |
| S-1                 | STA. 3+53, 13' RT. | 1        |                                       |              |              |
| <b>TOTALS</b>       |                    | <b>3</b> |                                       |              |              |

HOPKINS ROAD PLAN & PROFILE STA. 0+00 TO STA. 4+00