

CALC. BY: WDB
DATE: 7-99
CHKD BY: CCH
DATE: 8-99

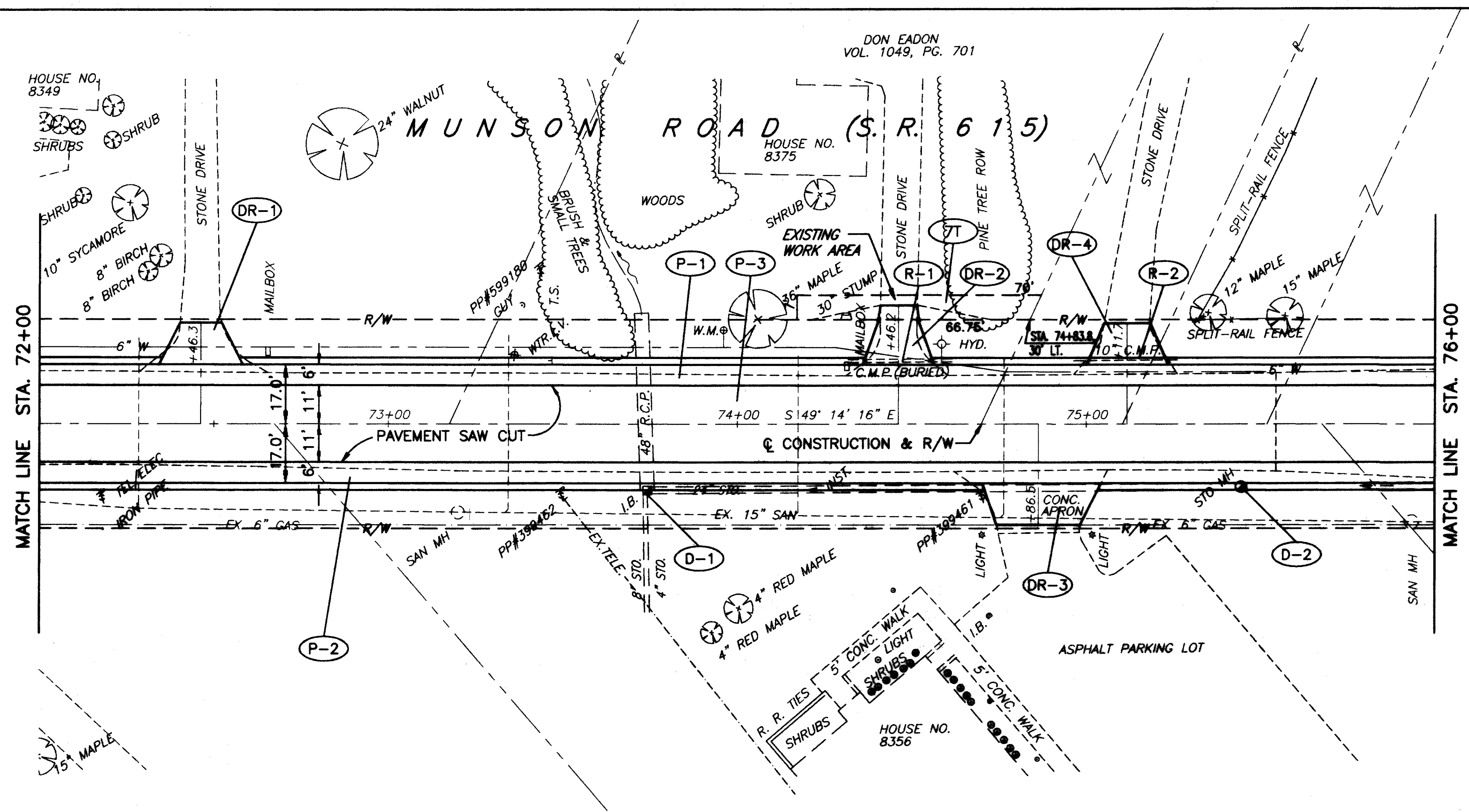
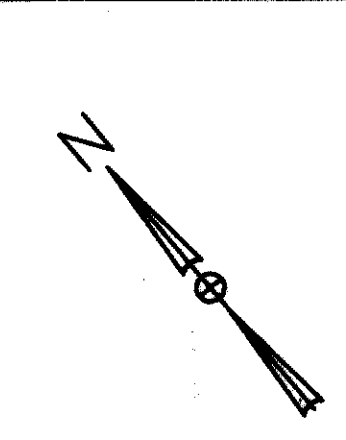

BENCH MARK #10
TOP I.P. SET W/CAP
STA. 72+18.14, 30.11' RT.
ELEV. 621.02

BM10

FOR TYPICAL SECTIONS SEE SHEETS 5 THRU 6
FOR CROSS-SECTIONS SEE SHEETS 48 THRU 79
FOR DRIVEWAY SCHEDULE & DETAILS SEE SHEETS 21 THRU 22
FOR PAVEMENT DETAILS SEE SHEET 171
FOR TRAFFIC CONTROL DETAILS SEE SHEETS 172 THRU 198

RESURFACING PROGRAM	STA.	DESCRIPTION	CU.YD.	CU.YD.	CU.YD.	CU.YD.	CU.YD.	CU.YD.	CU.YD.
1-1/4" ASPH. CONC. SURFACE COURSE, TYPE 1, PG84-25	448								34.0
1/2" AVG. ASPH. CONC. INTERMEDIATE COURSE, TYPE 2, PG84-22	448								13.6
TACK COAT (0.10 GAL./SQ.YD.)	407								34.0
PAVEMENT PLANING, BITUMINOUS	254								97.8
1-1/4" ASPH. CONC. SURFACE COURSE, TYPE 1, PG84-22	448								18.6
BITUMINOUS PRIME COAT (0.40 GAL./SQ.YD.)	408								9.3
TACK COAT (0.10 GAL./SQ.YD.)	407								9.3
6" AGGREGATE BASE, AS PER PLAN	304								53.4
6" BITUMINOUS AGGREGATE BASE, PG84-22	301								25.9
8 3/4" BITUMINOUS AGGREGATE BASE, PG84-22	301								25.9
SUBGRADE COMPACTION	203								129.6
EXCAVATION NOT INCLUDING EMBANKMENT CONSTRUCTION	203								53.4
TOTALS									978.8

PAVEMENT	LOCATION	TOTALS
P-1	STA. 72+00 TO 76+00, LT. = 2400 S.F.	
P-2	STA. 72+00 TO 76+00, RT. = 2400 S.F.	
P-3	STA. 72+00 TO 76+00, RT. = 8880 S.F.	

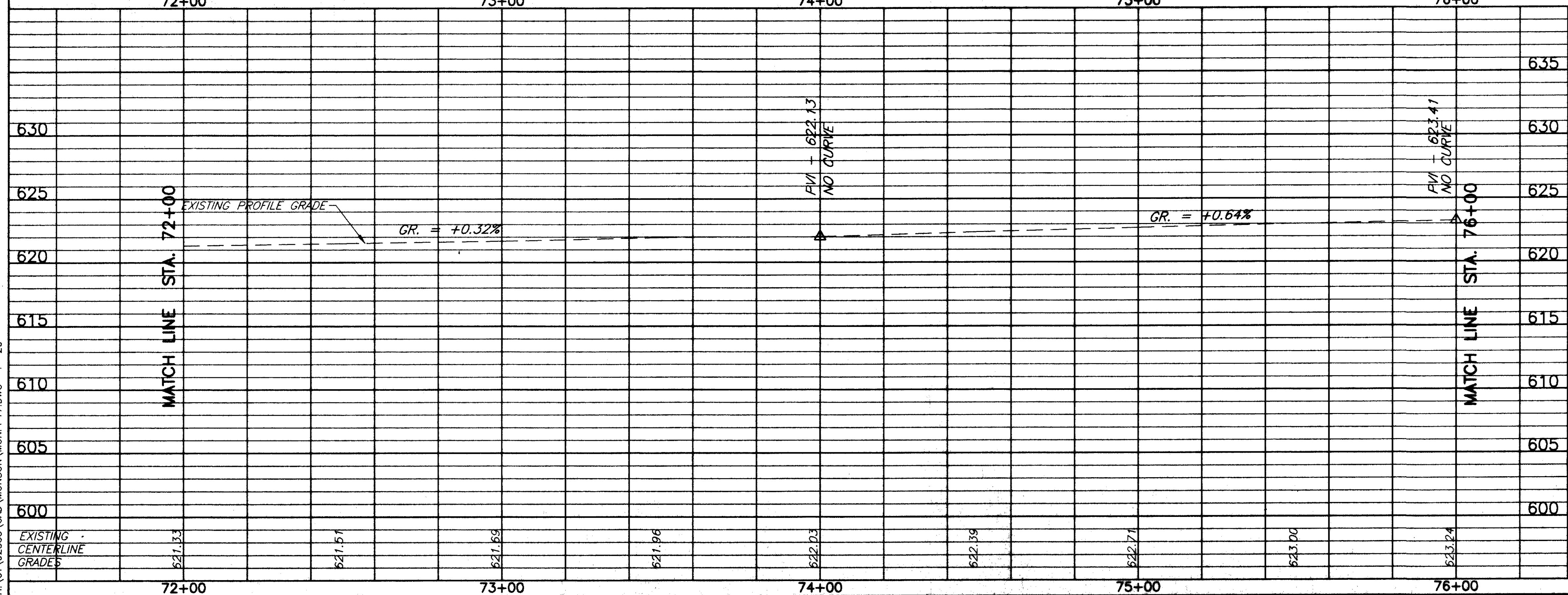

ROADWAY		
REF	LOCATION	LIN.FT.
R-1	STA. 74+35 LT. TO STA. 74+61 LT.	26
R-2	STA. 74+98 LT. TO STA. 75+28 LT.	30
TOTALS		56

DRAINAGE & SANITARY			
REF	LOCATION	EACH	EACH
D-1	STA. 73+74, 19' RT.	1	
D-2	STA. 75+44, 18' RT.		1
TOTALS		1	1

MUNSON ROAD PLAN & PROFILE STA. 72+00 TO STA. 76+00

H:\CT\92535\CAD\MUNSON\MUNPP17.DWG 1"=20'